

09D (TR60SN)

ILL#	Part#		QTY	REF#
OVERHAUL KITS				
NI.....	K134900.....	Overhaul Kit, 09D (AWTR60-SN) VW- Toureg, Audi- Q7, Porsche- Cayenne, 2004-Up.....	1.....	N/A
		This Transmission Does Not Use Bonded Pistons		
MASTER L/STEEL KITS				
NI.....	DK13400S.....	Master L/Steels Kit, 09D (AWTR60-SN) VW- Toureg, Audi- Q7, Porsche- Cayenne, 2004-Up	1.....	N/A
		This Transmission Does Not Use Bonded Pistons		
MASTER W/STEELS KITS				
NI.....	DK13400	Master W/Steels Kit, 09D (AWTR60-SN) VW- Toureg, Audi- Q7, Porsche- Cayenne, 2004-Up	1.....	N/A
		This Transmission Does Not Use Bonded Pistons		
FILTERS				
NI.....	134710	Filter, 09G (AWTF60-SN) 2003-Up.....	1.....	TBA
METAL CLAD SEALS				
NI.....	134151	Seal, Pump, 09D (AWTR60-SN) 2004-Up.....	1.....	TBA
NI.....	134157	Seal, Extension Housing, 09D (AWTR60-SN) 2004-Up	2.....	TBA
NI.....	78197	Seal, Manual Shaft, 09D (AWTR60-SN) 2003-Up.....	1.....	TBA
FRICTIONS				
NI.....	134103	Friction, 09D (AWTR60-SN) K-1 Clutch, .080", 40T, 6.499" OD, Hi-Energy, 2004-Up	7.....	TBA
NI.....	134105	Friction, 09D (AWTR60-SN) K-2 Clutch, .079", 42T, 5.388" OD, Hi-Energy, 2004-Up	7.....	TBA
NI.....	134107	Friction, 09D (AWTR60-SN) K-3 Clutch, .079", 36T, 6.711" OD, Hi-Energy, 2004-Up	5.....	TBA
NI.....	134109	Friction, 09D (AWTR60-SN) B-1 Clutch, .080", 48T, 7.663" OD, Hi-Energy, 2004-Up	6.....	TBA
NI.....	134111	Friction, 09D (AWTR60-SN) B-2 Clutch, .065", 50T, 6.812" OD, Tan, 2004-Up	7.....	TBA
NI.....	134113A.....	Friction, 09D (AWTR60-SN) Transfer Case (Internal Spline), .065", 50T, 4.989" OD, 2004-Up.....	7.....	TBA
NI.....	134113B.....	Friction, 09D (AWTR60-SN) Transfer Case (External Spline), .065", 16T, 3.815" OD, 2004-Up.....	7.....	TBA
NI.....	K134F.....	Friction Module, 09D (AWTR60-SN) All Except Toureg 4.2L V-8, 2004-Up.....	1.....	RCP96-195
NI.....	K134AF	Friction Module, 09D (AWTR60-SN) Toureg 4.2L V-8, 2004-Up	1.....	RCP96-240
STEELS				
NI.....	134102	Steel, 09D (AWTR60-SN) K-1 Clutch, .078", 36T, 5.888" ID, 2004-Up	7.....	TBA
NI.....	134104	Steel, 09D (AWTR60-SN) K-2 Clutch, .078", 36T, 4.496" ID, 2004-Up	7.....	TBA
NI.....	134106	Steel, 09D (AWTR60-SN) K-3 Clutch, .078", 36T, 5.745" ID, 2004-Up	7.....	TBA
NI.....	134108	Steel, 09D (AWTR60-SN) K-3 Clutch (Selective), .126", 36T, 5.745" ID, 2004-Up	AR.....	TBA
NI.....	134110	Steel, 09D (AWTR60-SN) B-1 Clutch, .079", 10T, 6.691" ID, 2004-Up	5.....	TBA
NI.....	134112	Steel, 09D (AWTR60-SN) B-2 Clutch, .071", 24T, 6.274" ID, 2004-Up	6.....	TBA
NI.....	K134S	Steel Module, 09D (AWTR60-SN) 2004-Up	1.....	TBA
ELECTRICAL COMPONENTS				
NI.....	133951	TCC Linear Solenoid (Black Connector)	1.....	52-0488
NI.....	133952	EPC Linear Solenoid (Green Connector)	1.....	52-0489
NI.....	133952	C1 Clutch Linear Shift Control (Green Connector).....	1.....	52-0489
NI.....	133952	C2 Clutch Linear Shift Control (Green Connector).....	1.....	52-0489
NI.....	133952	C3 Clutch Linear Shift Control Solenoid (Green Connector).....	1.....	52-0489
NI.....	133952	B1 Band Linear Shift Control Solenoid (Green Connector).....	1.....	52-0489
HARD PARTS				
NI.....	134754	Valve Body, 09D, W/ Pressure Switches, 2004-Up	1.....	TBA
NI.....	134754A.....	Valve Body, 09D, W/ No Pressure Switches, 2004-Up.....	1.....	TBA

09G (TF-60SN), 09K (TF-61SN), 09M (TF-62SN)

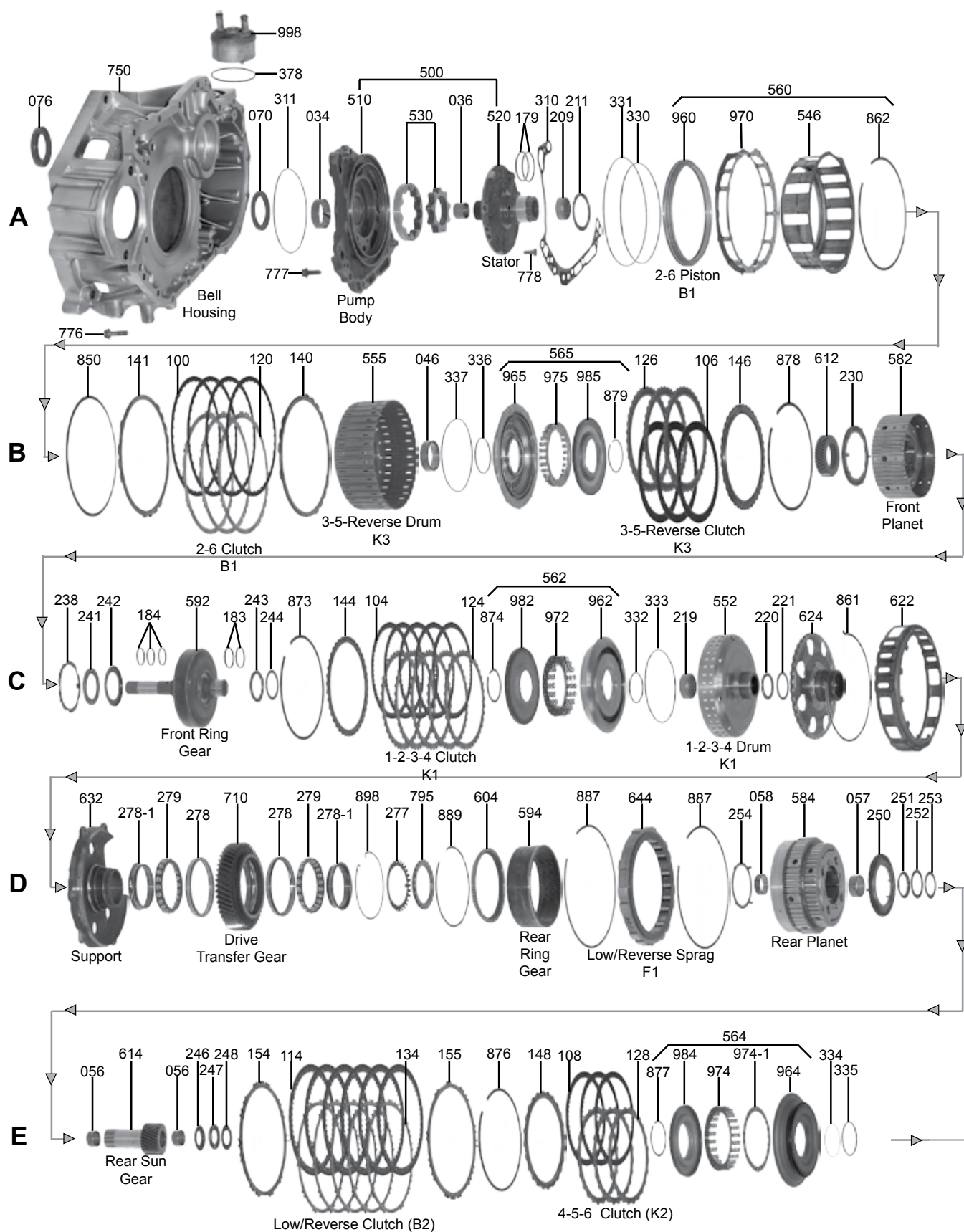

09G (TF-60SN), 09K (TF-61SN), 09M (TF-62SN)

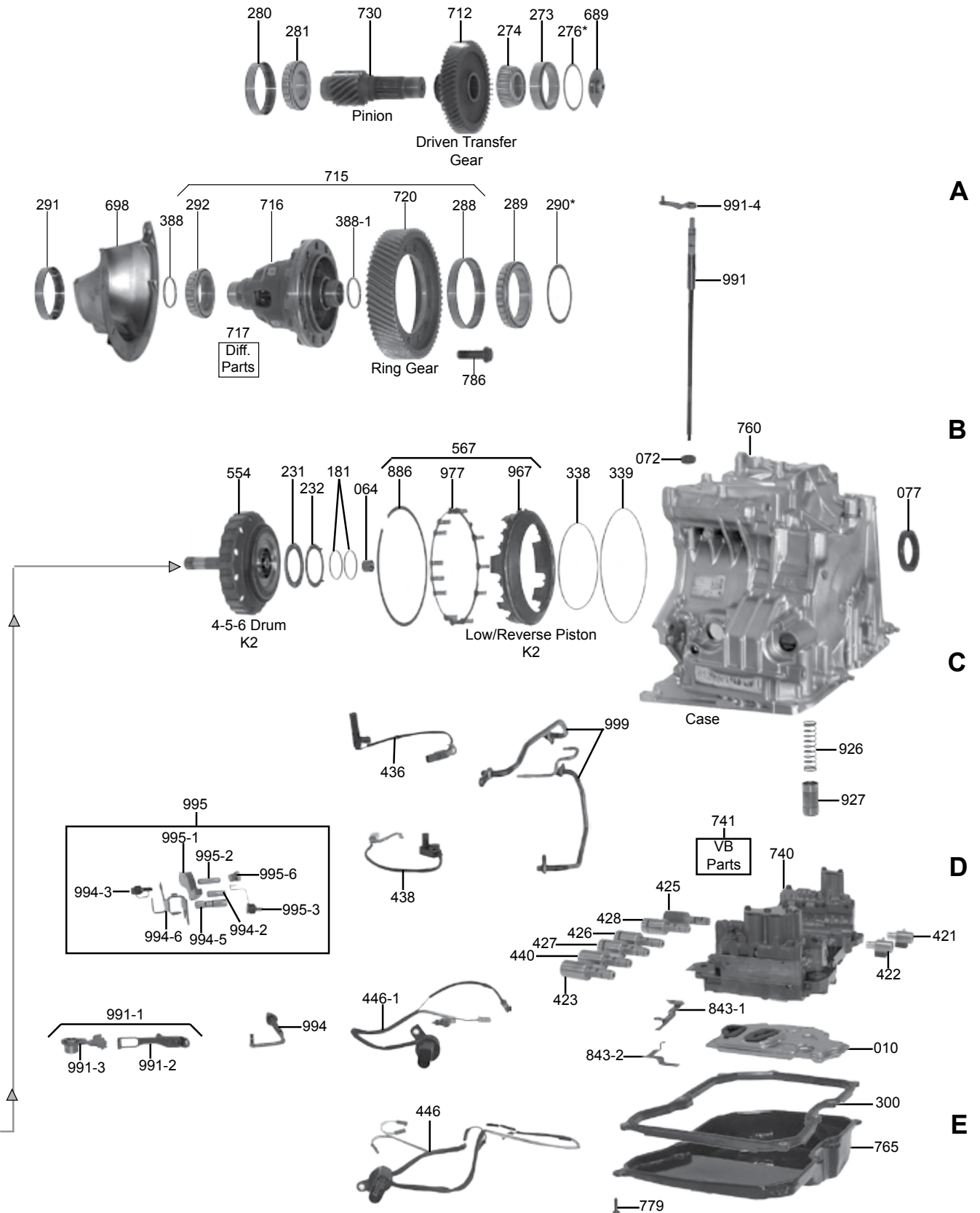

09G (TF-60SN), 09K (TF-61SN), 09M (TF-62SN)

ILL#	Part#		QTY	REF#
OVERHAUL KITS & PISTON KITS				
NI.....	K133900.....	Overhaul Kit, 09G/09K/09M (Combo) W/ Pistons, 2003-Up.....	1.....	N/A
NI.....	K133900X.....	Overhaul Kit, 09G/09K/09M (Combo) W/Out Pistons, 2003-Up.....	1.....	N/A
NI.....	K133900A.....	Overhaul Kit, 09G W/ Pistons, 2003-Up.....	1.....	N/A
NI.....	K133900AX.....	Overhaul Kit, 09G W/Out Pistons, 2003-Up.....	1.....	N/A
NI.....	K133900B.....	Overhaul Kit, 09K W/ Pistons, 2004-Up.....	1.....	N/A
NI.....	K133900BX.....	Overhaul Kit, 09K W/Out Pistons, 2004-Up.....	1.....	N/A
NI.....	K133900C.....	Overhaul Kit, 09M W/ Pistons, 2006-Up.....	1.....	N/A
NI.....	K133900CX.....	Overhaul Kit, 09M W/Out Pistons, 2006-Up.....	1.....	N/A
NI.....	K133900-99.....	Piston Kit, 09G/09K/09M 4 Pistons, 2003-Up.....	1.....	N/A
MASTER L/STEEL KITS				
NI.....	DK13300S.....	Master L/Steels Kit, 09G (W/ .066" K1 Frict) W/ Pistons, 2003-Up.....	1.....	N/A
NI.....	DK13300XS.....	Master L/Steels Kit, 09G (W/ .066" K1 Frict) W/Out Pistons, 2003-Up.....	1.....	N/A
NI.....	DK13300AS.....	Master L/Steels Kit, 09G (W/ .058" K1 Frict) W/ Pistons, 2005-Up.....	1.....	N/A
NI.....	DK13300BS.....	Master L/Steels Kit, 09K W/ Pistons, 2003-Up.....	1.....	N/A
NI.....	DK13300CS.....	Master L/Steels Kit, 09M W/ Pistons, 2006-Up.....	1.....	N/A
MASTER W/STEELS KITS				
NI.....	DK13300.....	Master W/Steels Kit, 09G (W/ .066" K1 Frict) W/ Pistons, 2003-Up.....	1.....	N/A
NI.....	DK13300X.....	Master W/Steels Kit, 09G (W/ .066" K1 Frict) W/Out Pistons, 2003-Up.....	1.....	N/A
NI.....	DK13300A.....	Master W/Steels Kit, 09G (W/ .058" K1 Frict) W/ Pistons, 2005-Up.....	1.....	N/A
NI.....	DK13300B.....	Master W/Steels Kit, 09K W/ Pistons, 2003-Up.....	1.....	N/A
NI.....	DK13300C.....	Master W/Steels Kit, 09M W/ Pistons, 2006-Up.....	1.....	N/A
FILTERS				
010.....	133710.....	Filter, 09G (AWTF60-SN) "Shallow" Pan Narrow, Flush, Intake, 2003-Up.....	1.....	09G-325-429
010.....	133710B.....	Filter, 09G (AWTF60-SN) "Deep" Pan Wide Raised Intake, 2003-Up.....	1.....	09G-325-429A
010.....	133710A.....	Filter, 09K (AWTF61-SN) 2004-Up.....	1.....	09K-325-429
010.....	133710C.....	Filter, 09M (AWTF62-SN) 2006-Up.....	1.....	PI# 79575V
010.....	133710D.....	Filter, 09G (AWTF60-SN) Mini Cooper, Shallow Pick-Up, 2005-Up.....	1.....	2434-7-566-358
010.....	133710E.....	Filter, 09G (AWTF60-SN) Mini Cooper, Deep Pick-Up, 2005-Up.....	1.....	2434-7-551-087
BUSHINGS				
NI.....	K133901.....	Bushing Kit, 2003-Up.....	1.....	TBA
034.....	133005.....	Bushing, Pump, 2003-Up.....	1.....	TBA
036.....	133002.....	Bushing, Stator, 2003-Up.....	1.....	TBA
046.....	133006.....	Bushing, K3 Drum, 2003-Up.....	1.....	TBA
056.....	133017.....	Bushing, Forward Sun Gear, 2003-Up.....	2.....	TBA
057.....	133015A.....	Bushing, Rear Planet, Rear, 2003-Up.....	1.....	TBA
058.....	133015.....	Bushing, Rear Planet, Front, 2003-Up.....	1.....	TBA
062.....	133000.....	Bushing, Case / K2 Drum, 2003-Up.....	1.....	TBA
062.....	133000X.....	Bushing, Case / K2 Drum, Oversized Repair, 2003-Up, Requires T90330 Tool (Omega).....	1.....	90448A
062.....	T90330.....	Reaming Tool For Oversized Case Bushings, Includes 3ea 133000X Bushings (Omega).....	1.....	90330
NI.....	59024.....	Bushing, Linear Solenoid Inductor Hsg (2ea Per Sol) See Tools At End Of Electrical.....	2.....	55526
METAL CLAD SEALS				
070.....	133151.....	Seal, Pump, 09G (AWTF60-SN) 2003-Up.....	1.....	09G-321-243
072.....	78197.....	Seal, Manual Shaft, 09G (AWTF60-SN) 2003-Up.....	1.....	TBA
076.....	59152.....	Seal, Axle (Both) 09G (AWTF60-SN) 2003-Up.....	2.....	TBA
076.....	133153A.....	Seal, Axle (Both) 09K (AWTF60-SN) 2003-Up.....	2.....	TBA
NI.....	133160.....	Seal, Case Halves, 09G (AWTF60-SN) 2003-Up.....	3.....	TBA
FRICTIONS				
100.....	133103.....	Friction, B1 (2-6) .066", 40T, 7.245" OD, Hi-Energy, 2003-Up.....	4.....	TBA
104.....	133107.....	Friction, K1 (1-2-3-4) .066", 56T, 5.790" OD, 2003-Up.....	5.....	TBA
104.....	133107A.....	Friction, K1 (1-2-3-4) .058", 56T, 5.790" OD, 2005-Up.....	5.....	TBA
106.....	133111.....	Friction, 09G/09K K3 (3-5/Rev) .066", 56T, 6.180" OD, 2003-Up.....	6.....	TBA
106.....	133111A.....	Friction, 09M K3 (3-5/Rev) .059", 56T, 6.180" OD, 2003-Up.....	6.....	TBA
108.....	133109.....	Friction, 09G K2 (4-5-6) .066", 55T, 5.725" OD, 2003-Up.....	3.....	512567
108.....	133109A.....	Friction, 09K K2 (4-5-6) .066", 60T, 5.722" OD, 2003-Up.....	6.....	512658
108.....	133109B.....	Friction, 09M K2 (4-5-6) .058", 60T, 5.722" OD, 2004-Up.....	4.....	512659
108.....	133109C.....	Friction, 09M K2 (4-5-6) .058", 60T, 4.969" OD, 2004-Up.....	6.....	R572754
114.....	133105.....	Friction, 09G B2 (Low/Reverse) .067", 56T, 6.716" OD, 2003-Up.....	6.....	TBA
114.....	133105A.....	Friction, 09M B2 (Low/Reverse) .060", 56T, 6.716" OD, 2003-Up.....	6.....	TBA
NI.....	K133F.....	Friction Module, 09G, 1.8L & 1.9L, 2003-Up.....	1.....	RCP96-201
NI.....	K133AF.....	Friction Module, 09G, 2.0L & 2.5L, 2003-Up.....	1.....	RCP96-219
NI.....	K133BF.....	Friction Module, 09M, 3.6L, 2004-Up.....	1.....	RCP96-244

09G (TF-60SN), 09K (TF-61SN), 09M (TF-62SN)

ILL#	Part#		QTY	REF#
NI	K133BAF	Friction Module, 09M, 3.6L (W/ 60T 5.725" OD K2 4-5-6 Fric) 2004-Up	1	FRMAISIN15
STEELS				
120	133102	Steel, B1 (2-6) .072", 12T, 6.611" ID, 2003-Up	3	TBA
124	133106	Steel, K1 (1-2-3-4) .070", 40T, 5.148" ID, 2003-Up	5	TBA
126	133110	Steel, K3 (3-5/Rev) .071", 40T, 5.149" ID, 2003-Up	3	TBA
128	133108	Steel, K2 (4-5-6) .071", 24T, 5.000" ID, 2003-Up	3	TBA
134	133104	Steel, B2 (Low/Reverse) .072", 14T, 6.220" ID, 2003-Up	5	TBA
NI	K133S	Steel Module, 09G (AWTF60-SN) 2003-Up	1	TBA
PRESSURE PLATES				
140	133131	Pressure Plate, B1 (2-6) .091", 12T, 6.611" ID, 2003-Up	1	TBA
141	133132	Apply Plate, 09G 2-6 Clutch (B1) (.091") (12 Teeth) (6 1/2" ID) 2003-Up	1	TBA
144	133133	Pressure Plate, 09G 1-2-3-4 Clutch (K1) Selective (40 Teeth) (5.144" ID) 2003-Up	1	TBA
146	133134	Pressure Plate, 09G 3-5 Reverse Clutch (K3) Selective (40 Teeth) (5.153" ID) 2003-Up	1	TBA
148	133135	Pressure Plate, 09G 4-5-6 Clutch (K2) (.114") (24 Teeth) (4.995" ID) 2003-Up	1	TBA
154	133136	Pressure Plate, 09G Low/Reverse Clutch (B2) Selective (14 Teeth) (6 1/8" ID) 2003-Up	1	TBA
155	133137	Apply Plate, 09G Low/Reverse Clutch (B2) (.118") (14 Teeth) (6 1/8" ID) 2003-Up	1	TBA
VALVE BODY KITS				
165	K133908	Valve Body Kit, 2003-Up (Transgo)	1	SK-09G
SEALING RINGS				
175	K133903	Ring Kit, 2003-Up	1	TBA
WASHERS & BEARINGS				
209	133401	Caged Needle Bearing, 09G Stator (Rear) (.480" Wide) (1.225" OD) (34 Needles) 2003-Up	1	TBA
211	133402	Washer, 09G Stator To 3-5 Reverse (K3) Drum (.047" Thick) (2.280" OD) (1 Tab, Plastic) 2003-Up	1	TBA
219	133403	Caged Needle Bearing, 09G 1-2-3-4 Clutch (K1) Drum (Inner) (1.233" OD) (34 Needles) 2003-Up	1	TBA
220	133404	Bearing W/Race, 09G 1-2-3-4 Clutch (K1) To Rear Planet (.110" Thick) (1.644" OD) (1.176" ID) 2003-Up	1	TBA
221	133405	Race, 09G 1-2-3-4 Clutch (K1) Drum To Rear Planet (.059" Thick) (1.707" OD) (1.288" ID) 2003-Up	1	TBA
230	133406	Washer, 09G 3-5 Rev/(K3) Drum To Front Planet (.130" Thk) (3.630" OD) (2.720" ID) (5-Leg, 1-Tab, Plastic)	1	TBA
231	133407	Bearing W/Race, 09G 4-5-6 Clutch (K2) Drum To Case (.153" Thick) (2.665" OD) (1.877" ID) 2003-Up	1	TBA
232	133408	Race, 09G 4-5-6 Clutch (K2) Drum To Case (.031" Thick) (2.626" OD) (1.955" ID) 2003-Up	1	TBA
238	133409	Washer, 09G Front Planet To Ring Gear (.047" Thick) (3.100" OD) (2.595" ID) (3 Tab) (Plastic)	1	TBA
241	133410	Bearing W/Race, 09G Front Planet Sun Gear To Ring Gear (.129" Thick) (2.204" OD) (1.493" ID)	1	TBA
242	133411	Race, 09G Front Planet Sun Gear To Ring Gear (Cupped) (2.467" OD) (1.617" ID)	1	TBA
243	133412	Brg W/Race, 09G Front Planet Ring Gear To 1-2-3-4/(K1) Drum (.110" Thk) (1.926" OD) (1.414" ID)	1	TBA
244	133413	Race, 09G Front Planet Ring Gear To 1-2-3-4 Clu (K1) Drum (.059" Thick) (1.803" OD) (1.370" ID)	1	TBA
246	133414	Race, 09G Rear Planet Rear Sun Gear To 4-5-6/(K2) Drum (.031" Thick) (1.517" OD) (.885" ID)	1	TBA
247	133415	Bearing, 09G Rear Planet Rear Sun Gear To 4-5-6/(K2) Drum (.137" Thick) (1.515" OD) (.823" ID)	1	TBA
248	133416	Race, 09G Rear Planet Rear Sun Gear To 4-5-6/(K2) Drum (.031" Thick) (1.635" OD) (.829" ID)	1	TBA
250	133417	Washer, 09G Rear Planet To 4-5-6 Clutch (K2) Drum (.110" Thick) (3.740" OD) (8 Tabs) (Plastic)	1	TBA
251	133418	Race, 09G Rear Planet Front Sun Gear To Rear Sun Gear (.030" Thk) (1.635" OD) (1.237" ID)	1	TBA
252	133419	Bearing, 09G Rear Planet Front Sun Gear To Rear Sun Gear (.078" Thick) (1.700" OD) (1.252" ID)	1	TBA
253	133420	Race, 09G Rear Planet Front Sun Gear To Rear Sun Gear (.030" Thick) (1.635" OD) (1.179" ID) Flat	1	TBA
254	133421	Washer, 09G Transfer Nut To Rear Planet (.047" Thick) (2.782" OD) (2.360" ID) (4 Tabs) 2003-Up	1	TBA
273	133422	Cup Race, 09G Pinion Shaft To Case (.747" Thick) (2.833" OD) (Cast # 32207J) 2003-Up	1	TBA
274	133423	Cone Bearing, 09G Pinion Shaft To Case (.912" Thick) (1.284" ID) (Cast # R32Z-4) 2003-Up	1	TBA
276	133424	Shim, 09G Pinion Shaft To Case (Selective) (2.803" OD) (2.381" ID) 2003-Up	1	TBA
277	133425	Lock Washer, 09G Under Retaining Nut (1 Inner Tab, 29 Outer Tabs) 2003-Up	1	TBA
278-1	133426	Cup Race, 09G Drive Transfer Gear Inner Race (.488" Thick) (2.436" ID) 2003-Up	2	TBA
278	133427	Cup Race, 09G Drive Transfer Gear Outer Race (.368" Thick) (3.597" OD) 2003-Up	2	TBA
279	133428	Ball Bearing, 09G Drive Transfer Gear (W/Plastic Cage) (22 Balls) 2003-Up	2	TBA
280	133429	Cup Race, 09G Pinion Shaft To Bell Housing (.647" Thick) (3.149" OD) (Cast # R39-4A) 2003-Up	1	TBA
281	133430	Cone Bearing, 09G Pinion Shaft To Bell Housing (.745" Thick) (1.536" ID) (Cast # R39-4) 2003-Up	1	TBA
288	133431	Cup Race, 09G Differential To Case (.634" Thick) (4.250" OD) 2003-Up	1	TBA
289	133432	Cone Bearing, 09G Differential To Case (.726" Thick) (2.992" ID) (Cast # TR151102) 2003-Up	1	TBA
290	133433	Shim, 09G Differential To Case (Selective) (3.560" OD) (3.005" ID) 2003-Up	1	TBA
291	133434	Cup Race, 09G Differential To Bell Housing (.608" Thick) (3.188" OD) (Cast # STA5181) 2003-Up	1	TBA
292	133435	Cone Bearing, 09G Differential To Bell Housing (2.006" ID) (25 Rollers) 2003-Up	1	TBA
GASKETS & RUBBER COMPONENTS				
300	133500	Gasket, Bottom Pan, 09G, 8-Bolt, 2003-Up	1	TBA
300	133500A	Gasket, Bottom Pan, 09K, 7-Bolt, 2004-Up	1	09K-321-370
300	133500B	Gasket, Bottom Pan, 09M, 9-Bolt, 2006-Up	1	TBA
310	133510	Gasket, Pump (Metal) 2003-Up	1	TBA
311	106274A	O-Ring, Front Pump, 2003-Up	1	TBA

09G (TF-60SN), 09K (TF-61SN), 09M (TF-62SN)

ILL#	Part#		QTY	REF#
NI.....	133526	Gasket, Main Valve Body To Plate 2003-Up.....	1	TBA
NI.....	133527	Gasket, Plate To Valve Body Cover 2003-Up.....	1	TBA
NI.....	133528	Gasket, Large Auxiliary Valve Body Plate To Cover 2003-Up.....	1	TBA
NI.....	133528A	Gasket, Large Auxiliary Valve Body To Plate 2003-Up.....	1	TBA
NI.....	133529	Gasket, Small Auxiliary Valve Body Plate To Cover 2003-Up.....	1	TBA
NI.....	133529A	Gasket, Small Auxiliary Valve Body To Plate 2003-Up.....	1	TBA

TECHNICAL MANUALS

NI.....	TM09G	Technical Manual, 09G / 09K / 09M.....	1	TBA
NI.....	TM09G/TF60SN	Diagnostic Guide, 09G / 09K / 09M.....	1	TBA

ELECTRICAL COMPONENTS

410.....	133991	Switch, MLPS, 2003-Up.....	1	TBA
NI.....	133980	Pressure Switch, 2003-Up.....	2	50-1167
421.....	133954	Solenoid, Shift (N89) On-Off, 2003-Up.....	1	52-0933
422.....	133954	Solenoid, Shift (N88) On-Off, 2003-Up.....	1	52-0933
423.....	133952	K3 (3-5/Rev) Clutch Linear Shift Control Solenoid (Green Connector) 2003-Up.....	1	52-0489
425.....	133951	TCC Linear Solenoid (N91) (Black Connector) 2003-Up.....	1	52-0488
426.....	133952	K1 (1-2-3-4) Clutch Linear Shift Control (Green Connector) 2003-Up.....	1	52-0489
427.....	133952	K2 (4-5-6) Clutch Linear Shift Control (Green Connector) 2003-Up.....	1	52-0489
428.....	133952	EPC Linear Solenoid (N93) (Green Connector) 2003-Up.....	1	52-0489
440.....	133952	B1 (2-6) Clutch, Band Linear Shift Control Solenoid (Green Connector) 2003-Up.....	1	52-0489
NI.....	K133952	Kit, Linear Solenoid, 6-Solenoids (TCC, EPC & 4-Shift) 2003-Up.....	1	TBA
436.....	133954	Output Speed Sensor, 2003-Up.....	1	TBA
438.....	133958	Input Speed Sensor, 2003-Up.....	1	TBA
446.....	K133954	Wire Harness, OSS/ISS Speed & Temp Sensors & VB Press Switches (8-Pin Conn) 2003-04.....	1	09G927363B
446.....	K133954A	Wire Harness, OSS/ISS Speed & Temp Sensors (6-Pin Conn) 2004-Up (Rostra# 350-0149).....	1	09G927363A
446.....	133986	Wire Harness, Internal, 6-Pin, 2003-Up.....	1	TBA
446.....	133986A	Wire Harness, Internal, 8-Pin, 2003-Up.....	1	TBA
446.....	133986B	Wire Harness, Internal, 14-Pin Case Conn, 2003-Up (Rostra# 350-0151).....	1	09G927363
NI.....	59024	Bushing, Linear Solenoid Inductor Hsg (2ea Per Sol) See Tools Below.....	2	55526
NI.....	T31333	Tool, Linear Solenoid Opening & Closing Tool.....	1	31333
NI.....	T551580	Reamer, Solenoid Bushing, May Be Needed To "Size" New Bushing After Installation.....	1	551580

PUMPS & PUMP COMPONENTS

500.....	133912	Pump Assembly, 2003-Up.....	1	TBA
510.....	133916	Pump Body, 2003-Up.....	1	TBA
520.....	133913	Pump Stator, 2003-Up.....	1	TBA
530.....	K133201	Pump Gear Set, 09G (.441" Thick) (10 Outer Gear Lobes)(9 Inner Gear Lobes) 2003-Up.....	1	TBA

DRUMS & PISTON KITS

546.....	133171	Apply Ring, B1 (2-6) Clutch (B1) (Steel) (2.156" Thick)(7 1/4" OD) 2003-Up.....	1	TBA
552.....	133732	Drum, K1 (1-2-3-4) 2003-Up.....	1	TBA
554.....	133735	Drum, K2 (4-5-6) 2003-Up.....	1	TBA
555.....	133734	Drum, K3 (3-5/Rev) 2003-Up.....	1	TBA
560.....	K133762	Piston Kit, B1 (2-6) Clutch (Aluminum) 2003-Up.....	1	TBA
562.....	K133763	Piston Kit, K1 (1-2-3-4) Clutch (With Steel Piston & Bonded Retainer) 2003-Up.....	1	TBA
564.....	K133764	Piston Kit, K2 (4-5-6) Clutch (W/Bonded Piston & Retainer) 2003-Up.....	1	TBA
565.....	K133765	Piston Kit, K3 (3-5 Rev) Clutch (Steel Piston)(Bonded Retainer) 2003-Up.....	1	TBA
567.....	K133766	Piston Kit, B2 (Low/Rev) Clutch (B2)(Aluminum Piston Cast # F010) 2003-Up.....	1	TBA

PLANETS, RING GEARS, SUN GEARS, HOUSINGS & HUBS

582.....	133747	Planet, Front, 2003-Up.....	1	TBA
584.....	133748	Planet, Rear, 2003-Up.....	1	TBA
592.....	133757	Ring Gear, Front Planet W/Input Shaft (81 Teeth Ring Gear) 2003-Up.....	1	TBA
594.....	133758	Ring Gear, Rear Planet (78 Teeth)(1.465" Thick) 2003-Up.....	1	TBA
604.....	133741	Hub, Rear Planet Ring Gear (.396" Thick)(4.494" OD) 2003-Up.....	1	TBA
612.....	133753	Sun Gear, Front Planet (45 Teeth)(.577" Thick)(2.485" OD) 2003-Up.....	1	TBA
614.....	133755	Sun Gear, Rear Planet (Rear)(30 Teeth, 1 Groove)(3.530" Long) 2003-Up.....	1	TBA
622.....	133736	Housing, B1 (2-6) Clutch (Steel)(A Snap Ring Holds This To The Center Support) 2003-Up.....	1	TBA
624.....	133742	Hub, K3 (3-5 Rev) Clutch, Driving (40 Outer Teeth) 2003-Up.....	1	TBA
632.....	133826	Center Support (6 Bolt, Cast Iron)(Cast # 5317) 2003-Up.....	1	TBA

SPRAGS

644.....	133727	Sprag Assembly Low/Reverse (F1) (20 Rollers)(14 Outer Lugs)(Plastic Cage) 2003-Up.....	1	TBA
----------	--------	--	---	-----

DIFFERENTIALS & COMPONENTS

689.....	133621	Oil Baffle, 09G Pinion Shaft To Case (Tin) 2003-Up.....	1	TBA
689.....	133621A	Oil Baffle, 09G Differential To Bell Housing (Tin, 3 Bolt) 2003-Up.....	1	TBA

09G (TF-60SN), 09K (TF-61SN), 09M (TF-62SN)

ILL#	Part#		QTY	REF#
712.....	133884	Gear, 09G Driven Transfer (52 Teeth)(With 13 Parking Lugs) 2003-Up.....	1	TBA
715.....	133910	Differential Assembly, 2WD, 2003-Up.....	1	TBA
715.....	133910A	Differential Assembly, AWD, 2003-Up.....	1	TBA
716.....	133911	Differential Housing, 09G Less Ring Gear (Uses A 25 & A 30 Roller Bearing) 2003-Up.....	1	TBA
720.....	133845	Ring Gear, 09G Differential (61 Teeth, 4 Groove)(12 Bolt Holes) 2003-Up.....	1	TBA
730.....	133876	Pinion, 09G (15 Teeth, 4 Groove) (6 1/4" Long) 2003-Up.....	1	TBA
VALVE BODIES				
740.....	133754	Valve Body, 09G (W/2 Press Switches) (Remote Oil Cooler) 2003-6/04.....	1	TBA
740.....	133754B	Valve Body, 09G (W/2 Press Switches) (Oil Cooler On Case) 2003-6/04.....	1	TBA
740.....	133754A	Valve Body, 09G (No Press Switches) (Remote Oil Cooler) 7/04-Up.....	1	TBA
740.....	133754C	Valve Body, 09G (No Press Switches) (Oil Cooler On Case) 7/04-Up.....	1	TBA
VALVE BODY COMPONENTS				
741.....	15741-35K	End Plug Kit (Small, 9mm Plugs)(5 End Plugs & 7 O-Rings) 2003-Up.....	1	15741-35K
741.....	15741-36K	End Plug Kit (Large, 10mm Plugs)(5 End Plugs & 7 O-Rings) 2003-Up.....	1	15741-36K
741.....	15741-29K	Lock-Up Control Valve Kit, (Sleeve, Valve, Spring, Spacer, Plunger Valve, & Plunger Sleeve)..... Must Use T-F-15741-TL29 & T-F-15741-TL29PL & VB-FIX.....	1	15741-29K
741.....	15741-25K	Clutch Control Valve Kit, C1 & K1 (Sleeve, Spring & Valve) (Must Use T-F-15741-TL25 & T-VB-FIX).....	1	15741-25K
741.....	15741-14K	Accumulator Piston Kit, Clutch/Band/Line Accumulator (1-Accum Piston & 1-O-Ring) 2003-Up.....	1	15741-14K
741.....	15741-18K	Valve Kit, Solenoid Modulator (Solenoid Modulator Valve, Solenoid Modulator Sleeve, Spring & Plug)..... Requires: T-F-15741-TL18, T-VB-FIX & T-F-15741-TL29PL If Reaming Upper Valve Body #2.....	1	15741-18K
759.....	15759-01K	Ring Tower Sleeve, 09G (K2 Clutch)(In Rear Of Case) 2003-Up.....	1	15759-01K
CASES & PANS				
750.....	133703	Bell Housing, 09G (Starter At 2:00)(Cast # 09G 321 107 A) 2003-Up.....	1	TBA
760.....	133701	Case, 09G (Cast # 09G 321 105) 2003-Up.....	1	TBA
765.....	133801	Pan, Bottom, 2003-Up.....	1	09G-321-351
SNAP RINGS				
795.....	133081	Nut, Drive Transfer Gear Retaining (.222" Thick)(24 Outer Notches) 2003-Up.....	1	TBA
850.....	133141	Cushion, B1 (2-6 Clutch) (.039" Thick)(7 1/4" OD) 2003-Up.....	1	TBA
861.....	133601	Snap Ring, Holds B1 (2-6) Housing To Center Supp (.038" Thick)(6 1/2" OD) (W/2 Hooked Ends).....	1	TBA
862.....	133602	Snap Ring, Holds B1 (2-6 Clutch) Spring Retainer In (.046" Thick)(6 13/16" OD) 2003-Up.....	1	TBA
873.....	133603	Snap Ring, Holds K1 (1-2-3-4 Clutch) Pressure Plate In Drum (.063" Thick)(6 1/4" OD) 2003-Up.....	1	TBA
874.....	133604	Snap Ring, Holds K1 (1-2-3-4 Clutch) Retainer In Drum (.059" Thick)(2.033" OD) 2003-Up.....	1	TBA
876.....	133605	Snap Ring, Holds K2 (4-5-6) Clutch) Pressure Plate In Drum (.063" Thick)(6 1/8" OD) 2003-Up.....	1	TBA
877.....	133606	Snap Ring, Holds K2 (4-5-6 Clutch) Spring Retainer In (.046" Thick)(2.158" OD) 2003-Up.....	1	TBA
878.....	133607	Snap Ring, Holds K3 (3-5 Reverse Clutch) Pressure Plate In Drum (.062" Thick)(6 1/2" OD) 2003-Up.....	1	TBA
879.....	133608	Snap Ring, Holds K3 (3-5 Reverse Clutch) Spring Retainer In Drum (.057" Thick)(2.025" OD) 2003-Up.....	1	TBA
886.....	133609	Snap Ring, Holds B2 (Low/Rev Clutch) Spring Retainer In Case (.062" Thick)(7 1/16" OD) 2003-Up.....	1	TBA
887.....	133610	Snap Ring, Holds F1 Low/Rev Sprag To Case (.047" Thick)(7 3/8" OD) 2003-Up.....	2	TBA
889.....	133611	Snap Ring, Holds Rear Planet Ring Gear Hub To Ring Gear (.047" Thick)(4.870" OD) 2003-Up.....	1	TBA
898.....	133612	Snap Ring, Drive Transfer Gear (.046" Thick)(4.050" OD) 2003-Up.....	1	TBA
PISTONS, RETAINERS & MISCELLANEOUS				
960.....	133762	Piston, B1 (2-6) Clutch (Aluminum) 2003-Up.....	1	TBA
962.....	133763	Piston, K1/C1 (1-2-3-4) Clutch (Steel) (2003-Up.....	1	TBA
964.....	133764	Piston, K2/C2 (4-5-6) Clutch (Bonded) 2003-Up.....	1	79423
965.....	133765	Piston, K3/C3 (3-5/Rev) Clutch (Steel) 2003-Up.....	1	TBA
967.....	133766	Piston, B2 (Low/Rev) Clutch (Aluminum) 2003-Up.....	1	TBA
982.....	133863	Retainer/Balance Piston, K1/C1 (1-2-3-4) Clutch (Bonded) (.390" Tall) 2003-Up.....	1	79425
982.....	133863A	Retainer/Balance Piston, K1/C1 (1-2-3-4) Clutch (Bonded) (.475" Tall) 2006-Up.....	1	79234
984.....	133864	Retainer/Balance Piston, K2/C2 (4-5-6) Clutch (Bonded) 2003-Up.....	1	79418
985.....	133865	Retainer/Balance Piston, K3/C3 (3-5/Rev) Clutch (Bonded) 2003-Up.....	1	79428
926.....	133281	Spring, B1 Accumulator (Pink) 2003-Up.....	1	TBA
927.....	133998	Piston, B1 Accumulator (1.875" Long)(.944" OD) 2003-Up.....	1	TBA
960.....	133762	Piston, B1 (2-6) Clutch (In Pump Body)(Aluminum)(.532" Thick)(6 3/8" OD) 2003-Up.....	1	TBA
962.....	133763	Piston, K1/C1 (1-2-3-4) Clutch (Steel) (20 Spring Pockets)(5.744" OD) 2003-Up.....	1	TBA
964.....	133764	Piston, K2/C2 (4-5-6) Clutch (Bonded) 2003-Up.....	1	79423
965.....	133765	Piston, K3/C3 (3-5/Rev) Clutch (Steel) (28 Spring Pockets) (10 Outer Teeth) 2003-Up.....	1	TBA
967.....	133766	Piston, B2 (Low/Rev) Clutch (Aluminum) (Cast # F010) 2003-Up.....	1	TBA
970.....	133872	Spring Retainer, B1 (2-6) Clutch Return (12 Springs) (7 1/2" OD) 2003-Up.....	1	TBA
972.....	133873	Spring, K1(1-2-3-4)B Clutch Return (20 Springs)(3.676" OD) 2003-Up.....	1	TBA
974-1	133622	Seat, K2 (4-5-6) Clutch Spring (24 Spring Pockets)(3.925" OD) 2003-Up.....	1	TBA
974.....	133874	Spring, K2 (4-5-6) Clutch Return (24 Springs)(3.898" OD) 2003-Up.....	1	TBA
975.....	133875	Spring, K3 (3-5/Rev) Clutch Return (28 Springs)(3.830" OD) 2003-Up.....	1	TBA
977.....	133877	Spring, B2 (Low/Rev) Clutch Return (13 Springs)(6 3/4" OD) 2003-Up.....	1	TBA

09G (TF-60SN), 09K (TF-61SN), 09M (TF-62SN)

ILL#	Part#		QTY	REF#
982.....	133863	Retainer/Balance Piston, K1/C1 (1-2-3-4) Clutch (Bonded) (.390" Tall) 2003-Up	1	79425
982.....	133863A.....	Retainer/Balance Piston, K1/C1 (1-2-3-4) Clutch (Bonded) (.475" Tall) 2006-Up	1	79234
984.....	133864	Retainer/Balance Piston, K2/C2 (4-5-6) Clutch (Bonded) 2003-Up	1	79418
985.....	133865	Retainer/Balance Piston, K3/C3 (3-5/Rev) Clutch (Bonded) 2003-Up	1	79428
991-1	K133623.....	Linkage Assembly, 09G Internal 2003-Up	1	TBA
991.....	133623	Linkage Rod, 09G (14 1/16" Long) 2003-Up	1	TBA
994.....	133624	Park Pawl Actuator, 09G 2003-Up.....	1	TBA
995.....	K133624.....	Park Pawl Assembly, 09G 2003-Up.....	1	TBA
998.....	133625	Oil Cooler, 09G (Bolts On Top Of Bell Housing)(Cast #09G 409 061) 2003-Up.....	1	TBA
999.....	133626	Tube Set, 09G Lube (3 Tubes) 2003-Up	1	TBA

AG4, 095, 096 (01M), 098 (01P)

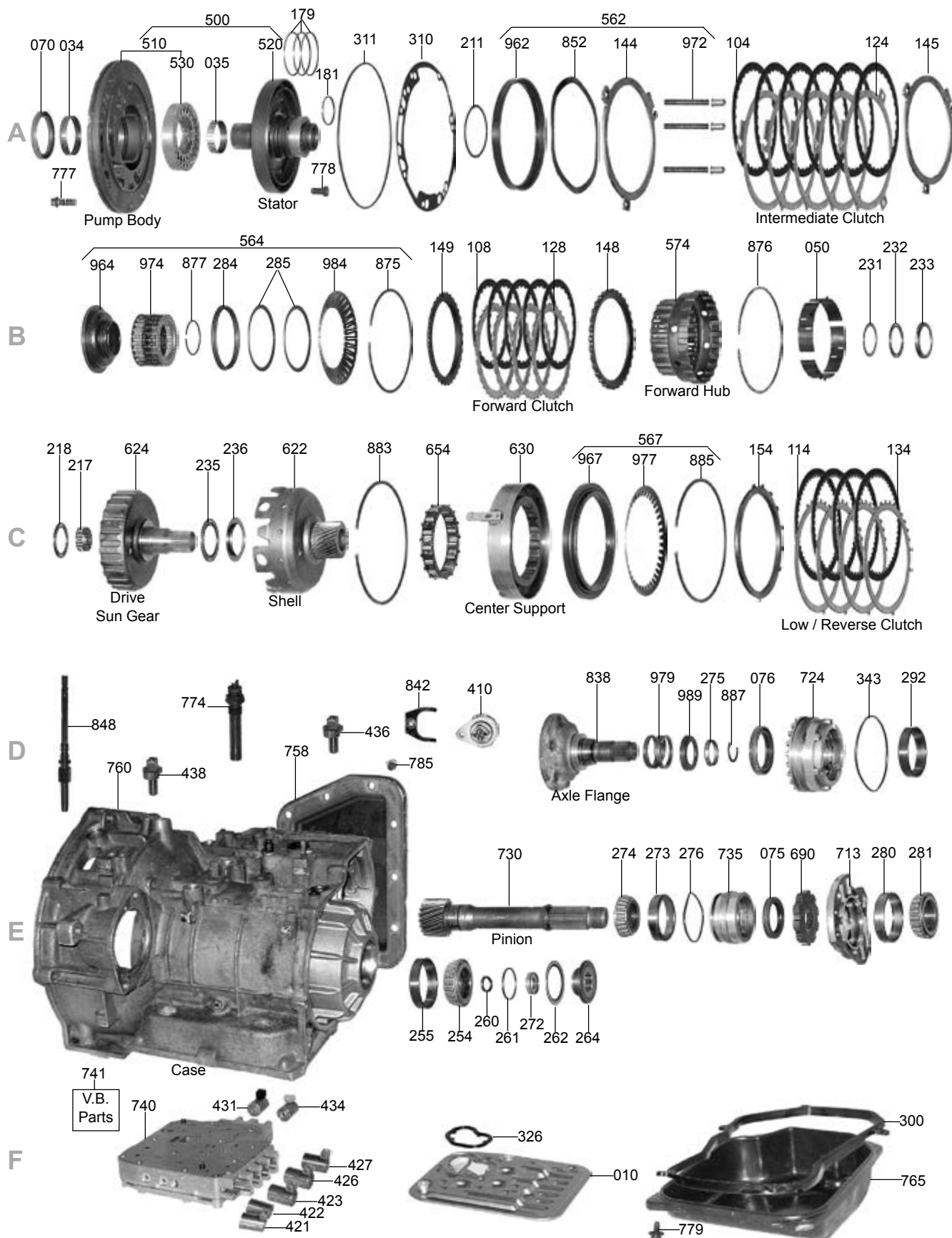

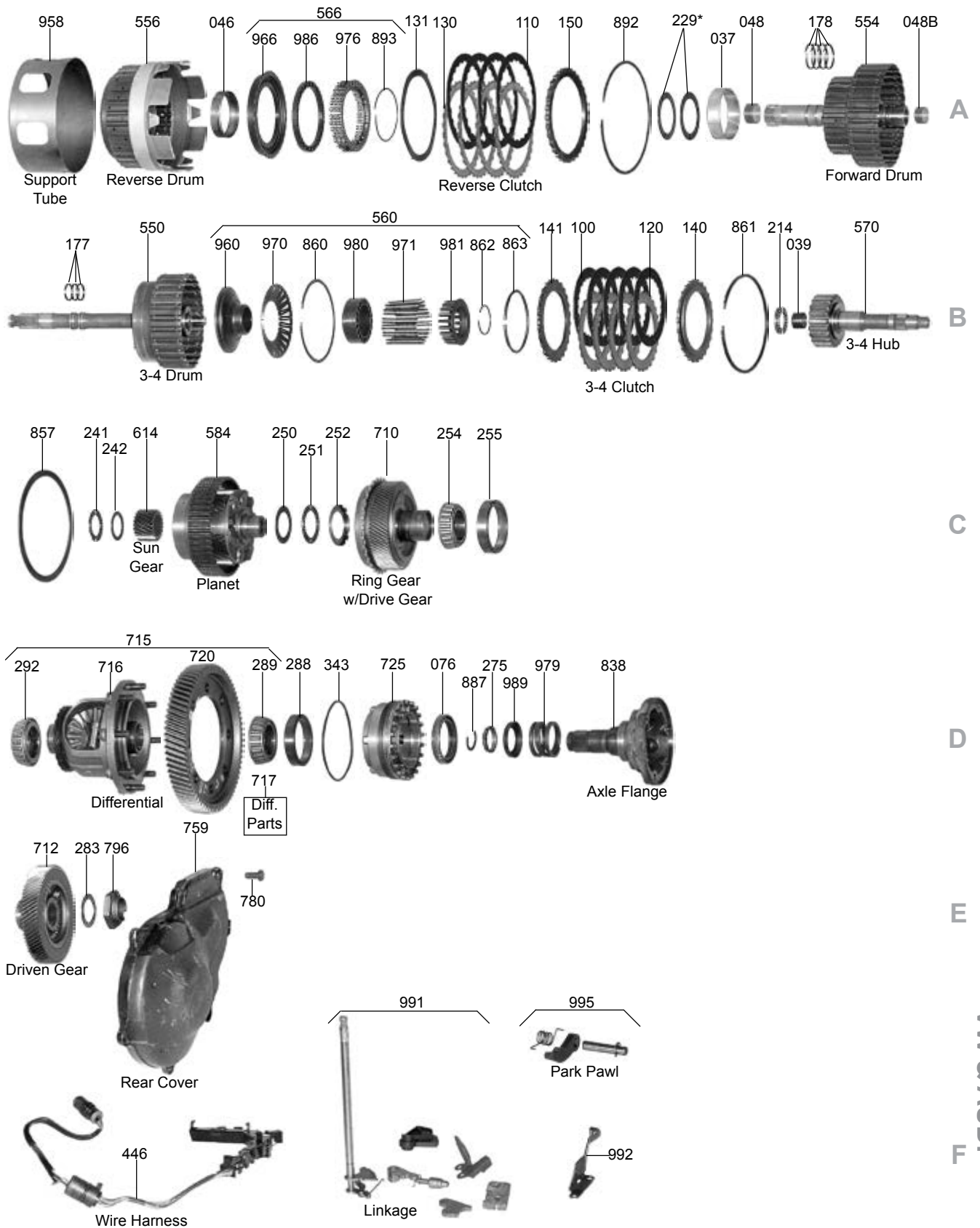

AG4, 097 (01N)

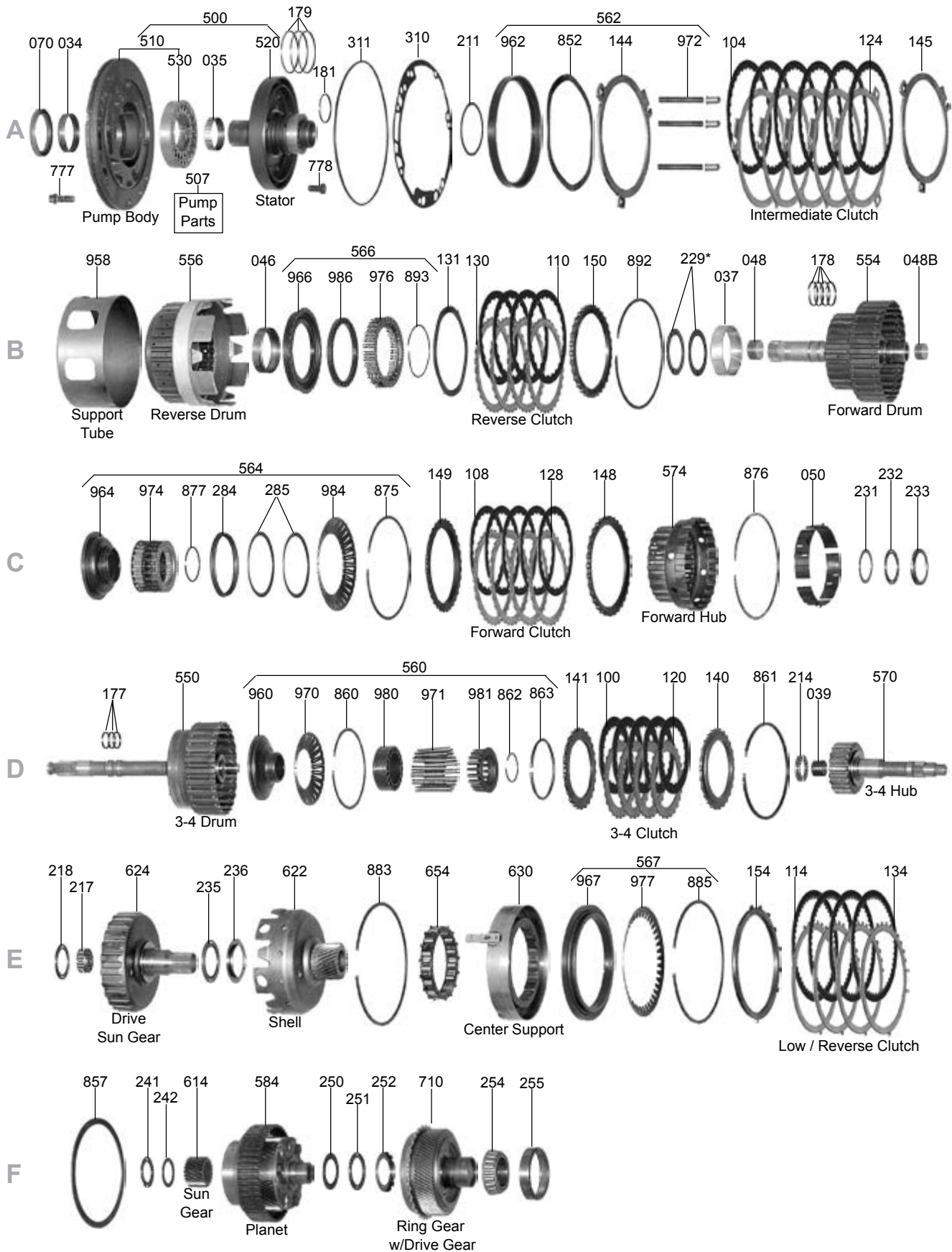

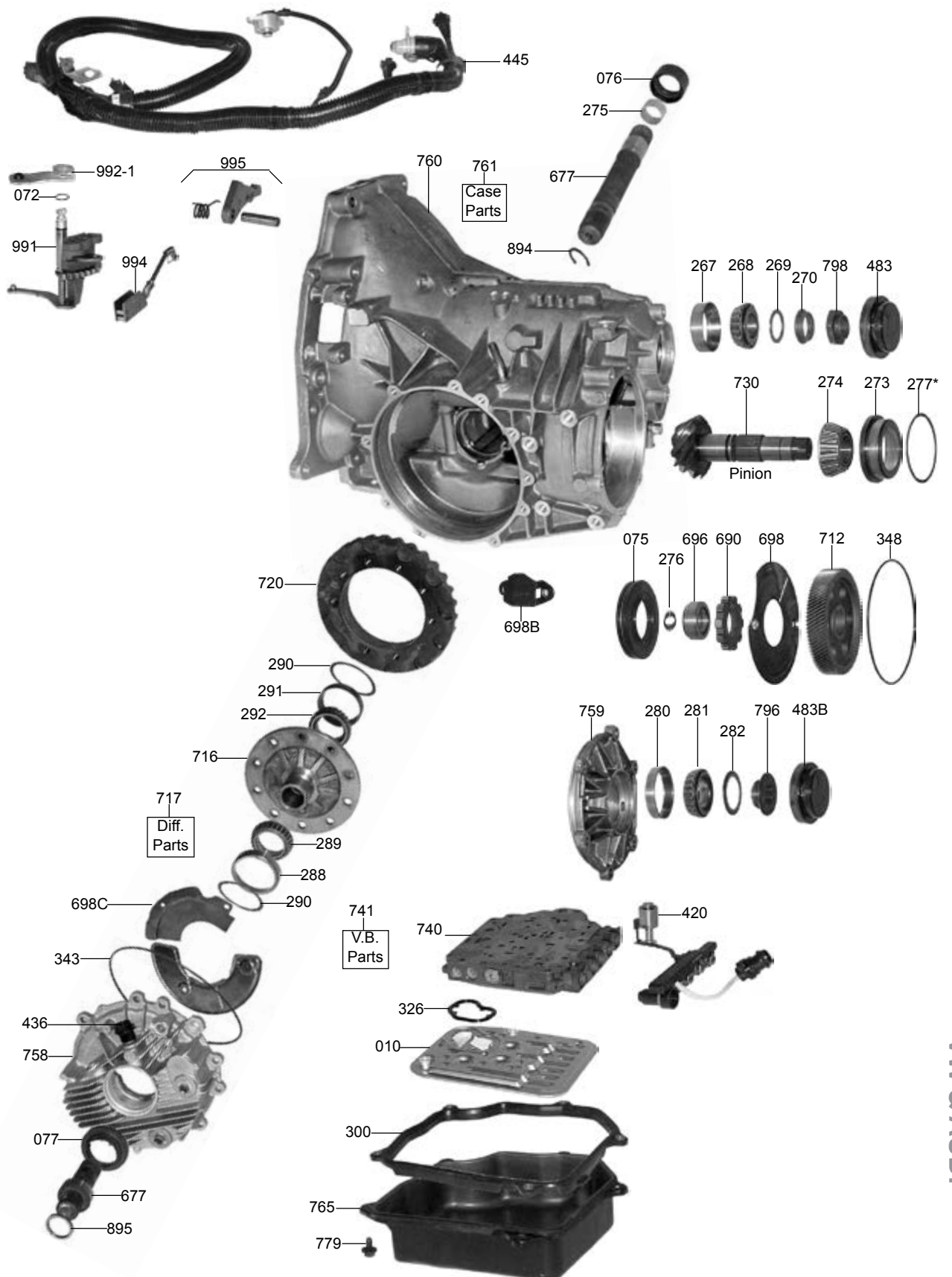

AG4, 095, 096 (01M), 097 (01N), 098 (01P)

ILL#	Part#		QTY	REF#
OVERHAUL KITS & PISTON KITS				
NI.....	K111900.....	Overhaul Kit, 095/096 W/Pistons (German Built) 1989-12/94.....	1.....	N/A
NI.....	K119900X.....	Overhaul Kit, 095/096 W/Out Piston (German & Mexican Built) 1989-12/94.....	1.....	N/A
NI.....	K119900A.....	Overhaul Kit, 01M W/Pistons 1/95-03, 096 (Mexican Built) 8/93-12/94.....	1.....	N/A
NI.....	K119900B.....	Overhaul Kit, 097(AG4) W/ Pistons (German Built) 1989-12/94.....	1.....	N/A
NI.....	K119900BX.....	Overhaul Kit, 097(AG4) W/Out Pistons (German Built) 1989-12/94.....	1.....	N/A
NI.....	K119900E.....	Overhaul Kit, 098(AG4) W/ Bonded Pistons (German Built) 1992-94.....	1.....	N/A
NI.....	K119900EX.....	Overhaul Kit, W/Out Pistons 098(AG4) (German Built) 1992-94, 01P/099 1/95-03, 098 8/93-12/94 (Mexican Built).....	1.....	N/A
NI.....	K119900G.....	Overhaul Kit, W/Pistons, 01N 1/95-03, 097 1/93-12/94 (Mexican Built Code "CFS").....	1.....	N/A
NI.....	K119900GX.....	Overhaul Kit, W/Out Pistons, 01N 1/95-03, 097 1/93-12/94 (Mexican Built Code "CFS").....	1.....	N/A
NI.....	K119900K.....	Overhaul Kit, W/Pistons, 01P/099 1/95-03, 098 8/93-12/94 (Mexican Built).....	1.....	N/A
NI.....	K119900P.....	Piston Kit, 095/096/097/098, 1989-12/94 (5-Clutch Pistons).....	1.....	N/A
NI.....	K119922A.....	Piston Kit, 095/096/097/098, 1/95-Up (7-Clutch Pistons).....	1.....	N/A
NI.....	K119900E-4.....	Piston & Cover Kit, 095/096/097/098, 1/95-Up (7-Clutch Pistons & 4-Flange Covers).....	1.....	N/A
		MEXICAN BUILT VIN # BEGINS "3VW" / GERMAN BUILT VIN # BEGINS "WVW"*		
MASTER L/STEEL KITS				
NI.....	DK11900S.....	Master L/Steels Kit, W/Pistons 095, 096 (AG4) German Built, 1989-12/94.....	1.....	N/A
NI.....	DK11900XS.....	Master L/Steels Kit, W/Out Pistons 095, 096 (AG4) German Built, 1989-12/94.....	1.....	N/A
NI.....	DK11900AS.....	Master L/Steels Kit, W/Pistons 01M (All), 096 Mexican Built, 01M 1/95-03 (All Except 01-03 Jetta VR-6 & Passat VR-6), 096 8/93-12/94.....	1.....	N/A
NI.....	DK11900AXS.....	Master L/Steels Kit, W/Out Pistons 01M (All), 096 Mexican Built, 01M 1/95-03 (All Except 01-03 Jetta VR-6 & Passat VR-6), 096 8/93-12/94.....	1.....	N/A
NI.....	DK11900BS.....	Master L/Steels Kit, W/Pistons 097 (AG4) German Built, 1989-12/94.....	1.....	N/A
NI.....	DK11900BXS.....	Master L/Steels Kit, W/Out Pistons 097 (AG4) German Built, 1989-12/94.....	1.....	N/A
NI.....	DK11900ES.....	Master L/Steels Kit, W/Pistons 098 (AG4) German Built, Eurovan, Sharon, 1992-94.....	1.....	N/A
NI.....	DK11900EXS.....	Master L/Steels Kit, W/Out Pistons 098 (AG4) German Built, Eurovan, Sharon, 1992-94.....	1.....	N/A
NI.....	DK11900GS.....	Master L/Steels Kit, W/Pistons 01N(All) 1/95-03, 097 Mexican Built Code "CFS"1/93-12/94.....	1.....	N/A
NI.....	DK11900GXS.....	Master L/Steels Kit, W/Out Pistons 01N(All) 1/95-03, 097 Mex Built Code "CFS"1/93-12/94.....	1.....	N/A
NI.....	DK11900KS.....	Master L/Steels Kit, W/Pistons 01P/099 (All), 1/95-03, 098 Mexican Built, 8/93-12/94.....	1.....	N/A
MASTER W/STEELS KITS				
NI.....	DK11900.....	Master W/Steels Kit, W/Pistons 095, 096 (AG4) German Built, 1989-12/94.....	1.....	N/A
NI.....	DK11900X.....	Master W/Steels Kit, W/Out Pistons 095, 096 (AG4) German Built, 1989-12/94.....	1.....	N/A
NI.....	DK11900A.....	Master W/Steels Kit, W/Pistons 01M (All), 096 Mexican Built, 01M 1/95-03 (All Except 01-03 Jetta VR-6 & Passat VR-6), 096 8/93-12/94.....	1.....	N/A
NI.....	DK11900AX.....	Master W/Steels Kit, W/Out Pistons 01M (All), 096 Mexican Built, 01M 1/95-03 (All Except 01-03 Jetta VR-6 & Passat VR-6), 096 8/93-12/94.....	1.....	N/A
NI.....	DK11900B.....	Master W/Steels Kit, W/Pistons 097 (AG4) German Built, 1989-12/94.....	1.....	N/A
NI.....	DK11900BX.....	Master W/Steels Kit, W/Out Pistons 097 (AG4) German Built, 1989-12/94.....	1.....	N/A
NI.....	DK11900E.....	Master W/Steels Kit, W/Pistons 098 (AG4) German Built, Eurovan, Sharon, 1992-94.....	1.....	N/A
NI.....	DK11900EX.....	Master W/Steels Kit, W/Out Pistons 098 (AG4) German Built, Eurovan, Sharon, 1992-94.....	1.....	N/A
NI.....	DK11900G.....	Master W/Steels Kit, W/Pistons 01N(All) 1/95-03, 097 Mexican Built Code "CFS"1/93-12/94.....	1.....	N/A
NI.....	DK11900GX.....	W/Steels Kit, W/Out Pistons 01N(All) 1/95-03, 097 Mexican Built Code "CFS"1/93-12/94.....	1.....	N/A
NI.....	DK11900K.....	Master W/Steels Kit, W/Pistons 01P/099 (All), 1/95-03, 098 Mexican Built, 8/93-12/94.....	1.....	N/A
FILTERS				
010.....	119710.....	Filter, 1990-95 (With Kidney Shape Inlet).....	1.....	095-325-429D
010.....	119710A.....	Filter, 1996-Up (With Round Inlet).....	1.....	01M-325-429
BUSHINGS				
030.....	K119905.....	Bushing Kit, 095/096/097/098.....	1.....	TBA
030.....	119905-01K.....	Bsh & Wsh Kit, Includes: Fwd Drum/K1, Shaft/K1 (096/097/098 Only), Rev Drum/K2, Pump Gear, Pump Hsg Bushings And 2-Washers (1-OE Thick & 1-.015" Oversize).....	1.....	119905-01K
		*Recommended Removal & Install Tools: 119905-TL1, 119905-TL2, 119905-TL5.....		
034.....	119005.....	Bushing, 095/096/097/098 Pump Body.....	1.....	TBA
035.....	119024.....	Bushing, 095/096/097/098 Inner Pump Gear.....	1.....	TBA
037.....	119004.....	Bushing, 095/096/097/098 Forward Drum (Large) (Front) (To Stator).....	1.....	TBA
039.....	119007.....	Bushing, 095/096/097/098 3-4 Hub (Pilot) (Front) (To Forward Drum).....	1.....	TBA
048.....	119001.....	Bushing, 095/096/097/098 Forward Drum Shaft (Small) (Front).....	1.....	TBA
048.....	119002.....	Bushing, 095/096/097/098 Forward Drum Shaft (Small) (Rear).....	1.....	TBA
050.....	119013A.....	Bushing, 095/096 (01M) Forward Hub To 3-4 Drum (Plastic Insert) (.768" Tall).....	1.....	TBA
050.....	119013B.....	Bushing, 097/098 Forward Hub To 3-4 Drum (Plastic Insert) (.650" Tall).....	1.....	TBA
METAL CLAD SEALS				
070.....	119151.....	Seal, 095/096/097/098 Front.....	1.....	096-95-321-243
072.....	119152.....	Seal, 095/096/098 Manual Control Shaft (exc 097/01N).....	1.....	095-321-182B

AG4, 095, 096 (01M), 097 (01N), 098 (01P)

ILL#	Part#		QTY	REF#
075.....	119153	Seal, 095/096/01M Pinion/Output Shaft Large-52mm.....	1.....	096-323-862-A
075.....	119153A	Seal, 095/096/01M Pinion/Output Shaft Small-50mm.....	1.....	095-323-862-A
075.....	119153B	Seal, 097/01N Pinion/Output Shaft.....	1.....	TBA
075.....	119153C	Seal, 098/01P Pinion/Output Shaft.....	1.....	TBA
076.....	79309	Seal, 095/096/01M Axle Both Sides, 01N Left.....	2.....	TBA
076.....	119154	Seal, 098/01P Axle Both Sides, 01N Right.....	2.....	016-409-399B
076.....	119155	Seal, 097 Axle Left.....	1.....	TBA
077.....	119156	Seal, 097 Axle Right.....	1.....	TBA
FRICTIONS				
100.....	119108	Friction, 095/096/097/098 3-4 Clutch (K3) .063" (3.80" OD) 22 Teeth 1990-94.....	4-6.....	TBA
100.....	119108A	Friction, 095/096/097/098 3-4 Clutch (K3) .063" (4.05" OD) 1995-Up.....	4-6.....	TBA
100.....	119108B	Friction, 095/096 (01M) 3-4 Clutch (K3) (.049") (22 Internal Teeth) (1 Sided) 200-03.....	4-6.....	TBA
120.....	119108C	Friction, 095/096 (01M) 3-4 Clutch (K3) (.048") (28 External Teeth) (1 Sided) 2000-03.....	4-6.....	TBA
NI.....	K119108	Friction Module, 01M / 01N 3-4 Clutch (K3) "PowerPack" Alto.....	1.....	109757
NI.....	K119108A	Friction Module, 01P 3-4 Clutch (K3) "PowerPack" Alto.....	1.....	109757A
NI.....	K119108B	Friction Module, 01P 3-4 Clutch (K3) Drum Saver.....	1.....	TBA
104.....	119102	Friction, 095/096/097/098 Intermediate Cl (B2) .063" (6.10" OD) 32T 1990-Up.....	4-6.....	TBA
108.....	119106	Friction, 095/096/097/098 Fwd Clu (K1) .063" (4.80" OD) 24T 1990-Up.....	4-10.....	TBA
110.....	119106	Friction, 095/096/097/098 Reverse Cl (K2) .063" (4.80" OD) 24T 1990-Up.....	4-5.....	TBA
114.....	119103	Friction, 095/096/097/098 Low/Rev Cl (B1) .063" (5.75" OD) 50T (Smooth) 1990-96.....	4-5.....	TBA
114.....	119103A	Friction, 095/096/097/098 Low/Rev Cl (B1) .063" (5.75" OD) 50T (Grooved) 1997-Up.....	4-5.....	TBA
119.....	K119F	Friction Module, 095/096/097 1989-94.....	1.....	TBA
119.....	K119AF	Friction Module, 095/096/097 1995-Up.....	1.....	TBA
STEELS				
120.....	119109	Steel, 095/096/097/098 3-4 Clutch (K3) .079" (2.80" ID) 26 Teeth 1990-94.....	3-5.....	TBA
120.....	119109B	Steel, 095/096/097/098 3-4 Clutch (K3) .063" (2.80" ID) 28 Teeth 1995-Up.....	4-6.....	TBA
120.....	119109A	Steel, 095/096/097/098 3-4 Clutch (K3) .058" (2.80" ID) 28 Teeth 1995-Up.....	4-6.....	TBA
120.....	119108C	Friction, 095/096 (01M) 3-4 Clutch (K3) (.048") (28 External Teeth) (1 Sided) 2000-03.....	4-6.....	TBA
124.....	119104	Steel, 095/096/097/098 Intermediate Clutch (B2) .079" (5.35" ID) 3 Teeth 1990-Up.....	5-7.....	TBA
124.....	119104A	Steel, 095/096/097/098 Intermediate Clutch (B2) .089" (5.35" ID) 3 Teeth 1990-Up.....	AR.....	TBA
124.....	119104B	Steel, 095/096/097/098 Intermediate Clutch (B2) .095" (5.35" ID) 3 Teeth 1990-Up.....	AR.....	TBA
124.....	119104G	Steel, 095/096/097/098 Intermediate Clutch (B2) .108" (5.35" ID) 3 Teeth 1990-Up.....	AR.....	TBA
124.....	119104C	Steel, 095/096/097/098 Intermediate Clutch (B2) .118" (5.35" ID) 3 Teeth 1990-Up.....	AR.....	TBA
128.....	119107	Steel, 095/096/097/098 Fwd Clu (K1) .079" (4.10" ID) 32T (Also Rev Clu K2) 1990-Up.....	4-10.....	TBA
128.....	119107A	Steel, 095/096/097/098 Forward Clutch (K1) .057" (4.10" ID) 32 Teeth 1995-Up.....	4-6.....	TBA
130.....	119107	Steel, 095/096/097/098 Reverse Clutch (K2) .079" (4.10" ID) 32 Teeth 1990-Up.....	5.....	TBA
131.....	119107C	Steel, 095/096/097/098 Reverse Clutch (Cushion) .058" (2 Teeth).....	1.....	TBA
134.....	119100	Steel, 095/096/097/098 Low/Reverse Clutch (B1) .079" (5.10" OD) 12 Teeth 1990-94.....	4-5.....	TBA
134.....	119100A	Steel, 095/096/097/098 Low/Reverse Clutch (B1) .057" (5.10" OD) 12 Teeth 1995-Up.....	4-6.....	TBA
PRESSURE PLATES				
140.....	119139A	Pressure Plate, 095/096/097/098 3-4 Clutch (Top) K3 (.125") 26 Teeth.....	1.....	TBA
140.....	119139AA	Pressure Plate, 095/096/097/098 3-4 Clutch (Top) K3 (28 Teeth).....	1.....	TBA
141.....	119139B	Apply Plate, 095/096/097/098 3-4 Clutch (Bottom) K3 (26 Teeth).....	1.....	TBA
141.....	119139BA	Apply Plate, 095/096/097/098 3-4 Clutch (Bottom) K3 (28 Teeth).....	1.....	TBA
144.....	119134	Pressure Plate, 095/096/097/098 Intermediate Clutch (Front) B2.....	1.....	TBA
145.....	119134AA	Apply Plate, 095/096/097/098 Intermediate Clutch (Rear) B2.....	1.....	TBA
148.....	119131	Pressure Plate, 095/096/097/098 Forward Clutch (Top) K1.....	1.....	TBA
149.....	119131AA	Apply Plate, 095/096/097/098 Forward Clutch (Bottom) K1.....	1.....	TBA
150.....	119131	Press Plate, 095/096/097/098 Rev Clu (Top) K2 .171" Thick On ID (.188" Thick On OD).....	1.....	TBA
150.....	119131A	Press Plate, 095/096/097/098 Rev Clu (Top) K2 .121" Thick On ID, .188" Thick On OD.....	1.....	TBA
150.....	119131B	Pressure Plate, 095/096/097/098 Reverse Clutch (Top) K2 .251" Overall Thickness.....	1.....	TBA
154.....	119130A	Pressure Plate, 095/096/097/098 Low/Reverse Clutch (Top) B1.....	1.....	TBA
VALVE BODY KITS				
165.....	K119908	Shift Kit, 095/096 (01M) Fits Units With Round Lip Seal Grommet Type Filter 1995-Up.....	1.....	SK-VW-01M
SEALING RINGS				
175.....	K119903	Ring Kit, 095/096/097/098.....	1.....	TBA
177.....	119301	Ring, 095/096/097/098 Input Shaft.....	2.....	TBA
178.....	119302	Ring, 095/096/097/098 Turbine Shaft.....	4.....	TBA
179.....	119303	Ring, 095/096/097/098 Reverse Clutch.....	2.....	TBA
181.....	119304	Ring, 095/096/097/098 Forward Clutch.....	1.....	TBA
WASHERS & BEARINGS				
200.....	K119907	Washer Kit, 095/096/097/098.....	1.....	TBA

AG4, 095, 096 (01M), 097 (01N), 098 (01P)

ILL#	Part#		QTY	REF#
211	119403	Washer, 095/096/097/098 Stator To Reverse Drum (.038" Thick, Plastic)	1	095-323-345
211	119403A	Washer, 095/096/097/098 Stator To Reverse Drum (.046" Thick, Plastic)	1	095-323-345A
211	119403B	Washer, 095/096/097/098 Stator To Reverse Drum (.054" Thick, Plastic)	1	095-323-345B
211	119403C	Washer, 095/096/097/098 Stator To Reverse Drum (.062" Thick, Plastic)	1	095-323-345C
211	119403D	Washer, 095/096/097/098 Stator To Reverse Drum (.069" Thick, Plastic)	1	095-323-345D
214	119415	Bearing W/Race, 095/096/097/098 3-4 Clutch Drum To 3-4 Clutch Hub	1	TBA
217	119416	Cage Bearing, 095/096/097/098 3-4 Clutch Hub To Drive Hub	1	095 323 907
218	119417	Bearing, 095/096/097/098 3-4 Clutch Hub To Drive Hub	1	095 323 909
229	119404	Washer, 095/096/097/098 Rev Clu Drum To Fwd Clu Drum (Plastic)(.045" Thk)	1	TBA
231	119440	Race, 095/096/097/098 Forward Clutch Drum To 3-4 Clutch Drum (Front)	1	095 323 165
232	119418	Bearing, 095/096/0947/098 Forward Clutch Drum To 3-4 Clutch Drum	1	TBA
233	119441	Race, 095/096/097/098 Forward Clutch Drum To 3-4 Clutch Drum (Rear)	1	TBA
235	119419	Bearing, 095/096/097/098 Drive Hub To Sun Shell	1	095 323 708
236	119442	Race, 095/096/097/098 Drive Hub To Sun Shell	1	095 323 714
241	119420	Bearing, 095/096/097/098 Sun Shell To Rear Sun Gear 1990-92	1	095 323 727
241	119420A	Bearing, 095/096/097/098 Sun Shell To Rear Sun Gear 1993-95	1	095 323 727B
242	119443	Race, 095/096/097/098 Sun Shell To Rear Sun Gear	1	095 323 715
250	119402	Race, 095/096/097/098 Planet To Ring Gear (Front)	1	095 323 739
251	119421	Bearing, 095/096/097/098 Planet To Ring Gear	1	TBA
252	119401	Race, 095/096/097/098 Planet To Ring Gear (Rear)	1	095 323 743A
254	119977	Tapered Bearing, 095/096/097/098 Ring Gear To Case	2	003 519 185
255	119978	Cup Race, 095/096/097/098 Ring Gear To Case	2	TBA
262	119405	Washer, 095/096/097/098 Collar To Bearing	1	TBA
264	119444	Collar/Nut, 095/096/098 Rear Planet Ring Gear To Case Bearing	1	TBA
272	119422	Bearing W/Races, 095/096/098 Rear Planet Ring Gear To Collar/Nut	1	TBA
273	119978A	Cup Race, 095/096/097/098 Pinion Bearing Cup	1	TBA
274	119977A	Tapered Bearing, 095/096/097/098 Pinion	1	TBA
275	119406	Washer, 095/096/097/098 Axle Flange To Differential Housing	1	TBA
276	119407	Washer, 095/096/097/098 Park Gear To Pinion Bearing	1	TBA
280	119978B	Cup Race, 095/096/097/098 Driven Transfer Gear Bearing	1	TBA
281	119977B	Tapered Bearing, 095/096/097/098 Driven Transfer Gear	1	TBA
283	119423	Bearing W/Races, 095/096/097/098 Transfer Driven Gear To Bolt	1	TBA
284	119445	Spacer, 095/096/097/098 Under Forward Clutch Beveled Spring	1	TBA
285	119446	Shim, 095/096/097/098 Under Forward Clutch Beveled Spring	1	TBA
288	119978C	Cup Race, 095/096/097/098 Differential Bearing Cup (Rear)	1	TBA
289	119977C	Tapered Bearing, 095/096/097/098 Differential (Rear)	1	TBA
291	119978D	Cup Race, 095/096/097/098 Differential Bearing Cup (Front)	1	TBA
292	119977D	Tapered Bearing, 095/096/097/098 Differential (Front)	1	TBA
GASKETS & RUBBER COMPONENTS				
300	119500	Gasket, 095/096/01M Bottom Pan	1	TBA
300	119500A	Gasket, 097 Bottom Pan	1	TBA
300	119500C	Gasket, 01N Bottom Pan	1	TBA
300	119500B	Gasket, 098/099/01P Bottom Pan	1	TBA
303	119506	Gasket, 095/096/097/098 Differential Cover	1	TBA
304	119505	Gasket, 095/096/097/098 Transfer Gear Cover	1	TBA
310	119503	Gasket, 095/096/097/098 Pump 1989-12/1994 (German Built)	1	TBA
310	119503A	Gasket, 095/096/097/098 Pump 1/1995-Up	1	TBA
311	119522	O-Ring, 095/096/097/098 Pump	1	TBA
326	119501	Gasket, 095/096/097/098 Filter	1	TBA
TECHNICAL MANUALS				
400	TM096-097	Technical Manual, 095/096/097/098	1	TBA
ELECTRICAL COMPONENTS				
410	119987A	PRNDL/Multi-Function Switch, 095/096/098 (7 Prong) (1 Bolt) (Cast # 095 919 823A)	1	TBA
410	119987B	PRNDL/Multi-Function Switch, 095/096/098 (7 Prong) (1 Bolt) (Cast # 095 919 823B)	1	TBA
410	119987	PRNDL/Multi-Function Switch, 095/096/098 (7 Prong) (1 Bolt) (Cast # 095 919 823F)	1	095-919-823-F
421	119952	Solenoid, 095/096/097/098 Shift (Takes 6 Per Transmission)	6	TBA
431	119954	Solenoid, 095/096 EPC/Lock-Up	1	TBA
NI	119958	Sensor, Output Speed, 095/096/01M/01N, 3-Terminal, 12" Harness, 99-05	1	01M-927-321-B
NI	119958A	Sensor, Output / Input Speed, 095/096/01M, 2-Terminal Rectangle Conn, No Harm, 90-06	1	095-927-321-A/C
NI	119959	Sensor, Input Speed, 095/096, 2-Terminal "D"-Shaped Conn, No Harm, 99-05	1	095-927-321-B
446	119957	Harness W/ Case Connector, 095/096, 1990-04 (12" Harness, Can Use 119957A)	1	096-927-365
446	119957A	Harness W/ Case Connector, 01M, 1995-Up (18" Harness Can Use For 1990-04 119957)	1	01M-927-365
446	119957B	Harness W/ Case Connector, 097/01N, 1990-Up	1	097-927-365-D
446	119957C	Harness W/ Case Connector, 098/01P, 1990-Up	1	098-927-365A
446	119957R	Harness W/ Case Connector, Universal 095/096/01M/097/01N/098/01P, 1990-Up (Rostra)	1	350-0070

AG4, 095, 096 (01M), 097 (01N), 098 (01P)

ILL#	Part#		QTY	REF#
MISCELLANEOUS COMPONENTS				
490.....	119490	Vent, 095/096/097/098 Case	1	TBA
491.....	119491	Vent, 095/096/097/098 Differential	1	TBA
PUMPS & PUMP COMPONENTS				
500.....	119912	Pump Complete, 095/096/097/098	1	TBA
500.....	119912A	Pump Complete, 01M, Cast # 01M-321-247	1	TBA
510.....	119916	Pump Body W/Gears, 095/096/097/098 (Cast # 095 321 247B)	1	TBA
510.....	119916B	Pump Body W/Gears, 095/096/097/098 (Cast # 01M 321 247)	1	TBA
520.....	119915A	Stator, 095/096/097/098 With 4 Large Holes & 1 Small Hole Inside Tube (No Check Valves On Flat Surface Of Stator)	1	TBA
520.....	119915B	Stator, 095/096/097/098 With 4 Large Holes & 1 Small Hole Inside Tube (With 1 Check Valve On Flat Surface Of Stator)	1	TBA
520.....	119915C	Stator, 095/096/097/098 With 10 Feed Holes Inside Tube	1	TBA
520.....	119915D	Stator, 095/096/097/098 With 4 Large Holes & 1 Small Hole Inside Tube (With 3 Check Valves On Flat Surface Of Stator)	1	TBA
DRUMS, HUBS & CENTER SUPPORTS				
550.....	119917A	Drum, 095/096/097/098 3-4 Clutch With Solid Shaft (5 Clutch) 26 Teeth Steels 1989-94	1	TBA
550.....	119917B	Drum, 095/096/097/098 3-4 Clutch With Solid Shaft (4 Clutch) 28 Teeth Steels 1989-94	1	TBA
550.....	119917C	Drum, 095/096/097/098 3-4 Clutch With Solid Shaft (5 Clutch) 28 Teeth Steels 1989-94	1	TBA
550.....	119917D	Drum, 095/096/097/098 3-4 Clutch With Hollow Shaft (4 Clutch) 28 Teeth Steels 1995-Up	1	TBA
550.....	119917E	Drum, 095/096/097/098 3-4 Clutch With Hollow Shaft (5 Clutch) 28 Teeth Steels 1995-Up	1	TBA
554.....	119920	Drum, 095/096/097/098 Forward With Shaft (5 Clutch) 1990-95 (Uses A Bellville Spring)	1	TBA
554.....	119920A	Drum, 095/096/097/098 Fwd With Shaft (5-Clu) 1990-95 (Does Not Use Bellville Spring)	1	TBA
554.....	119920B	Drum, 095/096/097/098 Forward Less Shaft 1996-Up	1	TBA
556.....	119918	Drum, 095/096/097/098 Reverse Clutch (5 Clutch)	1	TBA
570.....	119741A	Clutch Hub, 095/096/097/098 3-4 Clu Hub W/ Solid Shaft (Fits Shell W/ 24T Sun Gear)	1	TBA
570.....	119741B	Clutch Hub, 095/096/097/098 3-4 Clu Hub W/ Solid Shaft (Fits Shell W/ 27T Sun Gear)	1	TBA
574.....	119742A	Clutch Hub, 095/096/097/098 Forward Clutch	1	TBA
584.....	119821	Planet, 095/096/097/098 Rear (W/Out Sun Gear - Sun Gear Slides Out)	1	TBA
584.....	119821A	Planet, 095/096/097/098 Rear (W/ Sun Gear - Sun Gear Stays In The Planet)	1	TBA
614.....	119755A	Sun Gear, 095/096/097/098 Rear (21 Teeth)	1	TBA
622.....	119764A	Shell, 095/096/097/098 With Sun Gear (27 Teeth)	1	TBA
622.....	119764B	Shell, 095/096/097/098 With Sun Gear (27 Teeth) 1.890" OD Where Gear Rides	1	TBA
624.....	119743A	Hub, 095/096/097/098 Drive With Hollow Shaft (Fit Shell With 24T Sun Gear)	1	TBA
624.....	119743B	Hub, 095/096/097/098 Drive With Hollow Shaft(Fits Shell With 27T Sun Gear)	1	TBA
630.....	119826A	Center Support, 095/096/097/098 Rear	1	TBA
SPRAGS & ONE WAY CLUTCHES				
654.....	119727	Sprag, 095/096/097/098 Rear	1	TBA
GEARS, DIFFERENTIALS & DIFFERENTIAL COMPONENTS				
690.....	119824A	Gear, 095/096/097/098 Park (10 Teeth)	1	TBA
710.....	119809	Gear, 095/096/097/098 Transfer Drive With Ring Gear (62 Teeth)	1	TBA
710.....	119809A	Gear, 095/096/097/098 Transfer Drive With Ring Gear (71 Teeth)	1	TBA
710.....	119809B	Gear, 095/096/097/098 Transfer Drive With Ring Gear (72 Teeth)	1	TBA
710.....	119809C	Gear, 095/096/097/098 Transfer Drive With Ring Gear (75 Teeth)	1	TBA
710.....	119809D	Gear, 095/096/097/098 Transfer Drive With Ring Gear (45 Teeth) (.745" Thick)	1	TBA
710.....	119809E	Gear, 095/096/097/098 Transfer Drive With Ring Gear (45 Teeth) (.930" Thick)	1	TBA
712.....	119810	Gear, 095/096/097/098 Transfer Driven (75 Teeth)	1	TBA
712.....	119810A	Gear, 095/096/097/098 Transfer Driven (61 Teeth)	1	TBA
712.....	119810B	Gear, 095/096/097/098 Transfer Driven (51 Teeth)	1	TBA
712.....	119810C	Gear, 095/096/097/098 Transfer Driven (44 Teeth)(.828" Thick)	1	TBA
712.....	119810D	Gear, 095/096/097/098 Transfer Driven (73 Teeth)	1	TBA
712.....	119810E	Gear, 095/096/097/098 Transfer Driven (63 Teeth)(.750" Thick)(4.700" OD)	1	TBA
713.....	119641	Retainer, 095/096/097/098 (Aluminum) 4-Bolt	1	TBA
713.....	119641A	Retainer, 095/096/097/098 (Steel) 4-Bolt	1	TBA
715.....	119910	Differential W/Ring Gear, 095/096/097/098, 76T, No-Groove, 2-22-Roller Bearings	1	TBA
715.....	119910A	Differential W/Ring Gear, 095/096/097/098, 76T, No-Groove, 23/24-Roller Bearings	1	TBA
715.....	119910B	Differential W/Ring Gear, 095/096/097/098, 68T, 5-Groove, 2-24-Roller Bearings	1	TBA
715.....	119910C	Differential W/Ring Gear, 095/096/097/098, 76T, 2-Groove, 2-24-Roller Bearings	1	TBA
715.....	119910D	Differential W/Ring Gear, 095/096/097/098, 64T, 4-Groove, 2-24-Roller Bearings	1	TBA
715.....	119910E	Differential W/Ring Gear, 095/096/097/098, 74T, 3-Groove, 2-23-Roller Bearings	1	TBA
715.....	119910F	Differential W/Ring Gear, 095/096/097/098, 74T, 3-Groove, 23/24-Roller Bearings	1	TBA
716.....	119909	Differential Housing, 095/096/097/098 Less Ring Gear	1	TBA
720.....	119845	Ring Gear, 095/096/097/098 Differential (76 Teeth)	1	TBA
724.....	119642	Retainer, 095/096/097/098 Differential Bearing (Front)	1	TBA

AG4, 095, 096 (01M), 097 (01N), 098 (01P)

ILL#	Part#		QTY	REF#
725.....	119643	Retainer, 095/096/097/098 Differential Bearing (Rear)	1	TBA
730.....	119846	Pinion, 095/096/097/098 (18 Teeth)	1	TBA
735.....	119644	Retainer, 095/096/097/098 Pinion Bearing (Aluminum)	1	TBA
VALVE BODIES (DACCO VB#)				
740.....	VW-8902	Valve Body, 095/096, Kidney Shape Filter Inlet, 1990-94.....	1	TBA
740.....	VW-8903	Valve Body, 01M, Round Filter Inlet, 1-Aluminum Plug, W/Out Exhaust Hole 1994-96	1	TBA
740.....	VW-8904	Valve Body, 01M, Round Filter Inlet, 2-Aluminum Plugs, W/Out Exhaust Hole,	1	TBA
		Cast # 01M 325 105, 1997-98		
740.....	VW-8905	Valve Body, 01M, Round Filter Inlet, 2-Aluminum Plugs, W/ Exhaust Hole.....	1	TBA
		Cast# 01M 325 105F 1999-Up		
VALVE BODIES				
740.....	119754A	Valve Body, 095/096/097/098 (Cast # 283E) 1995-97.....	1	TBA
740.....	119754AA	Valve Body, 095/096/097/098 (Cast # 283E) 1998-Up.....	1	TBA
740.....	119754B	Valve Body, 095/096/097/098 (Cast # 283F) 1995-97.....	1	TBA
740.....	119754BA	Valve Body, 095/096/097/098 (Cast # 283F) 1998-Up.....	1	TBA
740.....	119754C	Valve Body, 095/096/097/098 (Cast # 283A) 1995-97.....	1	TBA
740.....	119754CA	Valve Body, 095/096/097/098 (Cast # 283A) 1998-Up.....	1	TBA
740.....	119754D	Valve Body, 095/096/097/098 (Cast # 283) 1995-97.....	1	TBA
740.....	119754DA	Valve Body, 095/096/097/098 (Cast # 283) 1998-Up.....	1	TBA
VALVE BODY COMPONENTS				
741.....	119940-01K	Kit, TCC Boost Valve, Sleeve & Spring, 01M, 01P.....	1	Sonnax
741.....	119940-03K	Kit, Main Pressure Regulator, 01M, 01P, Requires: F-119940-TL3 & VB-FIX.....	1	Sonnax
741.....	119940-04K	Valve, Oversized TCC Regulator, 01M, 01P, Requires: 119940-TL4	1	Sonnax
741.....	119940-05K	Valve Kit, Boost Regulator, 01M, 01P, Requires: 119940-TL5 & VB-FIX.....	1	Sonnax
741.....	119940-06K	Valve Kit, Solenoid Regulator, 096, 098, 01M, 01P, Requires: 119940-TL6 & VB-FIX.....	1	Sonnax
CASES, COVERS & PANS				
758.....	119704A	Cover, 095/096/097/098 Differential	1	TBA
759.....	119705A	Cover, 095/096/097/098 Rear	1	TBA
760.....	119701A	Case, 095/096/097/098 (Cast # 096 321 105AE).....	1	TBA
760.....	119701AA	Case, 095/096 (01M) (Cast # 105E).....	1	TBA
760.....	119701AB	Case, 095/096 (01M) (Cast # 105F).....	1	TBA
765.....	119801	Pan, 095/096/097/098 Bottom With Drain Plug	1	TBA
765.....	119801A	Pan, 095/096/097/098 Bottom No Drain Plug	1	TBA
774.....	119731	Housing, 095/096/097/098 Driven Speed-O Gear (Black Plastic) (3 Blade Connector).....	1	TBA
796.....	119081	Nut, 095/096/097/098 For Driven Gear	1	TBA
838.....	119931	Axle Flange, 095/096/097/098.....	1	TBA
NI.....	119839	Flange Shaft Cover (Bonded) 096/01M/01N	2	020-409-289B
NI.....	119839A	Flange Shaft Cover (Bonded) 098/01P/099	2	002-517-289A
NI.....	119839A	Pinion Shaft Cover (Bonded) 097/01N	1	097-321-073A
842.....	119621	Bracket, 095/096/097/098 Holds Driven Speed-O Housing On	1	TBA
SNAP RINGS, PISTONS & MISCELLANEOUS				
852.....	119141	Cushion, 095/096/097/098 Intermediate Clutch	1	TBA
857.....	119142	Cushion, 095/096/097/098 Low/Reverse Clutch	1	TBA
892.....	119601	Snap Ring, 095/096/097/098 Holds Reverse Pressure Plate In Drum (.063")	1	TBA
892.....	119601A	Snap Ring, 095/096/097/098 Holds Reverse Pressure Plate In Drum (.071")	1	TBA
892.....	119601B	Snap Ring, 095/096/097/098 Holds Reverse Pressure Plate In Drum (.079")	1	TBA
892.....	119601C	Snap Ring, 095/096/097/098 Holds Reverse Pressure Plate In Drum (.087")	1	TBA
958.....	119632	Tube, 095/096/097/098 Intermediate Support.....	1	TBA
960.....	119827	Piston, 095/096/097/098 3-4 Clutch (K3) (Bonded) 1990-94	1	TBA
960.....	119827A	Piston, 095/096/097/098 3-4 Clutch (K3) (Bonded) 1995-Up.....	1	TBA
962.....	119823	Piston, 095/096/097/098 Intermediate Clutch (B2)(Bonded) 1990-Up	1	TBA
964.....	119825	Piston, 095/096/097/098 Forward Clutch (K1)(Bonded) 1990-94	1	TBA
964.....	119825A	Piston, 095/096/097/098 Forward Clutch (K1)(Bonded) 1995-Up.....	1	TBA
966.....	119824	Piston, 095/096/097/098 Reverse Clutch (Bonded) 1989-Up	1	TBA
967.....	119829	Piston, 095/096/097/098 Low/Reverse Clutch (B1)(Bonded) 1990-Up	1	TBA
970.....	119970	Beveled Spring, 095/096/097/098 3-4 Clutch Return	1	TBA
971.....	119971	Spring, 095/096/097/098 3-4 Clutch Return	1	TBA
972.....	119976	Retainer W/Springs, 095/096/097/098 Intermediate Clutch	1	TBA
974.....	119976A	Retainer W/Springs, 095/096/097/098 Forward Clutch	1	TBA
976.....	119976B	Retainer W/Springs, 095/096/097/098 Reverse Clutch	1	TBA
977.....	119975	Diaphragm Spring, 095/096/097/098 Axle Flange.....	1	TBA
979.....	119979	Spring, 095/096/097/098 Axle Flange	1	TBA
980.....	119980	Retainer, 095/096/097/098 3-4 Clutch Spring (Bottom).....	1	TBA

AG4, 095, 096 (01M), 097 (01N), 098 (01P)

ILL#	Part#		QTY	REF#
981.....	119981	Retainer, 095/096/097/098 3-4 Clutch Spring (Top)	1	TBA
981.....	119828	Retainer, 095/096/097/098 3-4 Clutch Spring (Bonded) 1995-Up.....	1	TBA
984.....	119984	Diaphragm Spring, 095/096/097/098 Forward Clutch	1	TBA
984.....	119826	Retainer, 095/096/097/098 Forward Clutch Spring (Bonded) 1995-Up.....	1	TBA
988.....	119988	Cooler, 095/096/097/098 External (Mounts To Case).....	1	TBA
989.....	119989	Retainer, 095/096/097/098 Axle Spring	1	TBA
991.....	119631	Linkage Assembly, 095/096/097/098 Internal.....	1	TBA
995.....	119995	Park Pawl Assembly, 095/096/097/098	1	TBA
998.....	119814-01K.....	Remote Cooler Adapter, 096/097/098 (Replaces Oil Cooler On Top Of Transmission	1	119814-01K
.....	For Use With External Cooler (Sonnax)

VW 003

ILL#	Part#		QTY	REF#
OVERHAUL KITS				
NI.....	K39900.....	Overhaul Kit, 003 1969-75.....	1.....	N/A
MASTER L/STEEL KITS				
NI.....	DK3900S.....	Master L/Steels Kit, 003 1969-75.....	1.....	N/A
MASTER W/STEELS KITS				
NI.....	DK3900.....	Master W/Steels Kit, 003 1969-75.....	1.....	N/A
FILTERS				
010.....	39661.....	Filter, 003 1968-76.....	1.....	003-325-421
011.....	FK39661.....	Filter Kit, 003 1968-76.....	1.....	TBA
BANDS				
022.....	39313.....	Band, 003 2nd Gear.....	1.....	003-323-461
024.....	39362.....	Band, 003 Low/Reverse.....	1.....	003-323-411
BUSHINGS				
030.....	K39905.....	Bushing Kit, 003.....	1.....	TBA
031.....	79002.....	Bushing, 003 Converter Hub (Use 79002).....	1.....	003-323-611
032.....	39001.....	Bushing, 003 Converter Reactor (Also Fits Forward Clutch Hub).....	1-3.....	003-519-074
035.....	39002.....	Bushing, 003 Pump Drive Gear (Also Fits Converter Hub).....	1-2.....	003-323-611
037.....	39003.....	Bushing, 003 Stator.....	1.....	003-321-254
046.....	39005.....	Bushing, 003 Direct Drum.....	1.....	003-323-115
050.....	39001.....	Bushing, 003 Forward Clutch Hub (Use 65032).....	2.....	003-519-074
052.....	79009.....	Bushing, 003 Sun Gear.....	1.....	003-323-289
060.....	39007.....	Bushing, 003 Rear Ring Gear.....	1.....	003-323-373
METAL CLAD SEALS				
070.....	39197.....	Seal, 003 Front 1969-75.....	1.....	003-419-089D
075.....	39194.....	Seal, 003 Governor Shaft 1969-75.....	1.....	003-507-125A
075.....	39195.....	Seal, 003 Final Drive 0969-75.....	2.....	003-507-269A
075.....	39196.....	Seal, 003 Pinion 1965-75.....	1.....	010-409-085D
FRICTIONS				
106.....	39264.....	Friction, 003 Direct Clutch (.091").....	2-3.....	TBA
106.....	39266.....	Friction, 003 Forward Clutch (.060").....	3.....	TBA
119.....	KF39.....	Friction Module, 003.....	1.....	TBA
STEELS				
126.....	39265.....	Steel, 003 Forward & Direct Clutch (.079") 1969-75.....	4-5.....	003-323-139
PRESSURE PLATES				
146.....	39131.....	Pressure Plate, 003 Forward & Direct Clutch (.062").....	1.....	TBA
146.....	39131A.....	Pressure Plate, 003 Forward & Direct Clutch (.076").....	1.....	TBA
146.....	39131B.....	Pressure Plate, 003 Forward & Direct Clutch (.090").....	1.....	TBA
146.....	39131C.....	Pressure Plate, 003 Forward & Direct Clutch (.104").....	1.....	TBA
MODULATORS				
160.....	39830.....	Modulator, 003 1969-75.....	1.....	003-325-391A
SEALING RINGS				
175.....	K39296.....	Ring Kit, 003.....	1.....	TBA
181.....	39296.....	Ring, 003 Forward & Direct Clutch.....	4.....	TBA
WASHERS & BEARINGS				
211.....	39421.....	Washer, 003 Pump To Direct Drum (2 Tabs).....	1.....	TBA
229.....	39422.....	Washer, 003 Pump To Forward Drum (3 Tabs).....	1.....	TBA
230.....	39423.....	Washer, 003 Pump To Forward Drum (2 Tabs).....	1.....	TBA
232.....	39424.....	Washer, 003 Forward Drum To Forward Hub.....	1.....	TBA
247.....	39425.....	Washer, 003 Planet (Front).....	1.....	TBA
251.....	39426.....	Washer, 003 Planet (Rear).....	1.....	TBA
GASKETS & RUBBER COMPONENTS				
300.....	13800.....	Gasket, 003 Bottom Pan.....	1.....	003-321-371
304.....	13880.....	Gasket, 003 Plate To Differential Housing.....	1.....	003-507-275
NI.....	13857.....	O-Ring, Governor Cover & Servo Cover.....	2.....	003-325-381
371.....	3291.....	O-Ring, 003 Filler Tube.....	1.....	6264902

ILL#	Part#		QTY	REF#
TECHNICAL MANUALS				
400.....	TMVW003/010	Technical Manual, 003.....	1	TBA
HARD PARTS				
520.....	39915	Pump Assembly, 003	1	003-321-241
530.....	39201	Pump Gear Set, 003.....	1	003-321-263
544.....	39915P	Pump Plate, 003	1	003-321-279
554.....	39924	Drum, 003 Forward Clutch	1	TBA
555.....	39920	Drum, 003 Direct & Reverse Clutch (Band Drum).....	1	TBA
584.....	39938	Planet Assembly W/ Washer, 003.....	1	TBA
584.....	39938A.....	Planet Assembly W/ Bearing, 003	1	TBA
654.....	39724	Sprag, 003	1	TBA
680.....	39988	Governor, 003, W/ Slot Drive, 1969-74.....	1	TBA
680.....	39988A.....	Governor, 003, W/ Square Drive Pin, 1970-76	1	TBA
680.....	39988B.....	Governor, 003, W/ Brass Gear Drive, 1970-76.....	1	TBA

010 DIFFERENTIAL

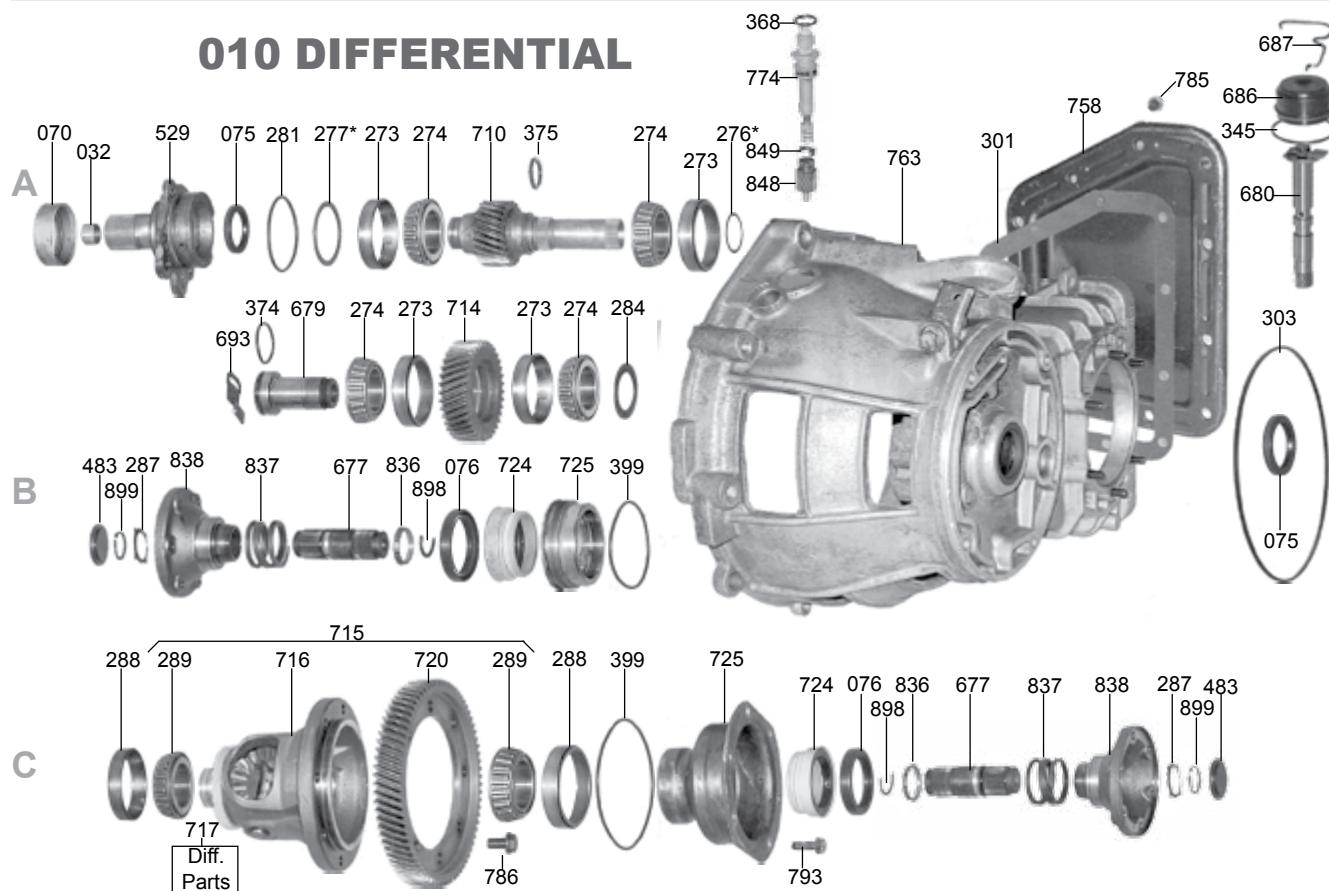

087 DIFFERENTIAL

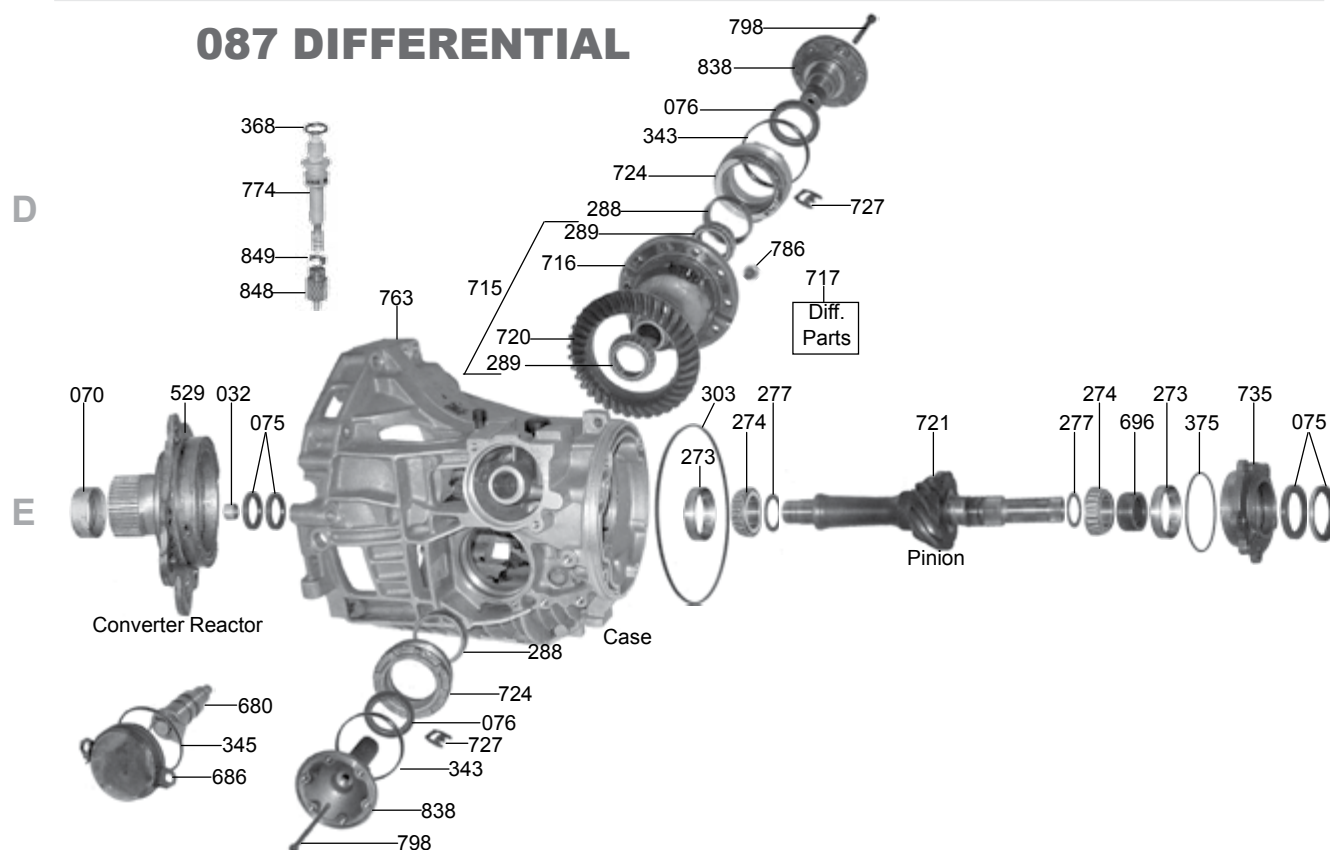

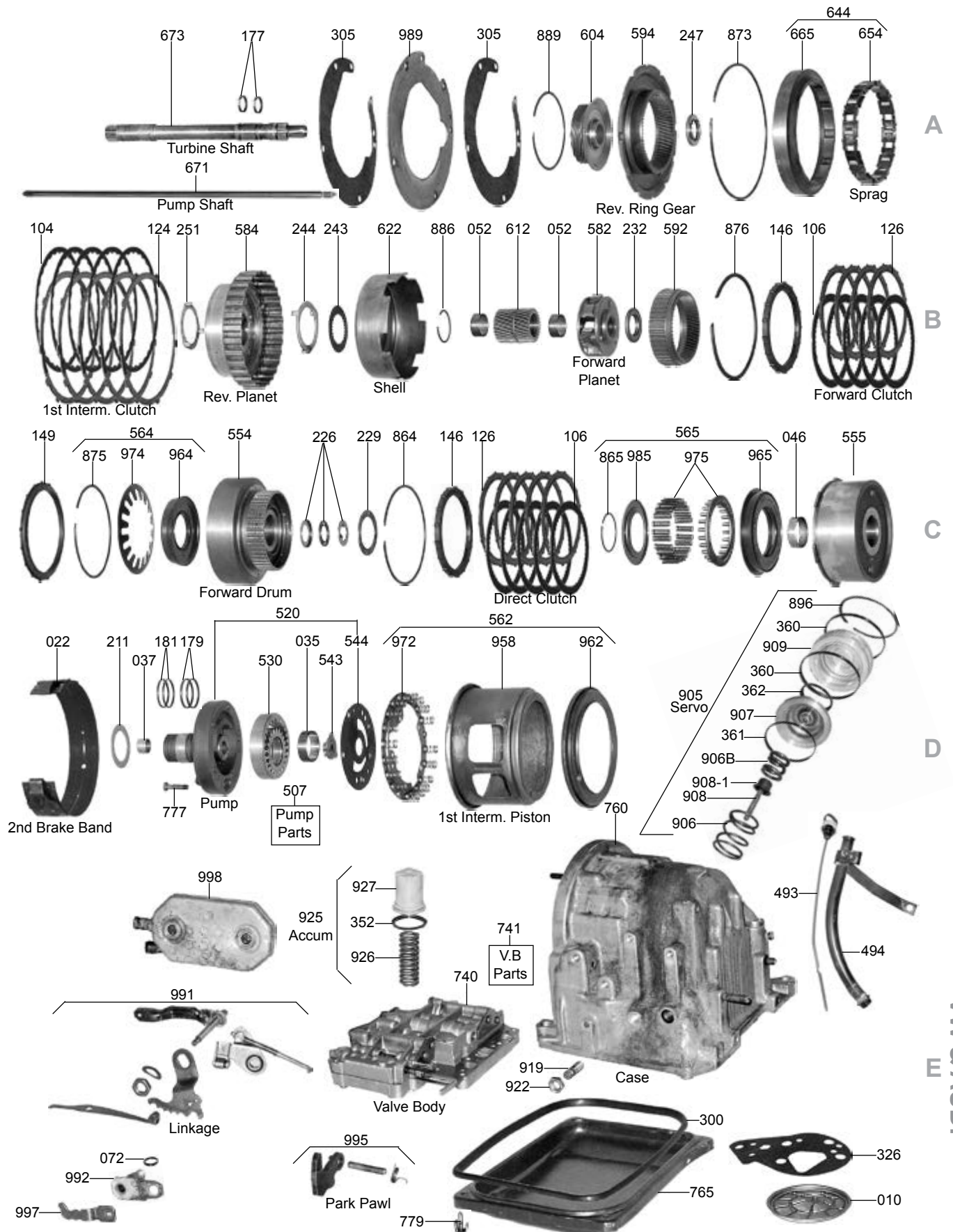

VW 010, 087, 089, 090

ILL#	Part#		QTY	REF#
OVERHAUL KITS				
NI.....	K79900.....	Overhaul Kit, 010/087/089/090 (Without Differential/Final Drive Seals) 1975-Up	1.....	N/A
NI.....	K79900A.....	Overhaul Kit, 010 (With Differential/Final Drive Seals) 1975-Up	1.....	N/A
NI.....	K79900B.....	Overhaul Kit, 087/89/090 (With Differential/Final Drive Seals) 1975-Up	1.....	N/A
SUB KITS & PISTON KITS				
NI.....	K79900B-1S.....	Vanagon, Sub Kit, 090, Use This Kit With K79900B, DK7900BS, DK7900B Kit	1.....	N/A
NI.....	K79971.....	Bonded Pistons, 1975-82 (Includes 1ea: 79974, 79970 & 79973)	1.....	N/A
NI.....	K79971A.....	Bonded Pistons, 1983-Up (Includes 1ea: 79974, 79970A & 79973)	1.....	N/A
MASTER L/STEEL KITS				
NI.....	DK7900S.....	Master L/Steels Kit, 010/089/(Without Differential/Final Drive Seals) 1975-Up	1.....	N/A
NI.....	DK7900AS.....	Master L/Steels Kit, 010 (With Differential/Final Drive Seals) 1975-Up	1.....	N/A
NI.....	DK7900BS.....	Master L/Steels Kit, 087/089/*090 (With Differential/Final Drive Seals) 1975-Up	1.....	N/A
		*For Vanagon 090, Use K79900B-1S Subkit.....		
NI.....	K79900CS.....	Master L/Steels Kit, 087(W/ Diff/Final Drive Seals) Audi/Quantum/Porsche 924/944, 84-Up	1.....	N/A
MASTER W/STEELS KITS				
NI.....	DK7900S.....	Master W/Steels Kit, 010/089/(Without Differential/Final Drive Seals) 1975-Up	1.....	N/A
NI.....	DK7900AS.....	Master W/Steels Kit, 010 (With Differential/Final Drive Seals) 1975-Up	1.....	N/A
NI.....	DK7900BS.....	Master W/Steels Kit, 087/089/*090 (With Differential/Final Drive Seals) 1975-Up	1.....	N/A
		*For Vanagon 090, Use K79900B-1S Subkit.....		
NI.....	K79900CS.....	Master W/Steels Kit, 087(W/ Diff/Final Drive Seals) Audi/Quantum/Porsche 924/944, 84-Up	1.....	N/A
FILTERS				
010.....	79710.....	Filter 010/089 Rectangular 1975-76	1.....	010-325-421
010.....	79710A.....	Filter, 010/087/089/090 Round 1977-Up	1.....	010-325-421A
BANDS				
022.....	79700.....	Band, 010/087/089/090 1975-Up (Except 1983-Up Audi 5000)	1.....	010-323-461C
BUSHINGS				
030.....	K79905.....	Bushing Kit, 010/087/089/090 1975-Up.....	1.....	TBA
031.....	79002.....	Bushing, 010/087/089/090 Converter Hub	1.....	003-323-611
032.....	39003.....	Bushing, 010/087/089/090 Converter Reactor	1.....	003-519-074
035.....	79002.....	Bushing, 010/087/089/090 Inner Pump Gear (Also Fits Converter Hub)	1-2.....	003-323-611
037.....	39004.....	Bushing, 010/087/089/090 Pump Stator.....	1.....	003-321-254
046.....	79005.....	Bushing, 010/087/089/090 Direct Drum	1.....	010-323-115
052.....	79009.....	Bushing, 010/087/089/090 Sun Gear	2.....	010-323-217A
METAL CLAD SEALS				
070.....	79303.....	Seal, 010/087/089 Front (Except 090) 1975-Up.....	1.....	010-409-568
070.....	39197.....	Seal, 090 Front 1977-Up	1.....	003-519-089D
075.....	79301.....	Seal, 010 Pinion Shaft (Rear) 1975-Up.....	1.....	010-409-529C
075.....	79305A.....	Seal, 087 Pinion Shaft (Front) 1979-Up	2.....	087-409-085A
075.....	79310.....	Seal, 089 Pinion Shaft (Front) 1976-Up	1.....	089-409-085B
075.....	79307.....	Seal, 089 Pinion Shaft (Rear) 1975-79.....	2.....	089-409-529A
075.....	39196.....	Seal, 010/090 Pinion Shaft (Front) 1975-4-Up	1.....	010-409-085D
075.....	79307A.....	Seal, 087 Pinion Shaft (Rear) 1979-Up.....	2.....	087-409-529A
076.....	79304.....	Seal, 010 Axle (Both Sides) 1979-83.....	2.....	010-409-085
076.....	79309.....	Seal, 010 Axle (Both Sides) 1984-Up.....	2.....	020-301-189M
076.....	79308.....	Seal, 087/089/090 Axle (Both Sides) 1975-Up.....	2.....	018-409-399
079.....	79302.....	Seal, 087 Turbine Shaft 1984-Up	1.....	087-323-559
080.....	79306.....	Seal, 087/089 Governor Shaft 1977-Up	1.....	087-409-133A
FRICTIONS				
104.....	79106.....	Friction, 010/087/089/090 1st Intermediate Clutch (.061") 1975-Up	4-5.....	010-323-231
106.....	79103.....	Friction, 010/087/089/090 Forward & Direct Clutch (.090") (4.75" OD) 1975-Up	3-5.....	010-323-141C
106.....	79103A.....	Friction, 010/087/089/090 Direct Clutch (.090") (5.00" OD) 1983-Up.....	5.....	087-323-141A
106.....	79105.....	Friction, 010/087/089/090 Fwd Clu (.061") (4.75" OD)(With 1 Tooth Missing) 1975-Up.....	3-5.....	010-323-241C
106.....	79105D.....	Friction, 010 (Diesel) Forward Clu (.061") (With 2 Teeth Missing) 1978-88.....	5.....	010-223-241B
119.....	K79F.....	Friction Module, 010/087/089/090 1975-Up (Except 1983-Up Audi 5000).....	1.....	TBA
119.....	K79AF.....	Friction Module, 087 Audi 5000 1983-Up	1.....	TBA
STEELS				
124.....	79104.....	Steel, 010/087/089/090 1st Intermediate Clutch (.079") 1975-Up.....	4-5.....	010-323-227A
126.....	79100.....	Steel, 010/087/089/090 Forward & Direct Clutch (.079") (17 Teeth) 1975-Up.....	5-9.....	010-323-139
126.....	79100A.....	Steel, 087 Direct Clutch (.079") (53 Teeth) 1983-Up	5.....	087-323-139

ILL#	Part#		QTY	REF#
139.....	K79S	Steel Module, 010/087/089/090 1975-Up (Except 1983-Up Audi 5000).....	1.....	TBA
139.....	K79AS.....	Steel Module, 087 Audi 5000 1983-Up.....	1.....	TBA
PRESSURE PLATES				
146.....	79267	Press Plate, 010/087/089/090 Fwd & Dir (Top) 1975-Up (Except 1983-Up Audi 5000)	1-2.....	TBA
146.....	79264	Pressure Plate, 087 Direct (Top) Audi 5000 1983-Up.....	1.....	TBA
149.....	79263	Pressure Plate, 010/087/089/090 Forward Clutch (Bottom) 1975-Up	1.....	TBA
SEALING RINGS				
175.....	K79901.....	Ring Kit, 010/087/089/090 1975-Up	1.....	TBA
177.....	79220	Ring, 010/087/089/090 Input Shaft 1975-Up.....	2.....	010-323-557A
179.....	79230	Ring, 010/087/089/090 Direct Clutch 1975-Up.....	2.....	010-321-261
181.....	39296	Ring, 010/087/089/090 Forward Clutch 1975-Up.....	2.....	003-321-261
WASHERS & BEARINGS				
211.....	39564	Washer, 010/087/089/090 Pump To Direct Drum (Metal).....	1.....	003-321-285
211.....	39564A.....	Washer, 010/087/089/090 Pump To Direct Drum (Plastic)	1.....	TBA
226.....	39566	Washer, 010/087/089/090 Forward Drum To Pump	1.....	003-323-165
226.....	39566A.....	Bearing, 010/087/089/090 Forward Drum To Pump	1.....	TBA
229.....	39565	Washer, 010/087/089/090 Forward Drum To Direct Drum (3 Metal, 3 Tab).....	1.....	003-323-161A
229.....	39565A.....	Washer, 010/087/089/090 Forward Drum To Direct Drum (Plastic).....	1.....	003-323-161AP
232.....	79570	Bearing, 010/087/089/090 Forward Drum To Planet	1.....	TBA
243.....	79568	Washer, 010/087/089/090 Drive Shell (29 Teeth Sun Gear).....	1.....	010-323-291A
243.....	79568A.....	Washer, 010/087/089/090 Drive Shell (26 Teeth Sun Gear).....	1.....	TBA
243.....	79568B.....	Washer, 010/087/089/090 Drive Shell (28 Teeth Sun Gear).....	1.....	TBA
244.....	79571	Washer, 010/087/089/090 Rear Planet To Shell (3 Tab)	1.....	TBA
247.....	79573	Bearing, 010/087/089/090 Annulus Gear To Sun Gear	1.....	TBA
251.....	79572	Washer, 010/087/087/090 Annulus Gear To Rear Planet (Metal, 4 Tab)	1.....	010-323-291A
251.....	79572A.....	Washer, 010/087/089/090 Annulus Gear To Rear Planet (Plastic).....	1.....	TBA
273.....	79574	Cup Race, 087 Pinion (Rear)	1.....	M88010
273.....	79574A.....	Cup Race, 087/089 Pinion (Front For 087) Front & Rear For 089	1-2.....	M86610
273.....	79574B.....	Cup Race, 010 Pinion & Idler (Both Sides)	4.....	LM67010
274.....	79575	Bearing, 087 Pinion (Rear).....	1.....	M88048
274.....	79575A.....	Bearing, 087/089 Pinion (Front For 087) Front & Rear For 089.....	1-2.....	M86649
274.....	79575B.....	Bearing, 010 Pinion & Idler (Both Sides)	4.....	LM67048
288.....	79576	Cup Race, 087 Differential Carrier (Both Sides).....	2.....	LM300811
288.....	79576A.....	Cup Race, 010/089 Differential Carrier (Both Sides).....	2.....	LM29710
289.....	79577	Bearing, 087 Differential Carrier (Both Sides)	2.....	LM300849
289.....	79577A.....	Bearing, 010/089 Differential Carrier (Both Sides)	2.....	LM29749
GASKETS & RUBBER COMPONENTS				
300.....	79500	Gasket, 010/087/089/090 Bottom Pan (Rubber).....	1.....	010-321-371B
303.....	13620	Lathe Cut Seal, 010/087/089/090 Differential housing To Case	1.....	010-409-549B
305.....	79501	Gasket, 010/087/089/090 Transfer Plate To Differential Plate.....	2.....	TBA
326.....	79505	Gasket, 010/087/089/090 Round Filter To Valve Body.....	1.....	TBA
371.....	3291	Gasket, 010/087/089/090 Filler Tube	1.....	6264902
TECHNICAL MANUALS				
400.....	TMVW003-010.....	Technical Manual, 010/087/089/090.....	1.....	83-003010TM
PUMPS & PUMP COMPONENTS				
520.....	79915	Stator W/Gears, 010/087/089/090 (Uses A Washer #226).....	1.....	010-321-241A
520.....	79915A.....	Stator W/Gears, 010/087/089/090 (Uses A Bearing #226).....	1.....	TBA
529.....	79529	Converter Reactor, 087 (Need Cast #).....	1.....	TBA
529.....	79529A.....	Converter Reactor, 089 (Need Cast #).....	1.....	TBA
529.....	79529B.....	Converter Reactor, 010	1.....	TBA
543.....	39915D.....	Flange, 010/087/089/090 Inner Pump Gear Drive.....	1.....	TBA
544.....	79915P.....	Pump Plate, 010/087/089/090	1.....	010-321-279
DRUMS				
554.....	79924	Drum, 010/087/089/090 Forward (3 Clutch) Washer Type	1.....	010-323-205A
554.....	79924A.....	Drum, 010/087/089/090 Forward (4 Clutch) Washer Type	1.....	010-323-205E
554.....	79924B.....	Drum, 010/087/089/090 Forward (5 Clutch) Bearing Type (Uses Flat Return Spring)	1.....	TBA
554.....	79924C.....	Drum, 010/087/089/090 Forward (3 Clutch) Bearing Type.....	1.....	TBA
554.....	79924D.....	Drum, 010/087/089/090 Forward (4 Clutch) Bearing Type.....	1.....	TBA
554.....	79924E.....	Drum, 087 Forward (5 Clutch) Bearing Type (Uses Wire Return Spring).....	1.....	TBA
555.....	79920	Drum, 010/087/089/090 Direct (4 Clutch) 17 Teeth Steels	1.....	010-323-105B
555.....	79920A.....	Drum, 010/087/089/090 Direct (3 Clutch).....	1.....	010-323-105E
555.....	79920B.....	Drum, 010/087/089/090 Direct (4 Clutch) 51 Teeth Steels	1.....	TBA

VW 010, 087, 089, 090

ILL#	Part#		QTY	REF#
555.....	79920C.....	Drum, 087 Direct (5 Clutch) (5.00" OD Frictions) 1983-Up	1	TBA
PLANETS, RING GEARS, SUN GEARS & SHELLS				
582.....	79938.....	Planet, 010/087/089/090 Front (Uses 29T Sun Gear)	1	TBA
582.....	79938A.....	Planet, 010/087/089/090 Front (3 Gear) (Uses 26T Sun Gear)	1	TBA
582.....	79938B.....	Planet, 010/087/089/090 Front (3 Gear) (Uses 28T Sun Gear)	1	090-323-805
584.....	79939.....	Planet, 010/087/089/090 Rear (Uses 29T Sun Gear)	1	TBA
584.....	79939A.....	Planet, 010/087/089/090 Rear (Uses 26T Sun Gear)	1	TBA
584.....	79939B.....	Planet, 010/087/089/090 Rear (Uses 28T Sun Gear)	1	TBA
592.....	79930.....	Ring Gear, 010/087/089/090 Front Planet With Hub (Uses 29 Teeth Sun Gear)	1	TBA
592.....	79930A.....	Ring Gear, 010/087/089/090 Front Planet With Hub (Uses 26 Teeth Sun Gear)	1	TBA
592.....	79930B.....	Ring Gear, 010/087/089/090 Front Planet With Hub (Uses 28 Teeth Sun Gear)	1	TBA
594.....	79940.....	Ring Gear With Hub, 010/087/089/090 Rear Annulus (Uses 29 Teeth Sun Gear)	1	TBA
594.....	79940A.....	Ring Gear With Hub, 010/087/089/090 Rear Annulus (Uses 26 Teeth Sun Gear)	1	TBA
594.....	79940C.....	Ring Gear With Hub, 010/087/089/090 Rear Annulus (Uses 28 Teeth Sun Gear)	1	TBA
612.....	79933.....	Sun Gear, 010/087/089/090 (29 Teeth)	1	010-323-285
612.....	79933A.....	Sun Gear, 010/087/089/090 (26 Teeth)	1	010-323-285E
612.....	79933B.....	Sun Gear, 010/087/089/090 (28 Teeth)	1	TBA
622.....	79936.....	Shell, 010/087/089/090 Driving (Uses 29 Teeth Sun Gear)	1	TBA
622.....	79936A.....	Shell, 010/087/089/090 Driving (Uses 26 Teeth Sun Gear)	1	TBA
622.....	79936B.....	Shell, 010/087/089/090 Driving (Uses 28 Teeth Sun Gear 5-5/8" Diameter Dir Drum)	1	TBA
622.....	79936C.....	Shell, 087 Driving (Uses 28 Teeth Sun Gear 5-7/8" Diameter Dir Drum) 1983-Up	1	TBA
SPRAGS & ONE WAY CLUTCHES				
644.....	79728.....	Sprag Assembly W/Race, 010/087/089/090 (With Lugs On OD Of Outer Race)	1	TBA
644.....	79728A.....	Sprag Assembly W/Race, 010/087/089/090 (No Lugs On OD Of Outer Race)	1	TBA
654.....	79727.....	Sprag, 010/087/089/090	1	TBA
665.....	79730.....	Outer Race, 010/087/089/090 Sprag (With Lugs On OD)	1	TBA
665.....	79730A.....	Outer Race, 010/087/089/090 Sprag (No Lugs On OD)	1	TBA
SHAFTS & GOVERNORS				
671.....	79956.....	Pump Shaft, 010 Oil Pump (13 7/8")	1	TBA
671.....	79956A.....	Pump Shaft, 087 Oil Pump (20 1/8")	1	TBA
671.....	79956B.....	Pump Shaft, 089 Oil Pump (19 5/16")	1	TBA
671.....	79956C.....	Pump Shaft, 090 Oil Pump (21")	1	TBA
671.....	79956CA.....	Pump Shaft, 087/089 Oil Pump (18 7/8")	1	TBA
673.....	79953.....	Turbine Shaft, 010 Main (10 3/8")	1	TBA
673.....	79953A.....	Turbine Shaft, 089 Main (15 3/4")	1	TBA
673.....	79953B.....	Turbine Shaft, 087 Main (16 5/8")	1	TBA
673.....	79953C.....	Turbine Shaft, 090 Main (18")	1	TBA
673.....	79953D.....	Turbine Shaft, 087 (16 5/8") With Seal .590" ID	1	TBA
673.....	79953CA.....	Turbine Shaft, 087/089 Main (15 3/8")	1	TBA
680.....	79988.....	Governor Assembly, 010 (18 Teeth) Aluminum Body 1975-82	1	TBA
680.....	79988D.....	Governor Assembly, 010 (18 Teeth) Late-Steel 1983-Up	1	090-035-041
680.....	79988A.....	Governor Assembly, 089 (13 Teeth) Aluminum Body 1975-82	1	089-325-041B
680.....	79988F.....	Governor Assembly, 089 (13 Teeth) Late-Steel 1983-Up	1	TBA
680.....	79988C.....	Governor Assembly, 087 (16 Teeth) Aluminum Body 1975-82	1	087-325-041
680.....	79988E.....	Governor Assembly, 087 (16 Teeth) Late-Steel 1983-Up	1	TBA
VALVE BODIES (DACCO VB#)				
740.....	VW-8901.....	Valve Body, 010, 1976-Up	1	TBA
VALVE BODIES				
740.....	79990A.....	Valve Body, 010/087/089/090 (Cast # 283D)	1	TBA
740.....	79990B.....	Valve Body, 010/087/089/090 (Cast # 283E)	1	TBA
740.....	79990C.....	Valve Body, 010/087/089/090 (Cast # 283F)	1	TBA
740.....	79990D.....	Valve Body, 010/087/089/090 (Cast # 283G)	1	TBA
740.....	79990.....	Valve Body, 010/087/089/090 (Cast # 283J)	1	TBA
CASES & PANS				
760.....	79800.....	Case, 010/087/089/090 (Cast # 105)	1	TBA
760.....	79800B.....	Case, 010/087/089/090 (Cast # 105B)	1	TBA
760.....	79800D.....	Case, 010/087/089/090 (Cast # 105D)	1	TBA
765.....	79801.....	Pan, 010/087/089/090 (With Filler Tube In Case)	1	TBA
765.....	79802.....	Pan, 010/087/089/090 (With Filler Tube In Pan)	1	TBA
SERVOs, ACCUMULATORS & MISCELLANEOUS				
905.....	K79997.....	Servo Assembly, 010/087/089/090	1	TBA
906.....	79621.....	Spring, 010/087/089/090 Servo	1	TBA

ILL#	Part#		QTY	REF#
907.....	79997	Piston, 010/087/089/090 Servo	1	TBA
909.....	79622	Cover, 010/087/089/090 Servo	1	TBA
919.....	79081	Bolt, 010/087/089/090 Band Adjusting	1	TBA
922.....	79082	Nut, 010/087/089/090 Band Adjusting	1	TBA
925.....	K79998	Accumulator Assembly, 010/087/089/090	1	TBA
926.....	79621A	Spring, 010/087/089/090 Accumulator	1	TBA
927.....	79998	Piston, 010/087/089/090 Accumulator (Late Type) Molded Rubber	1	003-325-405C
927.....	79998A	Piston, 010/087/089/090 Accumulator (Early Type) With Lip Seal	1	TBA
958.....	79622	Tube, 010/087/089/090 1st Intermediate Clutch Apply	1	TBA
962.....	79970	Piston, 010/087/089/090 1st/Rev Clu (W/Out Check Ball) Molded Rubber, 75-82	1	010-323-479A
962.....	79970A	Piston, 010/087/089/090 1st/Rev Clu (With Check Ball) Molded Rubber, 1983-Up	1	010-323-512A
964.....	79973	Piston, 010/087/089/090 Forward Clutch (Molded Rubber)	1	010-323-217A
965.....	79974	Piston, 010/087/089/090 Direct Clutch (Molded Rubber)	1	010-323-121B
972.....	79972	Retainer W/Spring, 010/087/089/090 Intermediate Clutch	1	TBA
974.....	79598	Spring, 010/087/089/090 Diaphragm Forward Clutch (8 Lug)	1	010-323-229D
974.....	79598A	Spring, 010/087/089/090 Diaphragm Forward Clutch (16 Lug)	1	010-323-229C
974.....	79598B	Spring, 087 Diaphragm Forward Clutch (Wire Type)	1	TBA
975.....	79975	Spring, 010/087/089/090 Direct Clutch Return	1	TBA
985.....	79599	Retainer W/Spring, 010/087/089/090 1st & Intermediate(Low/Rev)	1	TBA
989.....	79989	Plate, 010/087/089/090 Intermediate	1	TBA
991.....	79991	Linkage Assembly, 010/087/089/090	1	TBA
995.....	79995	Park Pawl Assembly, 010/087/089/090	1	TBA
998.....	79998	Cooler, 010/087/089/090 External (Cast #)	1	TBA

01J

ILL#	Part#		QTY	REF#
OVERHAUL KITS				
NI.....	K130900.....	Overhaul Kit, 01J (W/ Rev Brake Piston) 2002-Up.....	1.....	N/A
NI.....	K130900X.....	Overhaul Kit, 01J (W/Out Rev Brake Piston) 2002-Up.....	1.....	N/A
MASTER L/STEEL KITS				
NI.....	DK13000S.....	Master L/Steels Kit, 01J (W/ Rev Brake Piston) 2002-Up.....	1.....	N/A
NI.....	DK13000XS.....	Master L/Steels Kit, 01J (W/Out Rev Brake Piston) 2002-Up.....	1.....	N/A
MASTER W/STEELS KITS				
NI.....	DK13000.....	Master W/Steels Kit, 01J (W/ Rev Brake Piston) 2002-Up.....	1.....	N/A
NI.....	DK13000X.....	Master W/Steels Kit, 01J (W/Out Rev Brake Piston) 2002-Up.....	1.....	N/A
FILTERS				
NI.....	130710.....	Filter, 01J, 2002-Up.....	1.....	01J-301-519L
NI.....	130712.....	Valve Body Screen, 01J, 2002-Up.....	1.....	TBA
NI.....	130712A.....	Valve Body Screen, 01J, 2002-Up.....	1.....	TBA
METAL CLAD SEALS				
NI.....	130151.....	Seal, 01J, Front Cover/Input Shaft, 2002-Up.....	1.....	016-311-113B
NI.....	119152.....	Seal, 01J, Manual Lever, 2002-Up.....	1.....	01J-321-182
NI.....	130155.....	Seal, 01J, Manual Shaft, 2002-Up.....	1.....	TBA
NI.....	119154.....	Seal, 01J, Axle, 2002-Up.....	2.....	016-409-399B
NI.....	130153.....	Seal, 01J, Transmission To Diff, 2002-Up.....	1.....	01J-331-261P
NI.....	130153.....	Seal, 01J, Axle, 2002-Up.....	1.....	01J-331-261P
FRICTIONS				
NI.....	130101.....	Friction, Forward, 01J (.080", 4.332" ID, 30-External Teeth) 2002-Up.....	6-7.....	01J-323-944S
NI.....	130103.....	Friction, Reverse, 01J (.107", 7.160" OD, 40-Internal Teeth) 2002-Up.....	6-7.....	TBA
NI.....	K130F.....	Friction Module, 01J, 2002-Up.....	1.....	FRMVW08
STEELS				
NI.....	130100.....	Steel, Forward, 01J (.076", 26T, 5.434" ID) 2002-Up.....	4.....	TBA
NI.....	130100A.....	Steel, Forward, 01J (.089", 26T, 5.434" ID) 2002-Up.....	1.....	TBA
NI.....	130100B.....	Steel, Forward, 01J (.098", 26T, 5.434" ID) 2002-Up.....	2.....	TBA
NI.....	130102.....	Steel, Reverse, 01J, 2002-Up.....	1.....	TBA
NI.....	K130S.....	Steel Module, 01J, 2002-Up.....	1.....	STMVW08
MISCELLANEOUS COMPONENTS				
NI.....	130762.....	Piston, 01J, Reverse Brake, 2002-Up.....	1.....	TBA
NI.....	130436.....	Magnetic Sensor, 01J, Counter Shaft, 2002-Up.....	1.....	01J-331-291-F
NI.....	130436A.....	Magnetic Sensor, 01J, Main Shaft to Rear Cover, 2002-Up.....	1.....	01J-331-191-B
NI.....	130991.....	Oil Feed Pipe, 01J, Forward Clutch, 2002-Up.....	1.....	01J-323-530G

02E, DSG (DUAL CLUTCH)

ILL#	Part#		QTY	REF#
OVERHAUL KITS				
NI.....	K109900.....	Overhaul Kit, 02E (W/ Pistons/Retainers) 2003-Up.....	1	N/A
NI.....	K109900X.....	Overhaul Kit, 02E (W/Out Pistons/Retainers) 2003-Up.....	1	N/A
NI.....	K109900-99.....	Pistons/Retainers Kit, 02E 2003-Up.....	1	K40900Q-99
MASTER L/STEEL KIT				
NI.....	DK10900S.....	Master L/Steels Kit, 02E (W/ Pistons/Retainers) 2003-Up.....	1	N/A
NI.....	DK10900XS.....	Master L/Steels Kit, 02E (Pistons/Retainers) 2003-Up.....	1	N/A
MASTER W/STEEL KIT				
NI.....	DK10900.....	Master W/Steels Kit, 02E (W/ Pistons/Retainers) 2003-Up.....	1	N/A
NI.....	DK10900X.....	Master W/Steels Kit, 02E (W/Out Pistons/Retainers) 2003-Up.....	1	N/A
FILTER				
NI.....	109710.....	Filter, 02E (Intake In Center) 2003-Up.....	1	02E-325-429D
NI.....	109710A.....	Filter, 02E (Intake On End) 2003-Up.....	1	TBA
NI.....	109711.....	Filter, 02E External (Cartridge) 2003-Up.....	1	02E-305-051B
METAL CLAD SEALS				
NI.....	109154.....	Seal, 02E, Axle (Dual Drum Side) (2.570" OD) 2003-Up.....	1	02T-409-189C
NI.....	109154A.....	Seal, 02E, Axle (Dual Drum Side) (2.880" OD) 2003-Up.....	1	02Q-409-189
NI.....	109153.....	Seal, 02E, Axle (Differential Side) 2003-Up.....	1	02M-301-189B
NI.....	109155.....	Seal, 02E, Selector Shaft, 2003-Up.....	1	02A-301-227M
FRICTIONS				
NI.....	109101.....	Friction, 02E, K1(Large) 2003-Up.....	4	TBA
NI.....	109103.....	Friction, 02E, K2 (Small) 2003-Up.....	5	TBA
NI.....	K109F.....	Friction Module, 02E, 2003-Up.....	1	FRMVW10
STEELS				
NI.....	109100.....	Steel, 02E, K1(Large) 2003-Up.....	5	TBA
NI.....	109102.....	Steel, 02E, K2 (Small) .061"Thk, 2003-Up.....	5-7	TBA
NI.....	109102A.....	Steel, 02E, K2 (Small) .091"Thk, 2003-Up.....	4	TBA
NI.....	K109S.....	Steel Module, 02E, 2003-Up.....	1	STMVW10
ELECTRICAL COMPONENTS				
NI.....	109934.....	Solenoid, 02E Open Coil, 2003-Up.....	1	TBA
NI.....	109935.....	Solenoid, 02E 3-Bolt Hole, 2003-Up.....	4	TBA
NI.....	109933.....	Solenoid, 02E Linear, 2003-Up.....	2	TBA
NI.....	109931.....	Solenoid, 02E 45-Degree Bracket, 2003-Up.....	2	TBA
NI.....	109954.....	Sensor 02E Input Speed, 2003-Up.....	1	TBA
NI.....	109932.....	Solenoid, 02E 90-Degree Bracket, 2003-Up.....	2	TBA
NI.....	109970.....	Connector Plate, 02E W/ TCM & Sensors, 2003-Up.....	1	TBA
NI.....	109970A.....	Connector Plate, 02E W/ Solenoids, 2003-Up.....	1	TBA
MISCELLANEOUS COMPONENTS				
NI.....	K1099003.....	Ring Kit, 02E, 2003-Up.....	1	TBA
NI.....	109500.....	Pan Gasket, 02E, 2003-Up.....	1	02E-321-371E

Notes