

722.3, 722.4, 722.5

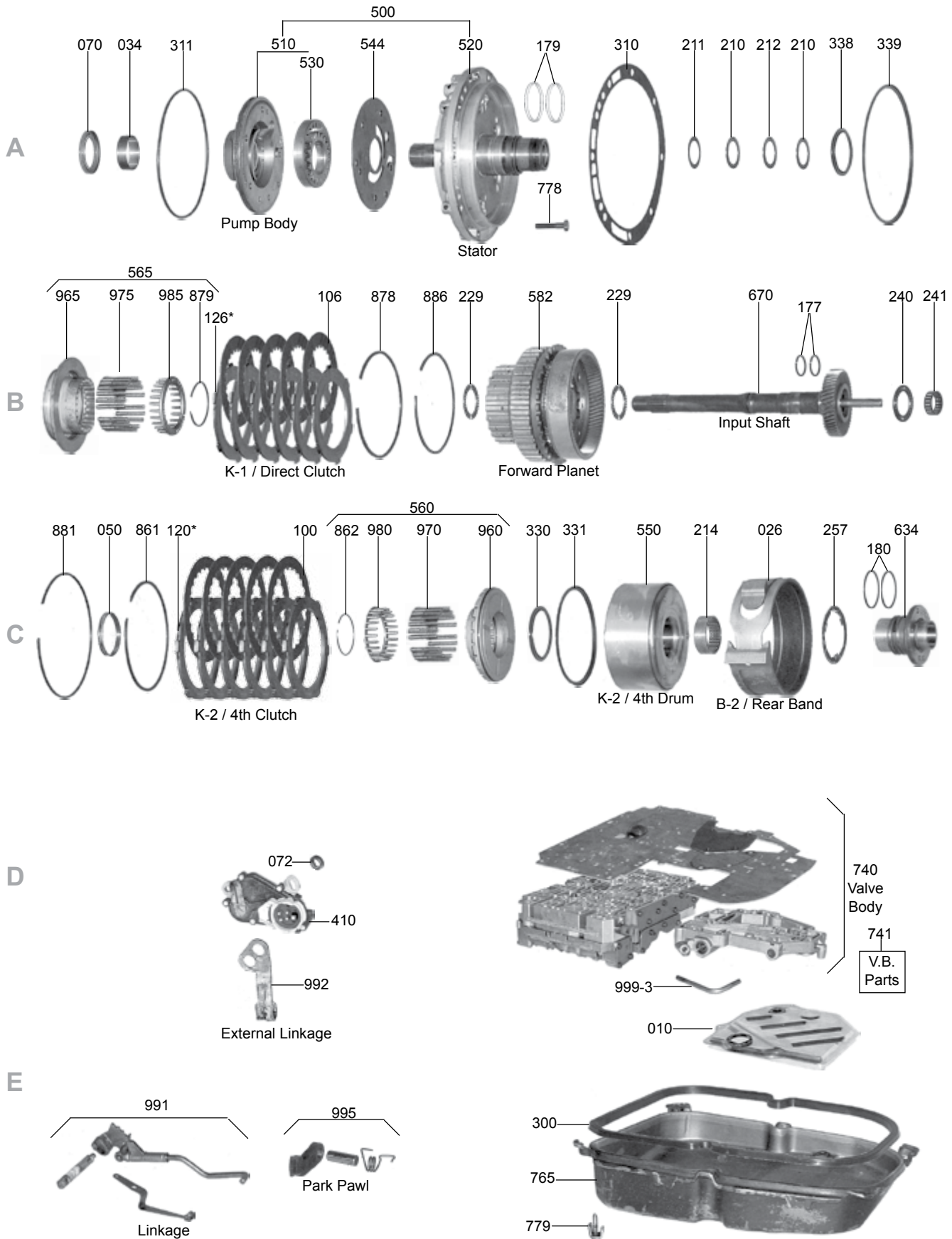

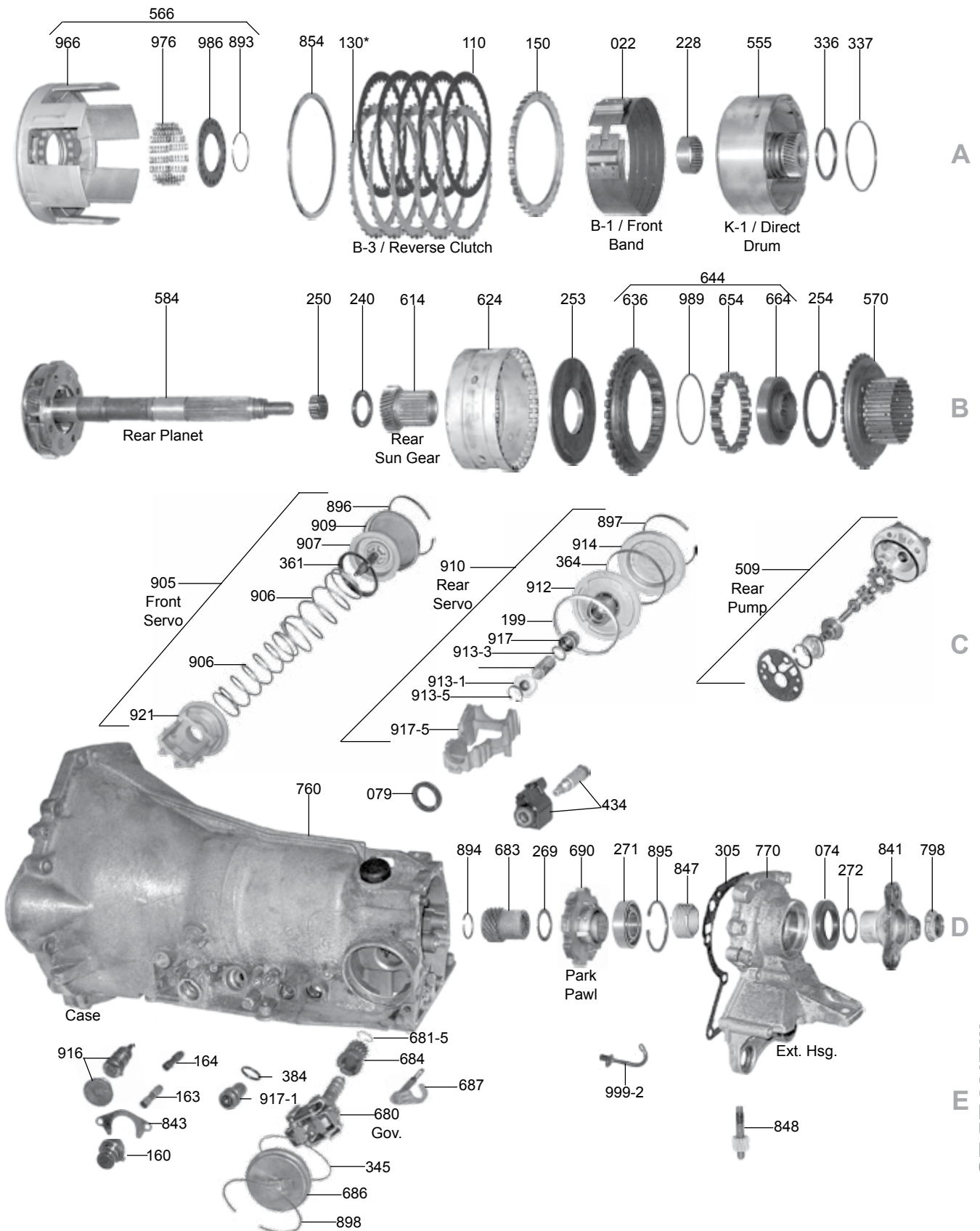

722.3, 722.4, 722.5

ILL#	Part#		QTY	REF#
OVERHAUL KITS				
NI.....	K68900E.....	Overhaul Kit, 722.4 (Small Case-W4A020) 1984-97.....	1.....	N/A
NI.....	K68900A.....	Overhaul Kit, 722.3 (Large Case-W4A040) 1981-97.....	1.....	N/A
NI.....	K68900F.....	Overhaul Kit, 722.5 (5 Speed) 1990-97.....	1.....	N/A
MASTER L/STEEL KITS				
NI.....	DK6800ES.....	Master L/Steels Kit, 722.4 (Small Case-W4A020) 1984-97.....	1.....	N/A
NI.....	DK6800AS.....	Master L/Steels Kit, 722.3 (Large Case-W4A040) 1981-97.....	1.....	N/A
NI.....	DK6800FS.....	Master L/Steels Kit, 722.5 (5 Speed) 1990-97.....	1.....	N/A
MASTER W/STEELS KITS				
NI.....	DK6800E.....	Master W/Steels Kit, 722.4 (Small Case-W4A020) 1984-97.....	1.....	N/A
NI.....	DK6800A.....	Master W/Steels Kit, 722.3 (Large Case-W4A040) 1981-97.....	1.....	N/A
NI.....	DK6800F.....	Master W/Steels Kit, 722.5 (5 Speed) 1990-97.....	1.....	N/A
FILTERS				
010.....	68710D.....	Filter, 722.3/722.4 All 1981-97.....	1.....	126-277-0295
010.....	68712.....	Filter, 722.5 (5 Speed) 1990-97.....	1.....	129-277-0195
011.....	FK68710E.....	Filter Kit, 722.4 (Small Case) 1984-97.....	1.....	TBA
011.....	FK68710D.....	Filter Kit, 722.3 (Large Case) 1981-97.....	1.....	TBA
011.....	KF68712.....	Filter Kit, 722.5 (5 Speed) 1990-97.....	1.....	TBA
BANDS				
022.....	68702A.....	Band, 722.4 Front (Semi Flex) 1984-97.....	1.....	124-270-0062
022.....	68700.....	Band, 722.3 Front (Semi Flex) 1981-97.....	1.....	126-270-1662
022.....	68700.....	Band, 722.5 Front (Semi Flex) 1990-97.....	1.....	126-270-1862
026.....	68704.....	Band, 722.4 Rear (Split) 1984-97.....	1.....	201-270-1062
026.....	68701B.....	Band, 722.3 Rear (Split) 1981-97.....	1.....	126-270-1562
026.....	68701B.....	Band, 722.5 Rear (Split) 1990-97.....	1.....	126-270-2062
BUSHINGS				
034.....	68002.....	Bushing, 722.3/722.5 Front Pump Body 1981-97.....	1.....	23009
034.....	68003.....	Bearing Style 722.4 Front Pump Body (Can Use 68003) 1984-97.....	1.....	TBA
050.....	68010.....	Bushing, 722.4 Supporting Disc 1984-97.....	1.....	TBA
050.....	68010A.....	Bushing, 722.3 Supporting Disc 1981-97.....	1.....	TBA
METAL CLAD SEALS				
070.....	68163.....	Seal, 722.4 Front 1984-97.....	1.....	010-997-4547
070.....	68161.....	Seal, 722.3 / 722.5 Front 1981-97.....	1.....	004-997-2847
072.....	68173.....	Seal, 722.3/722.4/722.5, Linkage Shaft 1981-97.....	1.....	006-997-0147
074.....	68164.....	Seal, 722.3/722.4/722.5 Rear (2.450" OD) (1.525" ID) (OE# 012-997-8747) 1981-97.....	1.....	012-997-8747
FRICTIONS				
100.....	68108.....	Friction, 722.4 4th Clutch (K2) .083" (4.25" OD) 36 Teeth 1984-97.....	3-5.....	123-272-0125
100.....	68106.....	Friction, 722.3/722.5 4th Clutch (K2) .085" (4.800" OD) 24 Teeth 1981-97.....	4-5.....	126-272-0725
102.....	68134.....	Friction, 722.5 Overdrive Clutch (BS) .085" (5.50" OD) 28 Teeth 1990-97.....	4.....	124-272-0025
106.....	68109.....	Friction, 722.4 Direct Clutch (K1) .083" (4.675" OD) 40 Teeth 1984-97.....	3-5.....	123-272-0225
106.....	68105.....	Friction, 722.3/722.5 Direct Clutch (K1) .083" (5.265" OD) 24 Teeth 1981-97.....	3-5.....	126-272-0625
110.....	68110.....	Friction, 722.4 Reverse Clutch (B3) .081" (6.00" OD) 30 Teeth 1984-97.....	3-5.....	123-272-0325
110.....	68107.....	Friction, 722.3/722.5 Reverse Clutch (B3) .081" (6.60" OD) 36 Teeth 1981-97.....	4-5.....	126-272-0925
116.....	68132.....	Friction, 722.5 Overrun Clutch (KS) .083" (4.180" OD) 22 Teeth 1990-97.....	4.....	124-272-0125
119.....	K68EF.....	Friction Module, 722.4 1984-97.....	1.....	TBA
119.....	K68AF.....	Friction Module, 722.3 1981-97.....	1.....	TBA
119.....	RK68FF.....	Friction Module, 722.5 (5 Speed) 1990-97.....	1.....	TBA
STEELS				
120.....	68128.....	Steel, 722.4 4th Clutch (K2) (.078") 6 Teeth (3.250" ID) 1984-97.....	4.....	TBA
120.....	68128A.....	Steel, 722.4 4th Clutch (K2) (.118") 6 Teeth (3.250" ID) 1984-97.....	4.....	TBA
120.....	68128B.....	Steel, 722.4 4th Clutch (K2) (.138") 6 Teeth (3.250" ID) 1984-97.....	4.....	TBA
120.....	38128C.....	Steel, 722.4 4th Clutch (K2) (.157") 6 Teeth (3.250" ID) 1984-97.....	4.....	TBA
120.....	68128D.....	Steel, 722.4 4th Clutch (K2) (.177") 6 Teeth (3.250" ID) 1984-97.....	4.....	TBA
120.....	68116.....	Steel, 722.3/722.5 4th Clutch (K2) (.078") 6 Teeth (3.464" ID) 1981-97.....	4.....	TBA
120.....	68116A.....	Steel, 722.3/722.5 4th Clutch (K2) (.118") 6 Teeth (3.464" ID) 1981-97.....	AR.....	TBA
120.....	68116B.....	Steel, 722.3/722.5 4th Clutch (K2) (.138") 6 Teeth (3.464" ID) 1981-97.....	AR.....	TBA
120.....	68116D.....	Steel, 722.3/722.5 4th Clutch (K2) (.177") 6 Teeth (3.464" ID) 1981-97.....	AR.....	TBA
120.....	68116E.....	Steel, 722.3/722.5 4th Clutch (K2) (.197") 6 Teeth (3.464" ID) 1981-97.....	AR.....	TBA
120.....	68116F.....	Steel, 722.3/722.5 4th Clutch (K2) (.217") 6 Teeth (3.464" ID) 1981-97.....	AR.....	TBA
122.....	68133.....	Steel, 722.5 Overdrive Clutch (BS) (.098") (8 Teeth) (4.786" ID) 1990-97.....	3-4.....	TBA

ILL#	Part#		QTY	REF#
122.....	68133A.....	Steel, 722.5 Overdrive Clutch (BS) (.215") (8 Teeth) (4.786" ID) 1990-97	AR.....	TBA
126.....	68128.....	Steel, 722.4 Direct Clutch (K1) .078" (6 Teeth) 3.524" ID 1984-97.....	8.....	TBA
126.....	68128A.....	Steel, 722.4 Direct Clutch (K1) .118" (6 Teeth) 3.524" ID 1984-97.....	AR.....	TBA
126.....	68128B.....	Steel, 722.4 Direct Clutch (K1) .138" (6 Teeth) 3.524" ID 1984-97.....	AR.....	TBA
126.....	68128C.....	Steel, 722.4 Direct Clutch (K1) .157" (6 Teeth) 3.524" ID 1984-97.....	AR.....	TBA
126.....	68128D.....	Steel, 722.4 Direct Clutch (K1) .177" (6 Teeth) 3.524" ID 1984-97.....	AR.....	TBA
126.....	68115.....	Steel, 722.3/722.5 Direct Clutch (K1) (.078") 6 Teeth (4.094" ID) 1981-97	4.....	TBA
126.....	68115B.....	Steel, 722.3/722.5 Direct Clutch (K1) (.138") 6 Teeth (4.094" ID) 1981-97	AR.....	TBA
126.....	68115C.....	Steel, 722.3/722.5 Direct Clutch (K1) (.157") 6 Teeth (4.094" ID) 1981-97	AR.....	TBA
126.....	68115D.....	Steel, 722.3/722.5 Direct Clutch (K1) (.177") 6 Teeth (4.094" ID) 1981-97	AR.....	TBA
126.....	68115E.....	Steel, 722.3/722.5 Direct Clutch (K1) (.197") 6 Teeth (4.094" ID) 1981-97	AR.....	TBA
126.....	68115F.....	Steel, 722.3/722.5 Direct Clutch (K1) (.217") 6 Teeth (4.094" ID) 1981-97	AR.....	TBA
130.....	68130.....	Steel, 722.4 Reverse Clutch (B3) (.098") 36 Teeth (5.060" ID) 1984-97	3.....	201-272-2626
130.....	68130A.....	Steel, 722.4 Reverse Clutch (B3) (.118") 36 Teeth (5.060" ID) 1984-97.....	AR.....	TBA
130.....	68130B.....	Steel, 722.4 Reverse Clutch (B3) (.138") 36 Teeth (5.060" ID) 1984-97.....	AR.....	TBA
130.....	68130C.....	Steel, 722.4 Reverse Clutch (B3) (.157") 36 Teeth (5.060" ID) 1984-97.....	AR.....	TBA
130.....	68117.....	Steel, 722.3/722.5 Reverse Clutch (B3) (.091") 36 Teeth (5.787" ID) 1981-97.....	4.....	TBA
130.....	68117A.....	Steel, 722.3/722.5 Reverse Clutch (B3) (.110") 36 Teeth (5.787" ID) 1981-97.....	AR.....	TBA
130.....	68117B.....	Steel, 722.3/722.5 Reverse Clutch (B3) (.130") 36 Teeth (5.787" ID) 1981-97.....	AR.....	TBA
130.....	68117C.....	Steel, 722.3/722.5 Reverse Clutch (B3) (.150") 36 Teeth (5.787" ID) 1981-97.....	AR.....	TBA
136.....	68131.....	Steel, 722.5 Overrun Clutch (KS) (.078") 28 Teeth (3.504" ID) 1990-97	4.....	TBA
136.....	68131A.....	Steel, 722.5 Overrun Clutch (KS) (.138") 28 Teeth (3.504" ID) 1990-97.....	AR.....	TBA
PRESSURE PLATES				
150.....	68135.....	Pressure Plate, 722.4 Reverse Clutch (B3) 1984-97	1.....	TBA
150.....	68117D.....	Pressure Plate, 722.3/722.5 Reverse Clutch (B3) 7.7mm 36T, 1981-97.....	1.....	TBA
MODULATORS				
160.....	68820R.....	Modulator, 722.3/722.4/722.5 (Red Top) 1981-97	1.....	TBA
160.....	68821B.....	Modulator, 722.3/722.4/722.5 (Green Top) 1981-97	1.....	TBA
160.....	68820A.....	Modulator, 722.3/722.4/722.5 (Brown Top) 1981-97	1.....	TBA
160.....	68820E.....	Modulator, 722.3/722.4/722.5 (Black Top) 1981-97.....	1.....	TBA
163.....	68822E.....	Valve, 722.4 Under Modulator 1984-97.....	1.....	TBA
164.....	68821E.....	Pin, 722.4 Under Modulator Valve 1984-97.....	1.....	TBA
164.....	68821A.....	Pin, 722.3 Under Modulator Valve 1981-97.....	1.....	TBA
VALVE BODY KITS				
165.....	K68908S.....	Valve Body Kit, 722.3/722.4/722.5 (Gas) 1981-97 (Superior)	1.....	K722A-G
165.....	K68908AS.....	Valve Body Kit, 722.3/722.4/722.5 (Diesel) 1981-97 (Superior).....	1.....	K722A-D
SEALING RINGS				
175.....	K68905.....	Ring Kit, 722.4 1984-97.....	1.....	TBA
175.....	K68904.....	Ring Kit, 722.3 1981-97.....	1.....	TBA
175.....	K68904AC.....	Ring Kit, 722.3/722.4 Accumulator Rings Only (11-PTFE Rings) 1981-97.....	1.....	TBA
177.....	68302.....	Ring, 722.4 Input Shaft (Teflon) 1984-97.....	2.....	TBA
177.....	68301.....	Ring, 722.3 Input Shaft (Teflon) 1981-97.....	1.....	TBA
180.....	68303T.....	Ring, 722.3/722.4 4th Drum To Support (Teflon) 1981-97.....	2.....	TBA
WASHERS & BEARINGS				
209.....	68417.....	Bearing, 722.4 Front Pump Body 1984-97	1.....	TBA
210.....	68450.....	Race, 722.4 Stator To K1 Drum (Bearing #211 To Shim # 212) 1984-97.....	2.....	TBA
210.....	68450A.....	Shim, 722.4 Stator (Shim # 212 To K1 Drum)	1.....	TBA
210.....	68452.....	Bearing, 722.3/722.5 Stator To K1 Drum (Race #211 To Race # 212) 1981-97.....	1.....	TBA
210.....	68450C.....	Shim, 722.3/722.5 Stator (Race #212 To K1 Drum)	1.....	TBA
211.....	68459.....	Bearing, 722.4 Stator To K1 Drum 1984-97	1.....	TBA
211.....	68459A.....	Bearing, 722.3 Stator To Bearing #210 (1.539" ID Where Race Sets On Stator) 1981-97	1.....	TBA
211.....	68454E.....	Cup Race, 722.3/722.5 Stator To Bearing #210 (1.589" ID Where Race Sets On Stator).....	1.....	TBA
211.....	68454.....	Flat Race, 722.3 Stator To Bearing #210 (Not Cupped).....	1.....	TBA
212.....	68450.....	Spacer, 722.4 Stator Race #210 To Shim #210 1984-97	1.....	TBA
212.....	68431F.....	Spacer, 722.3/722.5 Stator Bearing #210 To Shim #210 1981-97	1.....	TBA
216.....	68432F.....	Shim, 722.5 Overdrive Planet (Front) 1990-97.....	1.....	TBA
217.....	68421F.....	Bearing, 722.5 Overdrive Planet (Both Sides) 1990-97	2.....	TBA
218.....	68433F.....	Shim, 722.5 Overdrive Planet (Rear) 1990-97	1.....	TBA
228.....	68401.....	Caged Bearing, 722.4 K1 Drum (Direct Clutch Drum) 1984-97	1.....	TBA
228.....	68408.....	Caged Bearing, 722.3 K1 Drum (Direct Clutch Drum) 1981-97	1.....	TBA
229.....	68923AA.....	Bearing, 722.4 Sun Gear Drum To Front Planet 1984-97	2.....	TBA
229.....	68923B.....	Bearing, 722.3/722.5 Sun Gear Drum To Front Planet 1981-97	2.....	TBA
240.....	68457B.....	Bearing, 722.4 Input Shaft To Rear Planet & Rear Planet To Sun Gear 1984-97	2.....	TBA

722.3, 722.4, 722.5

ILL#	Part#		QTY	REF#
240.....	68457A.....	Bearing, 722.3/722.5 Input Shaft To Rear Planet & Rear Planet To Sun Gear 1981-97	2.....	TBA
241.....	68410A.....	Roller Bearing, 722.4 Input Shaft To Rear Planet 1984-97	1.....	TBA
241.....	68410B.....	Roller Bearing, 722.3/722.5 Input Shaft To Rear Planet 1981-97	1.....	TBA
250.....	68413A.....	Roller Bearing, 722.4 (Split) Output Shaft To Rear Sun Gear 1984-97	1.....	TBA
250.....	68413.....	Roller Bearing, 722.3/722.5 (Split) Output Shaft To Rear Sun Gear 1981-97	1.....	TBA
253.....	68929A.....	Shim, 722.4 Aluminum Support To Sun Gear Support 1984-97	1.....	TBA
253.....	68929B.....	Shim, 722.3 Aluminum Support To Sun Gear Support 1981-97	1.....	TBA
253.....	68929F.....	Shim, 722.5 Aluminum Support To Sun Gear Support 1990-97	1.....	TBA
254.....	68451.....	Washer, 722.4 Roller Clutch To K2 Hub (3 Tab)(Metal)(3.150" OD) 1984-97	1.....	TBA
254.....	68451A.....	Washer, 722.3 Roller Clutch To K2 Hub (3 Tab)(Plastic)(3.895" OD) 1984-97	1.....	TBA
256.....	68422E.....	Caged Bearing, 722.4 K2 Drum (4th Clutch Drum) 1984-97	1.....	TBA
256.....	68422A.....	Caged Bearing, 722.3 K2 Drum (4th Clutch Drum) 1981-97	1.....	TBA
257.....	68460.....	Washer, 722.4 K2 Drum To Rear Support (1 Tab For Support) 1984-97	1.....	TBA
257.....	68458B.....	Washer, 722.3 K2 Drum Rear 1981-97	1.....	TBA
257.....	68458F.....	Washer, 722.5 K2 Drum Rear 1990-97	1.....	TBA
269.....	68935A.....	Spacer, 722.4 Under Governor Drive Gear 1984-97	1.....	TBA
269.....	68936A.....	Shim, 722.4 Governor Drive Gear To Park Gear 1984-97	1.....	TBA
271.....	68462A.....	Ball Bearing, 722.3/722.4 Extension Housing 1981-97	1.....	TBA
271.....	68462B.....	Ball Bearing, 722.5 Extension Housing 1990-97	1.....	TBA
272.....	68940B.....	Shim, 722.4 Extension Housing Bearing To Yoke 1984-97	1.....	TBA
272.....	68940A.....	Shim, 722.3/722.5 Extension Housing Bearing To Yoke 1981-97	1.....	TBA

GASKETS & RUBBER COMPONENTS

300.....	68502.....	Gasket, 722.4 Bottom Pan 1984-97	1.....	123-271-0280
300.....	68501.....	Gasket, 722.3/722.5 Bottom Pan 1981-97	1.....	126-271-0280
305.....	68272B.....	Gasket, 722.4 Extension Housing	1.....	TBA
305.....	68272A.....	Gasket, 722.3 Extension Housing 1981-97 (OE # 123-271-0580)	1.....	TBA
305.....	68272AA.....	Gasket, 722.3 Extension Housing 1981-97 (OE # 124-271-0280)	1.....	TBA
310.....	68531A.....	Gasket, 722.4 Pump 1984-97	1.....	TBA
310.....	68531.....	Gasket, 722.3 Pump 1981-97	1.....	TBA
311.....	68506B.....	O-Ring, 722.4 Pump 1984-97	1.....	TBA
311.....	68506.....	O-Ring, 722.3 / 722.5 Pump 1981-97	1.....	TBA

TECHNICAL MANUALS

400.....	TMMBZ3.....	Technical Manual, 722.3/722.4 (4 Speed) 1981-97	1.....	83-7224TM
400.....	TMMBZ5.....	Technical Manual, 722.5 (5 Speed) 1990-97	1.....	TBA

ELECTRICAL COMPONENTS

410.....	68991A.....	Switch, 722.3/722.4/722.5 Starter Lock Out (Neutral) 1981-97	1.....	TBA
414.....	68992A.....	Switch, 722.3/722.5 Overload Protection 1981-97	1.....	TBA
434.....	68939A.....	Solenoid, 722.3/722.4/722.5 Kickdown 1981-97 (Except 1994-97 S320 & SI320)	1.....	TBA
434.....	68939B.....	Solenoid, 722.5 Kickdown (S320 & SI320) 1994-97	1.....	TBA
436.....	68958A.....	Sensor, 722.3/722.4/722.5 Vehicle Speed Sensor (VSS) 1981-97	1.....	TBA

PUMPS & PUMP COMPONENTS

500.....	68912B.....	Pump, 722.4 Front 1984-97	1.....	TBA
500.....	68912AA.....	Pump, 722.3 Front (1.535" OD Where Cup Race # 211 Sets) 1981-97	1.....	TBA
500.....	68912F.....	Pump, 722.3/722.5 Front (1.585" OD Where Cup Race # 211 Sets) 1981-97	1.....	TBA
500.....	68912BB.....	Pump, 722.3 Front (1.645" OD Where Flat Race # 211 Sets) 1981-97	1.....	TBA
509.....	68944A.....	Pump, 722.4/722.5 Rear 1984-97	1.....	TBA
509.....	68944AA.....	Pump, 722.3 Rear 1981-97	1.....	TBA
510.....	68914A.....	Pump Body, 722.4 Front (Needle Bearing Type) 1984-97	1.....	1232700097
510.....	68913B.....	Pump Body, 722.3/722.5 (Bushing Type) (Cast # 126) 1981-97	1.....	TBA
510.....	68913BA.....	Pump Body, 722.3/722.5 (Bushing Type) (Cast # 140) 1990-97	1.....	TBA
520.....	68916AA.....	Stator, 722.4 Front Pump 1984-97	1.....	TBA
520.....	68915BB.....	Stator, 722.3/722.5 Front Pump (1.535" OD Where Cup Race # 211 Sets) 1981-97	1.....	TBA
520.....	68916BA.....	Stator, 722.3/722.5 Front Pump (1.585" OD Where Cup Race # 211 Sets) 1981-97	1.....	TBA
520.....	68916BC.....	Stator, 722.3/722.5 Front Pump (1.645" OD Where Cup Race #211 Sets) 1981-97	1.....	TBA
520.....	68915S.....	Stator Shaft, 722.3/722.5 Front Pump 1981-97	1.....	TBA
520.....	68916S.....	Stator Shaft, 722.4 Front Pump 1984-97	1.....	TBA
544.....	68920AA.....	Plate, 722.4 Front Pump 1984-97	1.....	TBA
544.....	68920B.....	Plate, 722.3/722.5 Front Pump 1981-97	1.....	TBA

DRUMS & CLUTCH HUBS

550.....	68931A.....	Drum, 722.4 4th Clutch (K2) (3 Clutch) 1984-97	1.....	TBA
550.....	68931AA.....	Drum, 722.4 4th Clutch (K2) (4 Clutch) 1984-97	1.....	TBA
550.....	68932B.....	Drum, 722.3 4th Cl (K2) Stamped Steel (W/ Washer On Back) W/Needle Brg In Bore, 1981-.....	1.....	TBA
550.....	68932C.....	Drum, 722.3 4th Cl (K2) Cast Steel (W/ Ball Brg On Back) W/Needle Brg In Bore, 1981-Up.....	1.....	TBA

722.3, 722.4, 722.5

ILL#	Part#		QTY	REF#
550.....	68931AB.....	Drum, 722.4 4th Cl)K2) Cast Steel (W/Washer On Back) W/Needle Brg In Bore, 1984-97.....	1.....	TBA
555.....	68922A.....	Drum, 722.4 Direct (K1) With 26 Teeth Sun Gear 1984-97.....	1.....	TBA
555.....	68922B.....	Drum, 722.3 Direct (K1) Clutch (With 26 Teeth Sun Gear) 1981-97.....	1.....	TBA
555.....	68922BA.....	Drum, 722.3 Direct (K1) Clu (With 34T Sun Gear) 1981-97 (Uses A 4 1/2" OD Piston).....	1.....	TBA
555.....	68922BC.....	Drum, 722.3 Direct (K1) Clutch (With 34T Sun Gear) 1981-97 (Uses A 5" OD Piston).....	1.....	TBA
NI.....	68735F.....	Drum, 722.5 Overdrive, 1990-Up.....	1.....	129 270 01 28
560.....	K68675A.....	Piston Kit, 722.4 4th Clutch (K2) 1984-97.....	1.....	TBA
565.....	K68763A.....	Piston Kit, 722.4 Direct (K1) Clutch 1984-97.....	1.....	TBA
565.....	K68763B.....	Piston Kit, 722.3 Direct (K1) Clutch (4 1/2" OD Piston) 1981-97.....	1.....	TBA
565.....	K68763BA.....	Piston Kit, 722.3 Direct (K1) Clutch (5" OD Piston) 1981-97.....	1.....	TBA
566.....	K68921A.....	Piston Kit, 722.4 Reverse Clutch (B3) 1984-97.....	1.....	TBA
566.....	K68921B.....	Piston Kit, 722.3 Reverse Clutch (B3) 1981-97.....	1.....	TBA
570.....	68741B.....	Clutch Hub, 722.4 4th Clutch (K2) 1984-97.....	1.....	TBA
570.....	68741A.....	Clutch Hub, 722.3 4th Clutch (K2) 1981-97.....	1.....	TBA
PLANETS, SUN GEARS & SUPPORTS				
580.....	68749F.....	Planet, Overdrive, 722.5.....	1.....	TBA
582.....	68924A.....	Planet, 722.4 Front 1984-97.....	1.....	2012700243
582.....	68924A.....	Planet, Front W/ 16T X 19T Pinion.....	1.....	TBA
582.....	68924B.....	Planet, 722.3 Front (Input Shaft Has 50 Teeth Sun Gear) 1981-97.....	1.....	TBA
582.....	68924BA.....	Planet, 722.3 Front (Input Shaft Has 46 Teeth Sun Gear) 1981-97.....	1.....	TBA
584.....	68926A.....	Planet, 722.4 Rear With Output Shaft 1984-97.....	1.....	TBA
584.....	68926B.....	Planet, 722.3 Rear With Output Shaft 1981-97.....	1.....	TBA
584.....	68926F.....	Planet, 722.5 Rear W/Out Output Shaft 1990-Up.....	1.....	TBA
614.....	68927A.....	Sun Gear, 722.4 Rear 1984-97.....	1.....	TBA
614.....	68927B.....	Sun Gear, 722.3 Rear 1981-97.....	1.....	TBA
624.....	68928A.....	Aluminum Support, 722.4 Front & Rear Planet 1984-97.....	1.....	TBA
624.....	68928B.....	Aluminum Support, 722.3 Front & Rear Planet 1981-97.....	1.....	TBA
634.....	68933A.....	Support, 722.4 With Rings 1984-97.....	1.....	123-272-0645
634.....	68933B.....	Support, 722.3 With Rings (2.732" OD Hub) 1981-97.....	1.....	TBA
634.....	68933BA.....	Support, 722.3 With Rings (2.915" OD Hub) 1981-97.....	1.....	TBA
636.....	68738E.....	Disk, 722.4 Supporting 1984-97.....	1.....	TBA
SPRAGS & ONE WAY CLUTCHES				
644.....	68930A.....	Sprag Assembly, 722.4 (Roller Clutch Assembly) 1984-97.....	1.....	TBA
644.....	68930AA.....	Sprag Assembly, 722.4 (With K2 Hub On Top With Ring) 1984-97.....	1.....	TBA
644.....	68930C.....	Sprag Assembly, 722.3 (With K2 Hub On Top And No Ring On Roller) 1981-97.....	1.....	TBA
644.....	68930BA.....	Sprag Assembly, 722.3 (With Out K2 Hub) 1981-97.....	1.....	TBA
644.....	68930B.....	Sprag Assembly, 722.3 (With K2 Hub On Top With Ring On Roller) 1981-97.....	1.....	TBA
654.....	68930.....	Sprag, 722.4 (F Clutch) 1984-97.....	1.....	TBA
664.....	68728E.....	Inner Race, 722.4 (F Clutch) 1984-97.....	1.....	TBA
SHAFTS & GOVERNORS				
670.....	68925AA.....	Input Shaft, 722.4 With Sun Gear 1984-97.....	1.....	TBA
670.....	68925BA.....	Input Shaft, 722.3 (With 50 Teeth Sun Gear) 1981-97.....	1.....	TBA
670.....	68925BB.....	Input Shaft, 722.3 (With 46 Teeth Sun Gear) 1981-97.....	1.....	TBA
680.....	68810A.....	Governor, 722.4 (With Plastic Gear) Goes In Units With Rear Pump.....	1.....	TBA
680.....	68810AA.....	Governor, 722.4 / 722.5 (With Plastic Gear) Used In Units Without Rear Pump.....	1.....	TBA
680.....	68810B.....	Governor, 722.3 (With Steel Gear) Used In Units With Rear Pump.....	1.....	TBA
680.....	68810BB.....	Governor, 722.3 (With Steel Gear) Used In Units Without Rear Pump.....	1.....	TBA
683.....	68934A.....	Gear, 722.4 Governor Drive (On Output Shaft) 1984-97.....	1.....	TBA
683.....	68934B.....	Gear, 722.3 Governor Drive (On Output Shaft) 1981-97.....	1.....	TBA
684.....	68934AA.....	Gear, 722.4 Governor Driven (Goes On Governor) (Plastic) 1984-97.....	1.....	TBA
684.....	68934AB.....	Gear, 722.3 Governor Driven (Goes On Governor) (Metal) 1981-97.....	1.....	TBA
686.....	68649E.....	Cover, 722.4 Governor 1984-97.....	1.....	TBA
687.....	68642E.....	Retainer, 722.4 Governor (Lock Ring) 1984-97.....	1.....	TBA
687.....	68642A.....	Retainer, 722.3 Governor Swivel Axial 1981-97.....	1.....	TBA
690.....	68937A.....	Gear, 722.4 Parking With Plastic Speed-O Gear 1984-97.....	1.....	TBA
690.....	68937B.....	Gear, 722.3 Parking With Plastic Speed-O Gear 1981-97.....	1.....	TBA
690.....	68937BA.....	Gear, 722.3 Parking (2 Holes) With Electronic Pick-Up 1981-97.....	1.....	TBA
690.....	68937BB.....	Gear, 722.3 Parking (4 Holes) With Electronic Pick-Up 1981-97.....	1.....	TBA
VALVE BODIES				
740.....	68754BC.....	Valve Body, 722.4 (Ink #'s Are 124 270 2207 Or 124 270 5715) 1984-97.....	1.....	TBA
740.....	68754BA.....	Valve Body, 722.4 (Ink #'s Are 201 270 3115) 1984-97.....	1.....	TBA
740.....	68754BB.....	Valve Body, 722.4 (Ink #'s Are 201 270 5107).....	1.....	TBA
740.....	68754AD.....	Valve Body, 722.3 (Ink #'s Are 107 270 0807) 1981-97.....	1.....	TBA
740.....	68754AA.....	Valve Body, 722.3 (Ink #'s Are 126 270 5207) 1981-97.....	1.....	TBA

722.3, 722.4, 722.5

ILL#	Part#		QTY	REF#
740.....	68754AB	Valve Body, 722.3 (Ink #s Are 126 270 7315 or 107 270 3307 or 129 270 0707) 1981-97	1	TBA
740.....	68754AC	Valve Body, 722.3 (Ink #s Are 126 270 3682)	1	TBA
740.....	68754AE	Valve Body, 722.3 (Ink #s Are 126 270 6215)	1	TBA
HOUSINGS, CASES & PANS				
760.....	68941A	Case, 722.4 (Starter At 3:00) 1984-97	1	TBA
760.....	68941B	Case, 722.3 (Starter At 9:30) 1981-97	1	TBA
760.....	68941BA	Case, 722.3 (Starter At 3:00 & 9:00) 1981-97	1	TBA
760.....	68941BB	Case, 722.3 (Starter At 3:00 Only) 1981-97	1	TBA
765.....	68943A	Pan, 722.4 Bottom 1984-97	1	TBA
765.....	68943B	Pan, 722.3 Bottom 1981-97	1	TBA
770.....	68939A	Extension Housing, 722.4 (Cast # 201-271-0001) 1984-97	1	TBA
770.....	68939B	Extension Housing, 722.3 (Cast # 124-271-0801) 1981-97	1	TBA
770.....	68939BA	Extension Housing, 722.3 (Cast # 126-271-1201) 1981-97	1	TBA
770.....	68939BB	Extension Housing, 722.3 (Cast # 107-271-0501) 1981-97	1	TBA
770.....	68939BC	Extension Housing, 722.3 (Cast # 123-271-0701) 1981-97	1	TBA
770.....	68939BD	Extension Housing, 722.3 (Cast # 123-271-1301) 1981-97	1	TBA
798.....	68081E	Nut, 722.3/722.4 Output Shaft Yoke 1981-97	1	TBA
843.....	68632E	Bracket, 722.3/722.4 Modulator 1981-97	1	TBA
841.....	68906A	Yoke, 722.3/722.4 Output Shaft 1981-97	1	TBA
847.....	68227E	Gear, 722.3/722.4 Speed-O Drive (15 Teeth Metal) 1981-97	1	TBA
847.....	68227EA	Gear, 722.3/722.4 Speed-O Drive (15 Teeth Plastic) 1981-97	1	TBA
848.....	68228E	Gear, 722.3/722.4 Driven Speed-O 1981-97	1	TBA
SERVOS, PISTONS & MISCELLANEOUS				
854.....	68854	Cushion, 722.4 Reverse Clutch (B3) 1984-97	1	TBA
854.....	68854A	Cushion, 722.3 Reverse Clutch (B3) 1981-97	1	TBA
905.....	68954A	Servo Assembly, 722.4 Front (Piston Cast # 123270038) 1984-97	1	TBA
905.....	68954AA	Servo Assembly, 722.4 Front (Piston Cast # 1232770338) 1984-97	1	TBA
905.....	68954AB	Servo Assembly, 722.4 Front (Piston Cast # 1232770038)	1	TBA
905.....	68954B	Servo Assembly, 722.3 Front (Piston Cast # 126277038)	1	TBA
906.....	68623E	Spring, 722.4 Front Servo Return 1984-97	1	TBA
906.....	68623C	Spring, 722.3 Front Servo Return 1981-97	1	TBA
907.....	68997E	Piston, 722.4 Front Servo 1984-97	1	TBA
907.....	68997C	Piston, 722.3 Front Servo 1981-97	1	TBA
909.....	68924E	Cover, 722.4 Front Servo 1984-97	1	TBA
909.....	68924C	Cover, 722.3 Front Servo 1981-97	1	TBA
910.....	68964A	Servo Assembly, 722.4 Rear 1984-97	1	TBA
910.....	68964B	Servo Assembly, 722.3 Rear 1981-97	1	TBA
912.....	68997EA	Piston, 722.4 Rear Servo (2.950" OD) 1984-97	1	TBA
912.....	68997CA	Piston, 722.3 Rear Servo (3.460" OD) 1981-97	1	107-270-0432
913.....	68633E	Pin, 722.4 Rear Servo 1984-97	1	TBA
913.....	68633A	Pin, 722.3 Rear Servo 1981-97	1	TBA
914.....	68624EA	Cover, 722.4 Rear Servo 1984-97	1	TBA
914.....	68624CA	Cover, 722.3 Rear Servo 1981-97	1	TBA
921.....	68634E	Guide, 722.4 Front Servo (Cast # 1232770340M) 1984-97	1	TBA
921.....	68634EA	Guide, 722.4 Front Servo (Cast # 1232770840M) 1984-97	1	TBA
921.....	68634A	Guide, 722.3 Front Servo 1981-97	1	TBA
958.....	68635E	Tube, 722.4 Valve Body To Case 1984-97	1	TBA
958.....	68635A	Tube, 722.3 Valve Body To Case 1981-97	1	TBA
960.....	68762A	Piston, 722.4 K2 Clutch 1984-97	1	TBA
960.....	68762B	Piston, 722.3 K2 Clutch 1981-97	1	TBA
965.....	68763A	Piston, 722.4 Direct (K1) Clutch 1984-97	1	TBA
965.....	68763B	Piston, 722.3 Direct (K1) Clutch (4 1/2" OD) 1981-97	1	TBA
965.....	68763BA	Piston, 722.3 Direct (K1) Clutch (5" OD) 1981-97	1	TBA
966.....	68921A	Piston, 722.4 Reverse Clutch (B3) 1984-97	1	TBA
966.....	68921B	Piston, 722.3 Reverse Clutch (B3) 1981-97	1	TBA
NI.....	68766F	Piston, 722.5 Overdrive Clutch Drum (BS) 1990-97	1	TBA
970.....	68872E	Spring, 722.4 4th Clutch Return 1984-97	1	TBA
970.....	68872A	Spring, 722.3 4th Clutch Return 1981-97	1	TBA
975.....	68873E	Spring, 722.4 Direct Clutch Return 1984-97	1	TBA
975.....	68873A	Spring, 722.3 Direct Clutch Return 1981-97	1	TBA
976.....	68871E	Spring, 722.4 Reverse Clutch Return 1984-97	1	TBA
976.....	68871A	Spring, 722.3 Reverse Clutch Return 1981-97	1	TBA
980.....	68862E	Retainer, 722.4 4th Clutch Spring 1984-97	1	TBA
980.....	68862A	Retainer, 722.3 4th Clutch Spring 1981-97	1	TBA
980.....	K68900E-2	Repair Kit, 722.4, K1, K2 Clutch Piston Retainer, 1984-Up (Precision)	1	TBA
985.....	68863E	Retainer, 722.4 Direct Clutch Spring 1984-97	1	TBA

722.3, 722.4, 722.5

ILL#	Part#		QTY	REF#
985.....	68863A.....	Retainer, 722.3 Direct Clutch Spring 1981-97	1.....	TBA
986.....	68864E.....	Retainer, 722.4 Reverse Clutch Spring 1984-97	1.....	TBA
986.....	68864A.....	Retainer, 722.3 Reverse Clutch Spring 1981-97	1.....	TBA
989.....	68637F.....	Retaining Ring, 722.4 (F Clutch Sprag) 1984-97	1.....	TBA
992.....	68638E.....	Shift Lever, 722.4 External 1984-97	1.....	TBA
992.....	68638A.....	Shift Lever, 722.3 External 1981-97	1.....	TBA
995.....	K68937A.....	Park Pawl Assembly, 722.4 1984-97	1.....	TBA
995.....	K68937B.....	Park Pawl Assembly, 722.3 1981-97	1.....	TBA

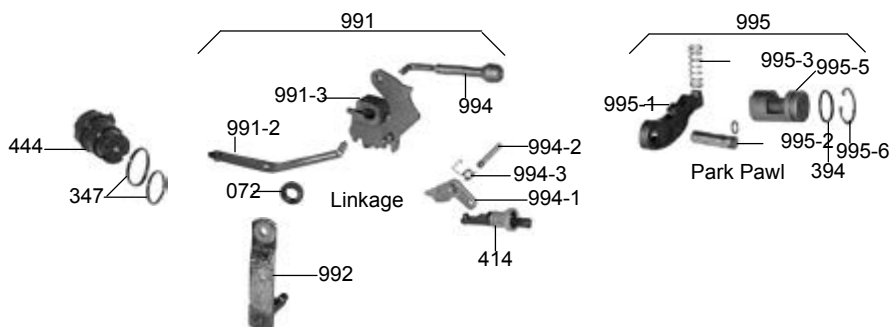
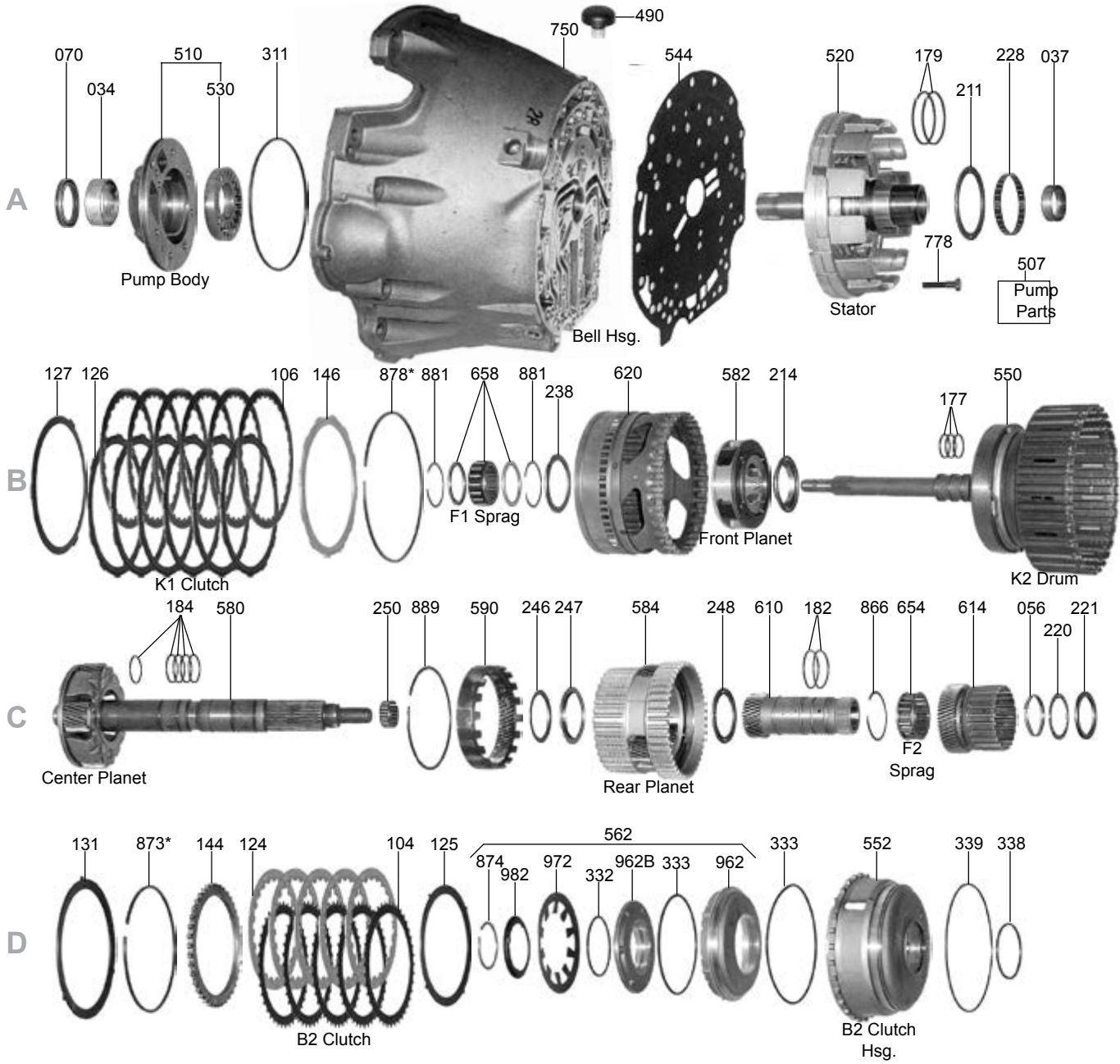

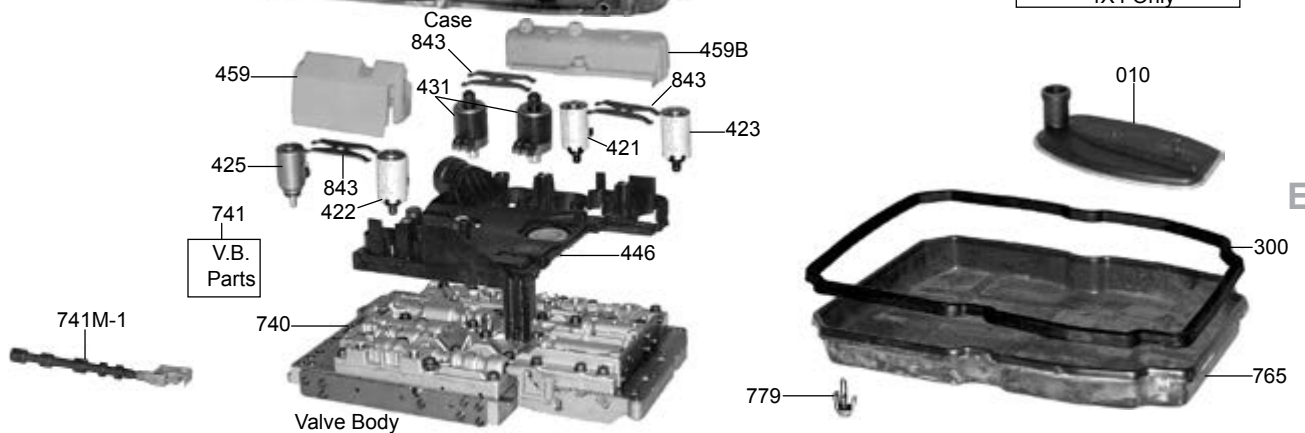
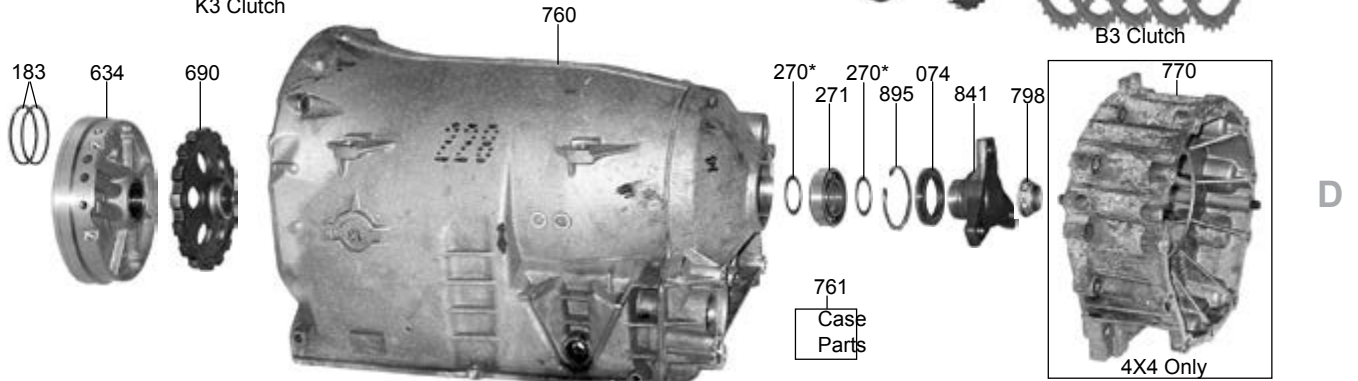
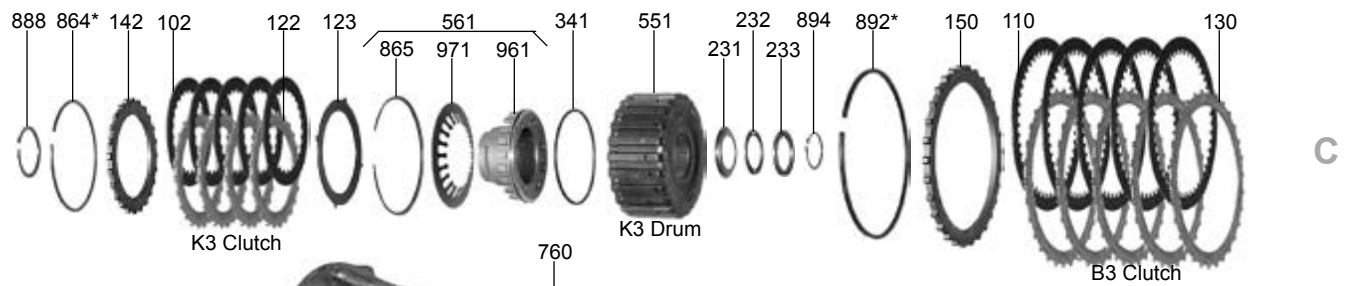
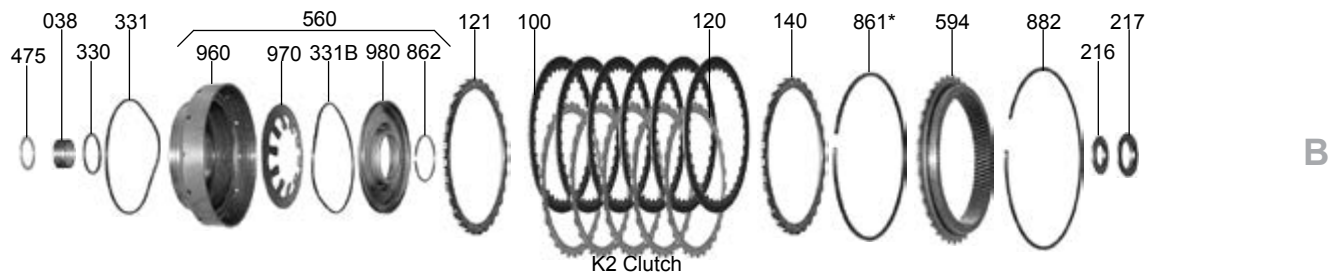
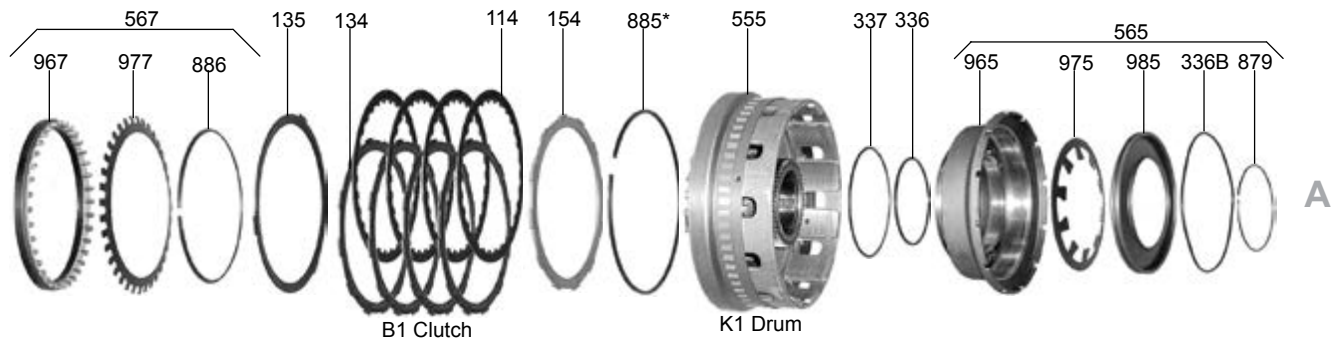

722.6

ILL#	Part#		QTY	REF#
OVERHAUL KITS				
NI.....	K68900G.....	Overhaul Kit, 722.6 W/ B1 Piston & Metal Converter Hsg Gasket 1996-Up	1	N/A
NI.....	K68900GX.....	Overhaul Kit, 722.6 W/ Out B1 Piston & Metal Converter Hsg Gasket 1996-Up.....	1	N/A
MASTER L/STEEL KITS				
NI.....	DK6800GXS.....	Master L/Steels Kit, 722.6 (Mercedes) 1996-01 (W /Out B1 Piston & Conv Hsg Gskt)	1	N/A
NI.....	DK6800GS.....	Master L/Steels Kit, 722.6 (Mercedes) 1996-01 (W/ B1 Piston & Conv Hsg Gskt)	1	N/A
NI.....	DK6800HXS.....	Master L/Steels Kit, 722.6 (Merced/Jag) 2002-Up (W/ Out B1 Piston & Conv Hsg Gskt).....	1	N/A
NI.....	DK6800HS.....	Master L/Steels Kit, 722.6 (Merced/Jag) 2002-Up (W/ B1 Piston Conv Hsg Gskt)	1	N/A
NI.....	DK6800JXS.....	Master L/Steels Kit, 722.6 (Chrysler/Jeep) 2004-Up (W/ Out B1 Piston & Conv Hsg Gskt)	1	N/A
NI.....	DK6800JS.....	Master L/Steels Kit, 722.6 (Chrysler/Jeep) 2004-Up (W/ B1 Piston & Conv Hsg Gskt)	1	N/A
MASTER W/STEELS KITS				
NI.....	DK6800GX.....	Master W/Steels Kit, 722.6 (Mercedes) 1996-01 (W /Out B1 Piston & Conv Hsg Gskt)	1	N/A
NI.....	DK6800G.....	Master W/Steels Kit, 722.6 (Mercedes) 1996-01 (W/ B1 Piston & Conv Hsg Gskt)	1	N/A
NI.....	DK6800HX.....	Master W/Steels Kit, 722.6 (Merced/Jag) 2002-Up (W/ Out B1 Piston & Conv Hsg Gskt)	1	N/A
NI.....	DK6800H.....	Master W/Steels Kit, 722.6 (Merced/Jag) 2002-Up (W/ B1 Piston & Conv Hsg Gskt)	1	N/A
NI.....	DK6800JX.....	Master W/Steels Kit, 722.6 (Chrys/Jeep) 2004-Up (W/ Out B1 Piston & Conv Hsg Gskt)	1	N/A
NI.....	DK6800J.....	Master W/Steels Kit, 722.6 (Chrysler/Jeep) 2004-Up (W/ B1 Piston & Conv Hsg Gskt)	1	N/A
FILTERS				
010.....	68712G.....	Filter, 722.6 (Mercedes 5 Spd W/Lock-Up) 1996-Up.....	1	140-277-0095
BUSHINGS				
034.....	68002.....	Bushing, 722.6 Pump Body.....	1	TBA
034.....	68004-01.....	Bushing, 722.6 Pump Body, OE Replacement Size, Sonnax.....	1	TBA
034.....	68004-02.....	Bushing, 722.6 Pump Body, Oversize(Finish In Place), Sonnax.....	1	TBA
037.....	68003G.....	Bushing, 722.6 Stator (Rear) 1.235" ID (Brass) 1996-Up.....	1	TBA
037.....	68915-01.....	Bushing, 722.6 Stator (Rear) OE Replacement Size, 1996-Up Sonnax	1	TBA
038.....	68010G.....	Bushing, 722.6 (Mercedes) K2 Drum (Rear) (.915" ID) 1996-Up.....	1	TBA
038.....	68410-01.....	Bushing, 722.6 K2 Clutch Drum, OE Replacement Size, 1996-Up Sonnax.....	1	TBA
215.....	68423G.....	Caged Needle Bearing, 722.6 (Chrysler) K2 Drum (Rear) (Cast # HK2210) 2004-Up	1	TBA
215.....	68410-02K.....	Caged Needle Bearing & Seal Kit, 722.6 K2 Drum (1-Needle Bearing, 1-Teflon Seal).....	1	Sonnax
038.....	K050.....	Bushing Set, 722.6 (Mercedes) K2 Drum (Rear) (1 Stock Bsh .915" ID And 1 Oversized	1	Superior
		Bushing (Oversized Bushing For The Only Output Shaft Mercedes Offers New)		
056.....	68017G.....	Bsh, 722.6 (Mercedes) Rear Sun Gear (.188" Wide) 1996-Up (2.999" OD) (Split, Brass).....	1	TBA
METAL CLAD SEALS				
070.....	68161.....	Seal, 722.6 Front 1996-Up.....	1	010-997-4747
072.....	68173.....	Seal, 722.6 Linkage Shaft 1996-Up.....	1	006-997-0147
074.....	68165G.....	Seal, 722.6 Ext Housing / Rear (.322" Thick) (2.445" OD) 1996-Up	1	140-997-0846
074.....	68165GA.....	Seal, 722.6 Adapter Housing (AWD) 1996-Up	1	210-997-0746
FRICTIONS				
100.....	68106G.....	Friction, K2, Small ID (5.25") .084", 36T, 2-Sided, 1996-Up.....	4	210-272-0025
100.....	68106H.....	Friction, K2, Large ID (5.45") .084", 36T, 2-Sided, 1996-Up.....	6	140-272-0125
102.....	68132G.....	Friction, K3 Clutch, .063", 24T, 2-Sided, 1996-Up.....	3-5	140-272-0225
102.....	68132H.....	Friction, K3 Clutch, .085", 24T, 2-Sided, 1998-Up.....	4-5	140-272-0725
102.....	68132GA.....	Friction, K3 Clutch, .083", 24T, 1-Sided, Internal Spline, 2002-Up	5	220-272-0325
102.....	68132GB.....	Friction, K3 Clutch, .083", 24T, 1-Sided, External Spline, 2002-Up.....	5	220-272-0926
104.....	68102G.....	Friction, B2 Clutch, .063", 40T, 2-Sided, External Spline, 1996-Up.....	5	140-272-0026
106.....	68105G.....	Friction, K1 Clutch, .084", 30T, 6.815" OD, 2-Sided, 1996-Up	4-6	140-272-0025
106.....	68105GA.....	Friction, K1 Clutch, .081", 30T, 6.815" OD, 1-Sided, Internal Spline, 2002-Up	5	240-272-0025
106.....	68105GB.....	Friction, K1 Clutch, .081", 12T, 6.080" ID, 1-Sided, External Spline, 2002-Up.....	5	240-272-0026
110.....	68107G.....	Friction, B3 Clutch, .063", 46T, 2-Sided, 1996-Up.....	3-5	140-272-0625
114.....	68105G.....	Friction, B1 Clutch, .084", 30T, 6.815" OD, 2-Sided, 1996-Up	3-4	140-272-0025
114.....	68105GA.....	Friction, B1 Clutch, .081", 30T, 6.815" OD, 1-Sided, Internal Spline, 2002-Up	6	240-272-0025
114.....	68105GB.....	Friction, B1 Clutch, .081", 12T, 6.080" ID, 1-Sided, External Spline, 2002-Up	6	240-272-0026
119.....	K68GF.....	Friction Module, 722.6 (With Large ID K2 Friction, For A 4 Gear Rear Planet) 1996-01	1	RCP96-024
119.....	K68GAF.....	Friction Module, 722.6 (With Small ID K2 Friction, For A 3 Gear Rear Planet) 1996-01	1	RCP96-025
119.....	K68HF.....	Friction Module, 722.6 (With Large ID K2 Friction, For A 4 Gear Rear Planet) 2002-Up	1	RCP96-028
119.....	K68HAF.....	Friction Module, 722.6 (With Small ID K2 Friction, For A 4 Gear Rear Planet) 2002-Up	1	RCP96-027
119.....	K68JF.....	Friction Module, 722.6, Chrysler Nag-1 With 5.7L & 6.1L "Hemi" Engines 2000-Up.....	1	RCP96-234
STEELS				
120.....	68119.....	Steel, 722.6 K2 Clutch .071, 30T, 1996-Up	1	140-272-0626
120.....	68119B.....	Steel, 722.6 K2 Clutch .110, 30T, 2002-Up	5	140-272-2926
120.....	68119A.....	Steel, 722.6 K2 Clutch .138, 30T, 2002-Up	3	140-272-0726

ILL#	Part#		QTY	REF#
121.....	68137C.....	Cushion, 722.6 K2 Clutch (.077") 3T, 2004-Up.....	1.....	TBA
122.....	68120.....	Steel, 722.6 K3 Clutch .071, 24T, 1996-Up.....	1.....	140-272-1026
122.....	68120B.....	Steel, 722.6 K3 Clutch .108, 24T, 1996-Up.....	4.....	140-272-2726
122.....	68120A.....	Steel, 722.6 K3 Clutch .138, 24T, 1996-Up.....	3-4.....	140-272-1126
123.....	68138C.....	Cushion, 722.6 K3 Clutch (.067") 4T (3.455" ID) 1996-Up.....	1.....	TBA
124.....	68122.....	Steel, 722.6 B2 Clutch .071, 24T, Internal Spline, 1996-Up.....	3-4.....	140-272-0425
124.....	68122G.....	Steel, 722.6 B2 Clutch .071, 40T, External Spline, 1996-Up.....	1.....	140-272-1426
125.....	68141.....	Cushion, 722.6 B2 Clutch (.080") (4 External Teeth) 1996-Up.....	1.....	TBA
126.....	68118.....	Steel, 722.6 K1 Clutch .071, 12T, 1996-Up.....	1.....	140-272-0226
126.....	68118C.....	Steel, 722.6 K1 Clutch .110, 12T, 2002-Up.....	5.....	140-272-2826
126.....	68118A.....	Steel, 722.6 K1 Clutch .138, 12T, 1996-01.....	2-3.....	140-272-0326
126.....	68118B.....	Steel, 722.6 K1 Clutch .157, 12T, 1996-Up.....	1.....	140-272-0426
127.....	68139.....	Cushion, 722.6 K1 Cl. .061", 3T, 1996-Up.....	1.....	TBA
130.....	68123.....	Steel, 722.6 B3 Clutch .071, 30T, 1996-Up.....	3-4.....	140-272-1826
131.....	68143.....	Cushion, 722.6 B3 Clutch (Bottom) .109", 3T, 6 1/8" ID 1996-Up.....	1.....	TBA
134.....	68118.....	Steel, 722.6 B1 Clutch .071, 12T, 1996-Up.....	1.....	140-272-0226
134.....	68118C.....	Steel, 722.6 B1 Clutch .110, 12T, 2002-Up.....	3.....	140-272-2826
134.....	68118A.....	Steel, 722.6 B1 Clutch .138, 12T, 1996-01.....	2-3.....	140-272-0326
134.....	68118B.....	Steel, 722.6 B1 Clutch .157, 12T, 1996-Up.....	1.....	140-272-0426
135.....	68139.....	Cushion, 722.6 B1 Cl. .061", 3T, 1996-Up.....	1.....	TBA
139.....	K68GS.....	Steel Module, 722.6 1996-97.....	1.....	141753
139.....	K68GAS.....	Steel Module, 722.6 1998-01.....	1.....	141753D
139.....	K68HS.....	Steel Module, 722.6 2002-Up.....	1.....	141753C
PRESSURE PLATES				
140.....	68137.....	Pressure Plate, 722.6 K2 Clutch (.156") 30 Teeth (5.765" ID) 1996-Up.....	1.....	TBA
142.....	68138.....	Pressure Plate, 722.6 K3 Clutch (Top) .155" (24 Teeth) 3.465" ID 1996-Up.....	1.....	TBA
144.....	68140.....	Pressure Plate, 722.6 B2 Clutch (Top) .255" (40 Teeth) 5.210" ID 1996-Up.....	1.....	TBA
146.....	68136B.....	Pressure Plate, 722.6 K1 (.156") 12 Teeth (6.063" ID) 1996-Up.....	1.....	TBA
150.....	68142.....	Pressure Plate, 722.6 B3 Clutch (Top) .255" (30 Teeth) 6 1/8" ID 1996-Up.....	1.....	TBA
154.....	68136B.....	Pressure Plate, 722.6 B1 Cl (Also K1 Cl) (.156") 12 Teeth (6.063" ID) 1996-Up.....	2.....	TBA
VALVE BODY KITS				
165.....	K68908G.....	Shift Kit, 722.6 (Mercedes, Chrysler/Jeep, Sprinter) 1996-Up (Transgo).....	1.....	SK722.6
SEALING RINGS				
NI.....	K68904G.....	Ring Kit, 722.6, 1996-Up.....	1.....	TBA
177.....	68307G.....	Ring, 722.6 (Mercedes) Input Shaft (Scarf Cut) (Teflon) 1996-Up.....	3.....	TBA
177.....	68307GA.....	Ring, (Chrysler) Input Shaft, Lap Joint (Like A Mortise & Tinno Joint) (Teflon) 2004-Up.....	3.....	TBA
179.....	68303G.....	Ring, 722.6 Stator To K1 Drum (Teflon) 1996-Up.....	3.....	TBA
184.....	68310G.....	Ring, 722.6 (Mercedes) Output Shaft (Scarf-Cut) (Teflon) 1996-Up.....	5.....	TBA
184.....	68310GA.....	Ring, 722.6 (Chrysler) Output Shaft (Lap Joint) (Teflon) 2004-Up.....	5.....	TBA
WASHERS & BEARINGS				
211.....	68459G.....	Brg W/Race, 722.6 Stator To K1 Drum (.119" Thk, 3.42" OD, 2.72" ID) 1996-Up.....	1.....	TBA
214.....	68424G.....	Bearing W/Race, 722.6 (Mercedes) Front Planet To K2 Drum 1996-Up (No Tabs).....	1.....	TBA
214.....	68424J.....	Bearing W/Race, 722.6 (Chrysler) Front Planet To K2 Drum (2 Outer Tabs) 2004-Up.....	1.....	TBA
215.....	68423G.....	Caged Needle Bearing, 722.6 (Chrysler) K2 Drum (Rear) (HK2210) 2004-Up.....	1.....	TBA
216.....	68425F.....	Race, 722.6 K2 Drum To Center Planet (1.686" OD) 1996-Up.....	1.....	TBA
217.....	68426G.....	Bearing, W/Race, 722.6 K2 Drum To Center Planet (1.755" OD) 1996-Up.....	1.....	TBA
220.....	68427G.....	Brg, (Merced) Rear Sun Gr To K3 Drum (.078" Thk, 1.905" ID, 2.403" OD) 1996-Up.....	1.....	TBA
220.....	68427J.....	Race, (Chrys) Rear Sun Gr To Brg #221 (.038" Thk, 1.915" ID, 2.553" OD) 2004-Up.....	1.....	TBA
221.....	68428G.....	Race, (Merced) Rear Sun Gr To K3 Drum (.125" Thk, 1.095" ID, 2.395" OD) 1996-Up.....	1.....	TBA
221.....	68428J.....	Ball Bearing, (Chrys Rear Sun Gr To K3 Drum (Cast # INAA210 981 03 25) 2004-Up.....	1.....	TBA
228.....	68429G.....	Caged Needle Brg, 722.6 Stator (Outer) To K1 Drum, .307" Wide, 2.70" OD, 1996-Up.....	1.....	TBA
231.....	68434G.....	Race, Center Sun Gr To B2 Cl Hsg (Stepped) 1.77" Thk, 1.405" ID, 2.198" OD, 1996-Up.....	1.....	TBA
232.....	68435G.....	Bearing, 722.6 Center Sun Gear To B3 Cl Hsg (.078") 1.385" ID, 1.84" OD, 1996-Up.....	1.....	TBA
233.....	68436G.....	Race, (Mercedes) Center Sun Gr To B2 Cl Hsg (.121", 1.386" ID, 1.822" OD, 1996-Up.....	1.....	TBA
233.....	68436J.....	Race, (Chrysler) Center Sun Gr To B2 Cl Hsg, .132", 1.386" ID, 1.822" OD, 2004-Up.....	1.....	TBA
238.....	68437G.....	Brg W/Race, (Mercedes) K1 Drum To Front Planet, .110", 2.922" OD, 2.347" ID 1996-Up.....	1.....	TBA
238.....	68437J.....	Brg, 722.6 (Chrys) K1 Drum To Front Planet, .078", 2.859" OD, 2.347" ID, 2004-Up.....	1.....	TBA
246.....	68438G.....	Race, (Mercedes) Center Planet To Rear Planet, .031", 2.744" OD, 2.235" ID, 1996-Up.....	1.....	TBA
246.....	68438J.....	Race, 722.6 (Chrys) Center Planet To Rear Planet, .031", 2.554" OD, 2.045" ID, 2004-Up.....	1.....	TBA
247.....	68439G.....	Brg W/Race, (Mercedes) Center Plan To Rear Plan (.110", 2.850" OD, 2.238" ID) No Tabs.....	1.....	TBA
247.....	68439J.....	Brg W/Race, (Chrys) Center Plan To Rear Plan (.110", 2.670" OD, 2.053" ID, 2 Tab 2004-.....	1.....	TBA
248.....	68441G.....	Brg W/Race, (Mercedes) Rear Plan To Rear Sun Gr, .136", 2.985" OD, 2.235" ID, 1996-.....	1.....	TBA
248.....	68441G.....	Brg W/Race, (Chrys) Rear Plan To Rear Sun G, .136", 2.985" OD, 2.06" ID, 2 Tab, 2004-.....	1.....	TBA
250.....	68413G.....	Split Caged Needle Bearing, 722.6 Output Shaft (Plastic) 1996-Up.....	1.....	TBA

722.6

ILL#	Part#		QTY	REF#
270.....	68442G.....	Shim, Park Gear To Rear Case Ball Brg (*Specify Thickness .008" To .020") 1996-Up.....	1.....	TBA
271.....	68462G.....	Ball Brg, Case To Output Shaft (Cast # 140 981 01 25, INA 6206E A HO1)1996-Up.....	1.....	TBA
GASKETS & RUBBER COMPONENTS				
300.....	68501G.....	Gasket, 722.6 Bottom Pan 1996-Up.....	1.....	TBA
311.....	68506G.....	O-Ring, 722.6 Pump Body To Bell 1996-Up.....	1.....	TBA
371.....	68291A.....	O-Ring, 722.6 Filler Tube 1996-01.....	1.....	016-997-2948
371.....	68291G.....	Boot, 722.6 Filler Tube (All Except NAG-1) 2002-Up.....	1.....	53013512AA
371.....	44291.....	Boot, Filler Tube NAG-1(722.6) Chrys/Jeep, 2002-Up.....	1.....	4810021AB
NI.....	68410GA.....	O-Ring, 722.6, Electrical Connector, Large, 1996-04 (Updated Design).....	1.....	TBA
NI.....	68410GB.....	O-Ring, 722.6, Electrical Connector, Small, 1996-04 (Updated Design).....	1.....	TBA
NI.....	68410HA.....	O-Ring, 722.6, Electrical Connector, Large, 2005-Up.....	1.....	TBA
NI.....	68410HB.....	O-Ring, 722.6, Electrical Connector, Small, 2005-Up.....	1.....	TBA
TECHNICAL MANUALS				
400.....	TMMBZ6.....	Tech Manual And Video, 722.6 1996-Up.....	1.....	TBA
ELECTRICAL COMPONENTS				
421.....	68956.....	Solenoid, 722.6 1-2/4-5 Shift (2 O-Rings) 1996-Up (5189057AA).....	1-3.....	240-270-0289
422.....	68956.....	Solenoid, 722.6 Shift, 2-3 (2 O-Rings) 1996-Up (5189057AA).....	1-3.....	240-270-0289
423.....	68956.....	Solenoid, 722.6 Shift, 3-4 (2 O-Rings) 1996-Up (5189057AA).....	1-3.....	240-270-0289
425.....	68957.....	Solenoid, 722.6 Lock-Up (PWM) (1 O-Ring) 1996-Up (52108314AA).....	1.....	240-277-0100
431.....	68954.....	Sol, 722.6 Modulating Press & Shift Press Regulating, (No O-Ring) 1996-Up (5138838AA).....	2.....	203-270-0089
444.....	68971.....	Connector, 722.6 Valve Body To Case (Plastic, 13 Pin Holes, 1 Bolt, 2 O-Rings, 1996-Up.....	1.....	68021352AA
446.....	68970.....	Conn Plate, Solenoid, Black (Round Dip Stick Hole) 1996-Up (68049181AA).....	1.....	140-270-1161
446.....	68970A.....	Conn Plate, Solenoid, Green / Gray (U-Shaped Dip Stick Hole) 2004-Up (52108308AC).....	1.....	140-270-1261
459.....	68625.....	Cover, 722.6 Solenoid (2 Solenoid Cover) 1996-Up.....	1.....	TBA
459B.....	68625A.....	Cover, 722.6 Solenoid (4 Solenoid Cover) 1996-Up.....	1.....	TBA
MISCELLANEOUS COMPONENTS				
475.....	68443G.....	Teflon Sleeve, 722.6 (Chrysler) Under #215 Bearing In K2 Drum 2004-Up.....	1.....	TBA
490.....	68621G.....	Vent, 722.6 (Mercedes) Bell Housing (Round Plastic) 1996-Up.....	1.....	TBA
490.....	68621J.....	Vent, 722.6 (Chrysler) Bell Housing (Plastic Elbow) 2004-Up.....	1.....	TBA
PUMPS & PUMP COMPONENTS				
510.....	68913G.....	Pump Body W/Gears, 722.6 (5.980" OD) (Cast Iron) 1996-Up.....	1.....	TBA
520.....	68916G.....	Stator, 722.6 (Mercedes) Uses 2ea 2-Sided Fric On Rear (Cast# 140 272 10 24) 1996-Up.....	1.....	TBA
520.....	68916GA.....	Stator, 722.6 (Mercedes) Uses 3ea 2-Sided Fric On Rear (Cast# 140 272 10 24) 1996-Up.....	1.....	TBA
520.....	68916GB.....	Stator, 722.6 (Mercedes) Uses 4ea 2-Sided Fric On Rear (Cast# 140 272 10 24) 1996-Up.....	1.....	TBA
520.....	68916J.....	Stator, 722.6 (Chrys) Uses 3ea 1-Sided Frictions On Rear Cast# 140 272 22 24) 2004-Up.....	1.....	TBA
530.....	K68201G.....	Pump Gear Set, 722.6 (.503" Thk) 19T Inner (23T Outer)(2 Drive Lugs For Conv) 1996-Up.....	1.....	TBA
544.....	68920G.....	Plate, 722.6 Pump (68 Holes Total) Some Early 96-97 *NLA* Must Re-Use Gasket*.....	1.....	NLA
544.....	68920J.....	Plate, 722.6 Pump (69 Holes Total) 1996-Up (OE#s 140-277-4214 & 52108147AA).....	1.....	140-277-4214
544.....	68920WP.....	Wear Plate, Pump Pocket, 722.6, Prevents Bell Housing Damage From Pump Failure (Exedy).....	1.....	DAM93830
DRUMS				
550.....	68932G.....	Drum W/Shaft, (Mercedes) K2 (W/ 90T Ring Gr) Has A Bushing Inside Rear, 1996-Up.....	1.....	TBA
550.....	68932GA.....	Drum W/Shaft, (Merced) K2 (W/ 90T Ring Gr) Needle Brg & Tefl Sleeve In Rear, 96-Up.....	1.....	TBA
550.....	68932GB.....	Drum W/Shaft, (Merced) K2 (W/ 78T Ring Gr) Has Bushing Inside Rear, 1996-Up.....	1.....	TBA
550.....	68932J.....	Drum W/Shaft, (Chrys) K2 (W/ 78T Ring Gr) Has Needle Brg & Tefl Sleeve In Rear, 04-Up.....	1.....	TBA
551.....	68732G.....	Drum, 722.6 (Mercedes) K3 Clutch (3-Clutch) 1996-Up.....	1.....	TBA
551.....	68732J.....	Drum, 722.6 (Chrysler) K3 Clutch (4-Clutch) 2004-Up.....	1.....	TBA
551.....	68732GA.....	Drum, 722.6 (Mercedes) K3 Clutch (5-Clutch) 1996-Up.....	1.....	TBA
552.....	68733G.....	Housing, 722.6 (Merced) B2 Cl (Cast # 202 272 04 31) Aluminum, 3.495" Thk, 1996-Up.....	1.....	TBA
552.....	68733GA.....	Housing, 722.6 (Merced) B2 Cl (Cast # 220 272 01 31) Aluminum, 1996-Up.....	1.....	TBA
552.....	68733J.....	Housing, 722.6 (Chrys) B2 Cl (Cast # 210 272 19 31) Aluminum, 3.180" Thk, 2004-Up.....	1.....	TBA
555.....	68922G.....	Drum, (Merced) K1 Cl (3-Cl) W/50T Sun Gr, Uses 2-Sided Fric, (#R140 272 00 24) 1996-.....	1.....	TBA
555.....	68922J.....	Drum, (Chrys) K1 Cl (5-Cl) W/58T Sun Gr, Uses 1-Sided Fric (#R140 272 11 24) 2004-.....	1.....	TBA
560.....	K68675G.....	Piston Kit, 722.6 (Mercedes) K2 Clutch (1.775" Thick Piston) 1996-Up.....	1.....	TBA
560.....	K68675J.....	Piston Kit, 722.6 (Chrysler) K2 Clutch (1.495" Thick Piston) 2004-Up.....	1.....	TBA
561.....	K68762G.....	Piston Kit, 722.6 K3 Clutch (Aluminum Piston # 140 272 19 31) 1996-Up.....	1.....	TBA
562.....	K68764G.....	Piston Kit, 722.6 B2 Clutch (Outer Piston # 140 272 20 31) 1996-Up.....	1.....	TBA
565.....	K68763G.....	Piston Kit, 722.6 K1 Clutch (Aluminum) 1996-Up.....	1.....	TBA
567.....	K68765G.....	Piston Kit, 722.6 (Mercedes) B1 Clutch (Bonded) (.700" Thick) 1996-Up.....	1.....	TBA
567.....	K65765J.....	Piston Kit, 722.6 (Chrysler) B1 Clutch (Bonded) (.877" Thick) 2004-Up.....	1.....	TBA
PLANETS, RING GEARS, SUN GEARS & SHELLS				
580.....	68749G.....	Planet W/Shaft, 722.6, Center (34T Sun Gr) (.905" Front Pilot) 1996-Up.....	1.....	TBA
580.....	68749J.....	Planet W/Shaft, 722.6, Center (30T Sun Gr) (.870" Front Pilot) 2004-Up.....	1.....	TBA

ILL#	Part#		QTY	REF#
580.....	68749GA.....	Planet W/Shaft, 722.6, Center (34T Sun Gr) (.870" Front Pilot) 1996-Up.....	1.....	TBA
580.....	68749JA.....	Planet W/Shaft, 722.6, Center (30T Sun Gr) (.905" Front Pilot) 2004-Up.....	1.....	TBA
582.....	68924G.....	Planet, 722.6 (Mercedes) Front (3 Gear Aluminum) (50 Teeth Sun Gear) 1996-Up.....	1.....	TBA
582.....	68924J.....	Planet, 722.6 (Chrysler) Front (4 Gear Aluminum) (58 Teeth Sun Gear) 2004-Up.....	1.....	TBA
583.....	K68924G.....	Planet Assy, 722.6 (Mercedes) Uses 34 Teeth Sun Gear #610 (.905" OD Pilot # 580)..... (#584 IS 4.02" Tall With 16T Gears)(#594 Is 5 1/2" ID)(Includes: # 594, 580, 250, 889, 590, 246, 247, 584, 610, 866, 654, 614, 056, 220, 221 & 888).....	1.....	TBA
583.....	K68924GA.....	Planet Assembly, 722.6 (Mercedes) 34 Teeth Sun Gear # 610 (.905" OD Pilot #580)..... (#584 Is 4.270" Tall With 19T Gears) (#594 Is 5 3/4" ID) (Includes: 594, 580, 250, 889, 590, 246, 247, 584, 248, 610, 866, 654, 614, 056, 220, 221 & 888).....	1.....	TBA
583.....	K68924GB.....	Planet Assembly, 722.6 (Mercedes) 34 Teeth Sun Gear # 610 (.629" OD Pilot # 580)..... (#584 Is 4.02" Tall With 16T Gears) (#594 Is 5 1/2" ID) (Includes: 594, 580, 250, 889, 590, 246, 247, 584, 248, 610, 866, 654, 614, 056, 220, 221 & 888).....	1.....	TBA
583.....	K68924GC.....	Planet Assembly, 722.6 (Mercedes) (34 Teeth Sun Gear #610)(.866" OD Pilot #580)..... (#584 Is 4.02" Tall With 16T Sun Gears)(#594 Is 5 1/2" ID) (Includes # 594, 580, 250, 889, 590, 246, 247, 584, 248, 610, 866, 654, 614, 056, 220, 221 & 888).....	1.....	TBA
583.....	K68924J.....	Planet Assy, 722.6 (Chrysler) (4x4) 30T Sun Gear #610 (.870" OD Pilot #580) (Includes: 594, 580, 250, 889, 590, 246, 247, 584, 248, 610, 866, 654, 614, 056, 220, 221, 888.....	1.....	TBA
584.....	68926G.....	Planet, 722.6 Rear (3 Gear) 54T On Sun Gear, 16T Pinion (Aluminum Housing).....	1.....	TBA
584.....	68926GA.....	Planet, 722.6 Rear (3 Gear) 65T On Sun Gear, 19T Pinion.....	1.....	TBA
584.....	68926J.....	Planet, 722.6 Rear (4 Gear) 30T On Sun Gear (Alum Hsg) 2 Notches For #247, 2004-Up.....	1.....	TBA
584.....	68926JA.....	Planet, 722.6 Rear (4 Gear) 60T On Sun Gear 24T Pinion.....	1.....	TBA
590.....	68759G.....	Ring Gear, 722.6 (Mercedes) Center Planet (69 Teeth) 18 Lugs (1.160" Wide) 1996-Up.....	1.....	TBA
590.....	68759J.....	Ring Gear, 722.6 (Chrysler) Center Planet (74 Teeth) 18 Lugs (1.240" Wide) 2004-Up.....	1.....	TBA
594.....	68758G.....	Ring Gear, 722.6 (Mercedes) Rear Planet (87 Teeth) 36 Outer Lugs (5 1/2" ID) 1996-Up.....	1.....	TBA
594.....	68758GA.....	Ring Gear, 722.6 (Mercedes) Rear Planet (90 Teeth) 36 Outer Lugs.....	1.....	TBA
594.....	68758GB.....	Ring Gear, 722.6 (Mercedes) Rear Planet (103 Teeth) 36 Outer Lugs 2002-Up.....	1.....	TBA
594.....	68758J.....	Ring Gear, 722.6 (Chrysler) Rear Planet (108 Teeth) 36 Outer Lugs 2004-Up.....	1.....	TBA
610.....	68756G.....	Sun Gear, 722.6 (Mercedes) Center Planet (34 Teeth) 1996-Up.....	1.....	TBA
610.....	68756J.....	Sun Gear, 722.6 (Chrysler) Center Planet (30 Teeth) 2004-Up.....	1.....	TBA
614.....	68927G.....	Sun Gear, (Mercedes) Rear Planet (54 Teeth) 1996-Up.....	1.....	TBA
614.....	68927GA.....	Sun Gear, (Mercedes) Rear Planet (50 Teeth) 1996-Up.....	1.....	TBA
614.....	68927GB.....	Sun Gear, (Mercedes) Rear Planet (30 Teeth) 1996-Up.....	1.....	TBA
614.....	68927J.....	Sun Gear, (Chrysler) Rear Planet (60 Teeth) 2004-Up.....	1.....	TBA
614.....	68927JA.....	Sun Gear, (Chrysler) Rear Planet (65 Teeth) 2004-Up.....	1.....	TBA
620.....	68748G.....	Shell, 722.6 (Mercedes) Driving (For 3 Gear Front Planet) 1996-Up.....	1.....	TBA
620.....	68748J.....	Shell, 722.6 (Chrysler) Driving (For 4 Gear Front Planet) 2004-Up.....	1.....	TBA
634.....	68933G.....	Support, B2 Cl Hsg (Cast # 140 272 06 32) Alum W/ Steel Sleeve, 6-11/16" OD, 1996-.....	1.....	TBA
SPRAGS & ONE WAY CLUTCHES				
654.....	68727G.....	Sprag, F2 (Rear) (14 Elements) *NLA Replaced By 20 Element 68727J*.....	1.....	TBA
654.....	68727J.....	Sprag, F2 (Rear) (20 Elements) 2004-Up (Retros For 1996-Up).....	1.....	TBA
658.....	68724G.....	Sprag , F1 (Front) (16 Elements) 1996-05 (Can Use 68724J).....	1.....	TBA
658.....	68724J.....	Sprag , F1 (Front) (20 Elements) .845" Thick "Narrow" 1996-05.....	1.....	TBA
658.....	68724K.....	Sprag , F1 (Front) (20 Elements) .925" Thick " Wide" 2006-Up.....	1.....	52108342AC
PARK GEARS				
690.....	68937G.....	Parking Gear, 722.6 (16 Lugs) (6.062" OD) 1996-Up.....	1.....	TBA
VALVE BODIES				
740.....	68754G.....	Valve Body, 722.6 (Mercedes) With 6 Solenoids (Cast # 140 277 36 01) 1996-Up.....	1.....	TBA
740.....	68754J.....	Valve Body, 722.6 (Chrysler) With 6 Solenoids (Cast # 52108216AA) 2004-Up.....	1.....	TBA
VALVE BODY COMPONENTS				
741.....	68942-01.....	Spring, 722.6 Solenoid Pressure Regulator (Sonnax).....	1.....	TBA
HOUSINGS, CASES & PANS				
750.....	68703G.....	Bell Hsg, (Merc) 4 5/8" Top Bolts (Square Top) Starter At 3:00 (#R210 271 09 01) 1996-.....	1.....	TBA
750.....	68703GA.....	Bell Hsg, (Merc) 5 3/4" Top Bolts (Round Top) Starter 3:00 & 9:00(#R140 271 27 01) 96-.....	1.....	TBA
750.....	68703GB.....	Bell Hsg, (Merc) 6" Top Bolts (Round Top) Starter 3:00 & 9:00 (#210 271 08 01) 1996-.....	1.....	TBA
750.....	68703J.....	Bell Housing, 722.6 (Chrysler) 8 3/4" Top Bolts (Round Top) 2004-Up..... (Starter At 3:00) Cast # 435AA-1, 29340287, 521084030).....	1.....	TBA
760.....	68941G.....	Case, 722.6 (Mercedes) 2WD (5/8" OD Filler Tube Hole) 1996-Up..... (Has A Sensor On Rear Of Case)(Cast # 140 27 28 01).....	1.....	TBA
760.....	68941GA.....	Case, 722.6 (Mercedes) 2WD (5/8" OD Filler Tube Hole) 1996-Up..... (Has A Sensor On Rear Of Case) (Cast # 901 271 00 01).....	1.....	TBA
760.....	68941J.....	Case, 722.6 (Chrysler) 4x4 (1 3/16" OD Filler Tube Hole) 2004-Up..... (Has 12 Rear Bolt Holes For Extension Housing Adapter).....	1.....	TBA

722.6

ILL#	Part#		QTY	REF#
760.....	68941JA.....	Case, (Chrysler) 2WD (1 3/16" OD Filler Tube Hole) 2004-Up (Cast # 103AA-03 Or -E	1	TBA
765.....	68934G.....	Pan, 722.6 (Mercedes) Bottom (With Drain Plug) 1996-Up	1	TBA
765.....	68934J.....	Pan, 722.6 (Chrysler) Bottom (No Drain Plug) 2004-Up	1	TBA
770.....	68939J.....	Extension Housing Adapter, 722.6 (Chrysler) 4x4 (Aluminum) (4 13/16" Long)	1	TBA
		2004-Up (Cast # 52108571AA) (12 Bolts To Case).....		
798.....	68081G.....	Nut, 722.6 Yoke To Output Shaft (12 Point) 1996-Up.....	1	TBA
841.....	68906G.....	Yoke, (Mercedes) 2WD Output Shaft (3 Bolt) 1.65" OD At Seal Surface, 1996-Up.....	1	TBA
841.....	68906GA.....	Yoke Sleeve, 722.6 (Chrysler) 4x4 Output Shaft To Transfer Case.....	1	TBA
		(1.650" OD Where Seal Rides & 2.665" OD On Other End) 2004-Up.....		

SNAP RINGS

861.....	68601G.....	Snap Ring, 722.6 Holds Pressure Plate In K2 Drum (.086") 1996-Up	1	TBA
861.....	68601GA.....	Snap Ring, 722.6 Holds Pressure Plate In K2 Drum (.100") 1996-Up	1	TBA
861.....	68601GB.....	Snap Ring, 722.6 Holds Pressure Plate In K2 Drum (.112") 1996-Up.....	1	TBA
861.....	68601GC.....	Snap Ring, 722.6 Holds Pressure Plate In K2 Drum (.124") 1996-Up	1	TBA
861.....	68601GD.....	Snap Ring, 722.6 Holds Pressure Plate In K2 Drum (.135") 1996-Up	1	TBA
862.....	68602G.....	Snap Ring, 722.6 Holds K2 Retainer In Drum 1996-Up.....	1	TBA
864.....	68603G.....	Snap Ring, 722.6 Holds Pressure Plate In K3 Drum (.074") 1996-Up	1	TBA
864.....	68603GA.....	Snap Ring, 722.6 Holds Pressure Plate In K3 Drum (.086") 1996-Up	1	TBA
864.....	68603GB.....	Snap Ring, 722.6 Holds Pressure Plate In K3 Drum (.098") 1996-Up	1	TBA
864.....	68603GC.....	Snap Ring, 722.6 Holds Pressure Plate In K3 Drum (.110") 1996-Up.....	1	TBA
864.....	68603GD.....	Snap Ring, 722.6 Holds Pressure Plate In K3 Drum (.122") 1996-Up	1	TBA
865.....	68604G.....	Snap Ring, 722.6 Holds K3 Clutch Piston Retainer In 1996-Up.....	1	TBA
866.....	68605G.....	Snap Ring, 722.6 Holds F2 Sprag In Rear Planet 1996-Up	1	TBA
873.....	68606G.....	Snap Ring, 722.6 Holds B2 Clutch Pressure Plate In Housing (.110") 1996-Up	1	TBA
873.....	68606GA.....	Snap Ring, 722.6 Holds B2 Clutch Pressure Plate In Housing (.122") 1996-Up.....	1	TBA
873.....	68606GB.....	Snap Ring, 722.6 Holds B2 Clutch Pressure Plate In Housing (.134") 1996-Up.....	1	TBA
873.....	68606GC.....	Snap Ring, 722.6 Holds B2 Clutch Pressure Plate In Housing (.146") 1996-Up.....	1	TBA
873.....	68606GD.....	Snap Ring, 722.6 Holds B2 Clutch Pressure Plate In Housing (.158") 1996-Up.....	1	TBA
874.....	68607G.....	Snap Ring, 722.6 Holds B2 Clutch Piston Retainer In 1996-Up.....	1	TBA
878.....	*68611G*	Snap Ring 722.6 Holds Pressure Plate In K1 Drum (Selective* Use 68611G-GD, ILL#885*).....	1	TBA
879.....	68608G.....	Snap Ring, 722.6 Holds K1 Clutch Retainer In Drum 1996-Up.....	1	TBA
881.....	68609G.....	Snap Ring, 722.6 Holds F1 Sprag To K1 Drum (2.395" OD) (Both Sides) 1996-Up	1	TBA
882.....	68610G.....	Snap Ring, 722.6 Holds Rear Planet Ring Gear To K2 Drum 1996-Up	1	TBA
885.....	68611G.....	Snap Ring, 722.6 Holds Pressure Plate On Stator (.098") 1996-Up	1-2	TBA
885.....	68611GA.....	Snap Ring, 722.6 Holds Pressure Plate On Stator (.110") 1996-Up	1-2	TBA
885.....	68611GB.....	Snap Ring, 722.6 Holds Pressure Plate On Stator (.122") 1996-Up	1-2	TBA
885.....	68611GC.....	Snap Ring, 722.6 Holds Pressure Plate On Stator (.134") 1996-Up	1-2	TBA
885.....	68611GD.....	Snap Ring, 722.6 Holds Pressure Plate On Stator (.146") 1996-Up	1-2	TBA
886.....	68612G.....	Retainer, 722.6 B1 Clutch Spring (Stepped) (5.385" OD) 1996-Up.....	1	TBA
888.....	68613G.....	Snap Ring, 722.6 Holds Rear Sun Gear To Center Sun Gear (W/2 Eyelets) 1996-Up	1	TBA
889.....	68614G.....	Snap Ring, 722.6 (Merced) Holds Center Planet Ring Gear To Rear Planet (.077, 5.22" OD)	1	TBA
889.....	68614J.....	Snap Ring, 722.6 (Chrys) Holds Center Planet Ring Gear To Rear Planet (.075", 5.437" OD).....	1	TBA
892.....	68615G.....	Snap Ring, 722.6 Holds B3 Clutch Pressure Plate In Case (.124") 1996-Up	1	TBA
892.....	68615GA.....	Snap Ring, 722.6 Holds B3 Clutch Pressure Plate In Case (.135") 1996-Up.....	1	TBA
892.....	68615GB.....	Snap Ring, 722.6 Holds B3 Clutch Pressure Plate In Case (.147") 1996-Up	1	TBA
892.....	68615GC.....	Snap Ring, 722.6 Holds B3 Clutch Pressure Plate In Case (.157") 1996-Up	1	TBA
892.....	68615GD.....	Snap Ring, 722.6 Holds B3 Clutch Pressure Plate In Case (.169") 1996-Up.....	1	TBA
892.....	68615GE.....	Snap Ring, 722.6 Holds B3 Clutch Pressure Plate In Case (.181") 1996-Up.....	1	TBA
894.....	68616G.....	Snap Ring, 722.6 Holds K3 Clutch Drum To Center Sun Gear (W/2 Eyelets) 1996-Up.....	1	TBA
895.....	68617G.....	Snap Ring, 722.6 Holds Ball Bearing In Case (.081" Thick) 1996-Up.....	1	TBA

PISTONS, SPRINGS, RETAINERS & MISCELLANEOUS

960.....	68675G.....	Piston, 722.6 (Mercedes) K2 Clutch (1.775" Thick) (Steel) 1996-Up	1	TBA
960.....	68675J.....	Piston, 722.6 (Chrysler) K2 Clutch (1.495" Thick) (Steel) 2004-Up.....	1	TBA
961.....	68762G.....	Piston, 722.6 K3 Clutch (Aluminum) (Cast # 140 272 19 31) 1996-Up	1	TBA
962.....	68764G.....	Piston, B2 Cl (Outer) (Cast # 140 272 20 31) 1.375" Thk, 3.15" ID, 5.90" OD, 1996-Up	1	TBA
962.....	68764GA.....	Piston, B2 Cl (Inner) (Cast # 140 272 07 32) 8.0" Thk, 2.40" ID, 4.70" OD W/ Chk Ball, 96-Up	1	TBA
965.....	68763G.....	Piston, 722.6 K1 Clutch (Aluminum) 2.205" Thick (Cast # 140 272 1431) 1996-Up	1	TBA
967.....	68765G.....	Piston, (Merc) B1 Cl (Bonded) .700" Thk (6 5/8" OD) 36 Legs, Uses 2-Sided Fri, 96-Up.....	1	TBA
967.....	68765J.....	Piston, (Chrys) B1 (Bonded) .877" Thk (6 5/8" OD) 36 Legs, Uses 1-Sided Fri, 04-Up.....	1	TBA
970.....	68870G.....	Spring, 722.6 K2 Clutch Piston Return (10 Fingers) 1996-Up.....	1	TBA
971.....	68871G.....	Spring, 722.6 K3 Clutch Piston Return (20 Fingers) 1996-Up.....	1	TBA
972.....	68872G.....	Spring, 722.6 B2 Clutch Piston Return (10 Fingers) 1996-Up.....	1	TBA
975.....	68875G.....	Spring, 722.6 K1 Clutch Piston Return (10 Fingers) 1996-Up.....	1	TBA
977.....	68877G.....	Spring, 722.6 B1 Clutch Return (36 Outer Fingers) (.053" Thick) 1996-Up.....	1	TBA
980.....	68860G.....	Retainer, 722.6 K2 Piston (Steel) (4.545" OD) 1996-Up	1	TBA
982.....	68862G.....	Retainer, 722.6 B2 Clutch Piston Spring (2 Tabs) 1996-Up	1	TBA

ILL#	Part#		QTY	REF#
985.....	68865G	Retainer, 722.6 K1 Clutch Return Spring (5.176" OD) 1996-Up.....	1	TBA
991.....	K68629G	Linkage Assembly, 722.6 (Mercedes) Internal (7 Pieces With Sensor) 1996-Up	1	TBA
991.....	K68629J	Linkage Assembly, 722.6 (Chrysler) (4 Pieces, No Sensor) 2004-Up	1	TBA
992.....	68638G	Shift Lever, 722.6 (Mercedes) External (Straight With Grommet) 1996-Up	1	TBA
992.....	68638J	Shift Lever, 722.6 (Chrysler) External (Off Set With Grommet) 2004-Up	1	TBA
995-2	68813G	Park Pawl Shaft, 722.6	1	TBA
995.....	K68937G	Park Pawl Assembly, 722.6 (5 Pieces) 1996-Up	1	TBA

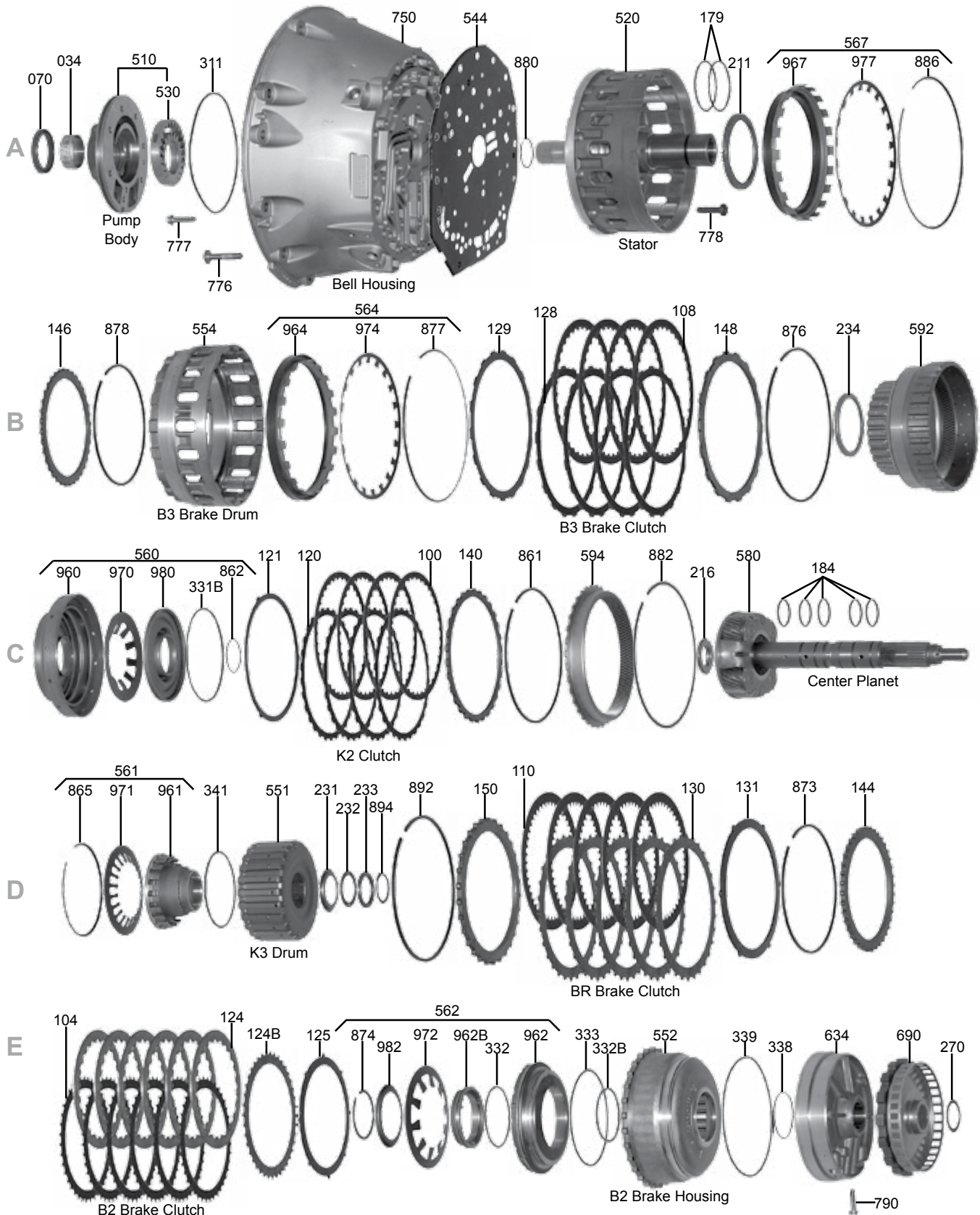

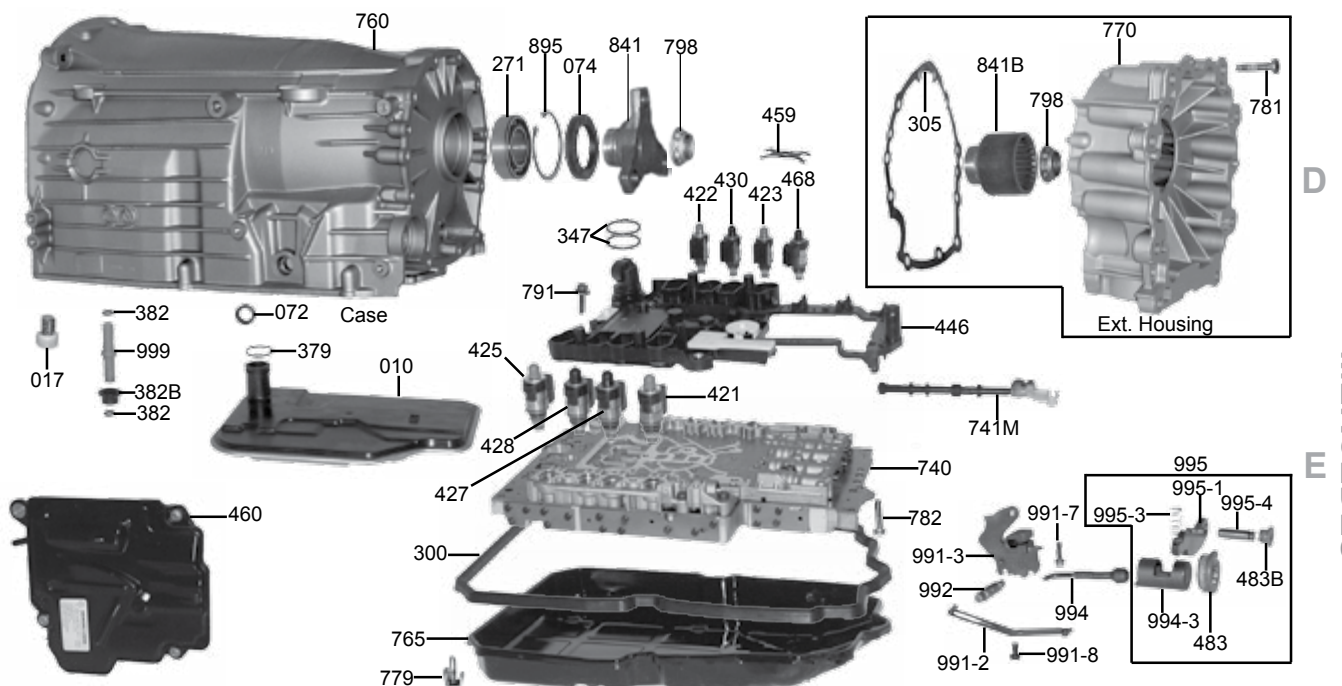
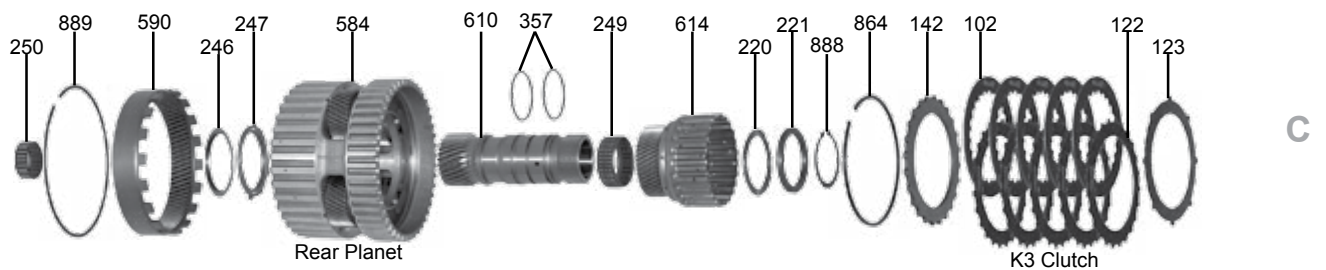
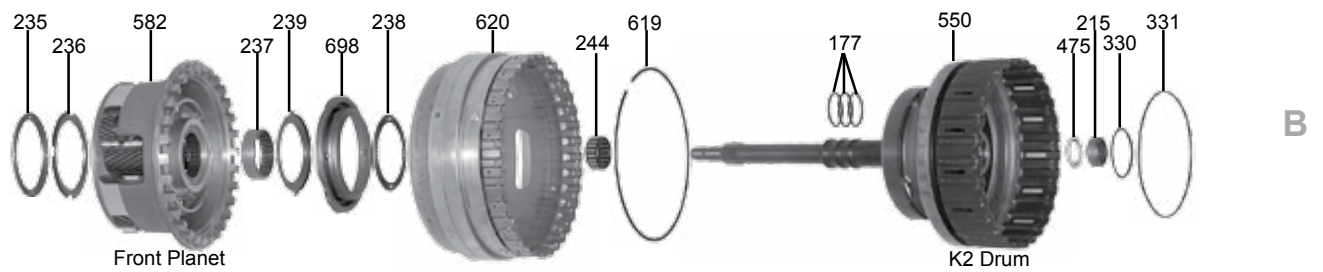
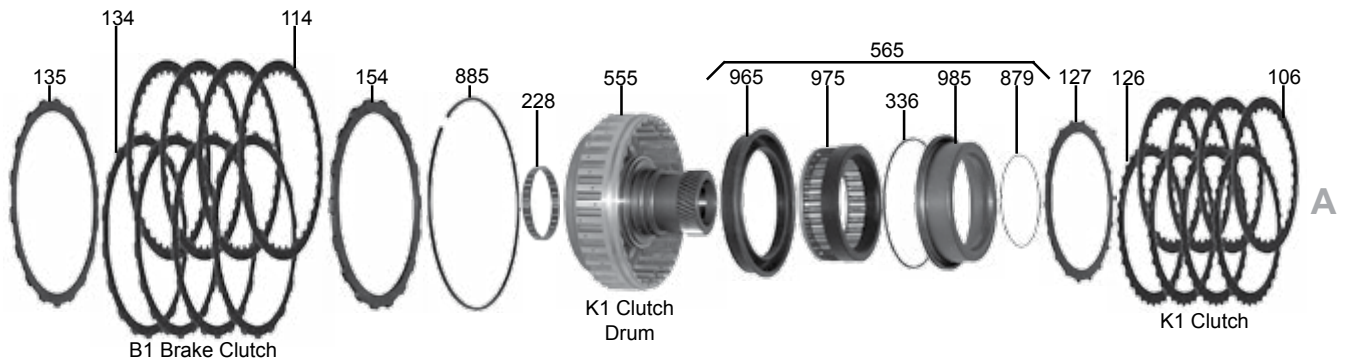

722.9

ILL#	Part#		QTY	REF#
OVERHAUL KITS & PISTON KITS				
NI.....	K136900.....	Overhaul Kit, W/Pistons, 722.9, 2004-Up.....	1.....	N/A
NI.....	K136900X.....	Overhaul Kit, W/Out Pistons, 722.9, 2004-Up.....	1.....	N/A
NI.....	K1369009-99.....	Bonded Piston Kit, 722.9, 2004-Up.....	1.....	N/A
MASTER L/STEEL KITS				
NI.....	DK13600S.....	Master L/Steels Kit, W/Pistons, 722.9, 2004-Up.....	1.....	N/A
NI.....	DK13600XS.....	Master L/Steels Kit, W/Out Pistons, 722.9, 2004-Up.....	1.....	N/A
MASTER W/STEELS KITS				
NI.....	DK13600.....	Master W/Steels Kit, W/Pistons, 722.9, 2004-Up.....	1.....	N/A
NI.....	DK13600X.....	Master W/Steels Kit, W/Out Pistons, 722.9, 2004-Up.....	1.....	N/A
FILTERS				
010.....	136710.....	Filter, 722.9, 2004-09.....	1.....	221-277-0195
010.....	136710A.....	Filter, 722.9, 2010-Up.....	1.....	221-227-0100
017.....	136712.....	Screen, 722.9 Under Valve Body In Case Near Filter Inlet (Plastic)(.995" Long) 2004-Up.....	1.....	TBA
BUSHINGS				
NI.....	K136901.....	Bushing Kit, 722.9, 2004-Up.....	1.....	TBA
034.....	68002.....	Bushing, 722.9 Pump Body (.535" Thick)(1.685" ID) 2004-Up.....	1.....	TBA
METAL CLAD SEALS				
070.....	68161.....	Seal, 722.9 Front (.275" Thick)(2.290" OD)(1.652" ID) 2004-Up.....	1.....	TBA
072.....	68173.....	Seal, 722.9 Shift Lever (.237" Thick)(.707" OD)(.415" ID) 2004-Up.....	1.....	TBA
074.....	68165G.....	Seal, 722.9 Rear (.322" Thick)(2.445" OD) 2004-Up.....	1.....	TBA
NI.....	136160.....	Seal, 722.9 Transfer Case, 2004-Up.....	1.....	TBA
FRICTIONS				
100.....	136101.....	Friction, 722.9 K2 Clutch, .083", 36T, 1-Sided Internal Spline 2004-Up.....	3-7.....	TBA
120.....	136103.....	Friction, 722.9 K2 Clutch, .083", 30T, 1-Sided External Spline 2004-Up.....	3-7.....	TBA
102.....	68132GA.....	Friction, 722.9 K3 Clutch, .082", 24T, 1-Sided Internal Spline 2004-Up.....	4-5.....	TBA
122.....	68132GB.....	Friction, 722.9 K3 Clutch, .083", 24T, 1-Sided External Spline 2004-Up.....	4-5.....	TBA
104.....	68102G.....	Friction, 722.9 B2 Clutch, .063", 40T, 2-Sided External Spline 2004-Up.....	5-6.....	TBA
106.....	136105.....	Friction, 722.9 K1 Clutch, .073", 30T, 1-Sided Internal Spline 2004-Up.....	4-5.....	TBA
126.....	136107.....	Friction, 722.9 K1 Clutch, .075", 36T, 1-Sided External Spline 2004-Up.....	4-5.....	TBA
108.....	136109.....	Friction, 722.9 B3 Clutch, .082", 36T, 1-Sided Internal Spline 2004-Up.....	3-5.....	TBA
128.....	136111.....	Friction, 722.9 B3 Clutch, .082", 18T, 1-Sided External Spline 2004-Up.....	3-5.....	TBA
110.....	68107G.....	Friction, 722.9 BR Clutch, .063", 46T, 2-Sided, Internal Spline 2004-Up.....	4-7.....	TBA
114.....	136109.....	Friction, 722.9 B1 Clutch, .082", 36T, 1-Sided Internal Spline 2004-Up.....	4-5.....	TBA
134.....	136111.....	Friction, 722.9 B1 Clutch, .082", 18T, 1-Sided External Spline 2004-Up.....	4-5.....	TBA
NI.....	K136F.....	Friction Module, 722.9 (Mercedes) 2004-Up.....	1.....	TBA
STEELS				
124.....	68122.....	Steel, 722.9 B2 Clutch, .070", 24T, Internal Spline 2004-Up.....	4-5.....	TBA
130.....	68123.....	Steel, 722.9 BR Clutch, .070", 30T, External Spline 2004-Up.....	3-6.....	TBA
121.....	136102.....	Steel, 722.9 K2 Clutch (Bottom)(.083")(3 Teeth)(6.010" ID)(Beveled) 2004-Up.....	1.....	TBA
123.....	136104.....	Steel, 722.9 K3 Clutch (Bottom)(.070")(8 Teeth)(3.455" ID)(Beveled) 2004-Up.....	1.....	TBA
124.....	68122G.....	Steel, 722.9 B2 Brake Clutch (.069")(40 External Teeth)(5.215" ID) 2004-Up.....	1.....	TBA
125.....	136106.....	Steel, 722.9 B2 Brake Clutch (.095")(8 Teeth)(5.220" ID)(Beveled) 2004-Up.....	1.....	TBA
127.....	136108.....	Steel, 722.9 K1 Clutch (.080")(18 Teeth)(5.020" ID)(Beveled) 2004-Up.....	1.....	TBA
129.....	136110.....	Steel 722.9 B3 Brake Clutch (.075")(18 Teeth)(6 11/16" ID)(Beveled) 2004-Up.....	1.....	TBA
131.....	136112.....	Steel, 722.9 BR Brake Clutch (.133")(6 Teeth)(6.140" ID)(Beveled) 2004-Up.....	1.....	TBA
135.....	136110.....	Steel 722.9 B1 Brake Clutch (.075")(18 Teeth)(6 11/16" ID)(Beveled) 2004-Up.....	1.....	TBA
NI.....	K136S.....	Steel Module, 722.9 (Mercedes) 2004-Up.....	1.....	TBA
PRESSURE PLATES				
140.....	136131.....	Pressure Plate, 722.9 K2 Clutch (.155")(30 Teeth)(6.005" ID) 2004-Up.....	1.....	TBA
142.....	136132.....	Pressure Plate, 722.9 K3 Clutch (.156")(24 Teeth)(3.465" ID) 2004-Up.....	1.....	TBA
144.....	136133.....	Pressure Plate, 722.9 B2 Brake Clutch (.255")(40 Teeth)(5.220" ID) 2004-Up.....	1.....	TBA
146.....	136134.....	Pressure Plate, 722.9 K1 Clutch (.155")(36 Teeth)(5.020" ID) 2004-Up.....	1.....	TBA
148.....	136135.....	Pressure Plate, 722.9 B3 Brake Clutch (.155")(18 Teeth)(6 11/16" ID) 2004-Up.....	1.....	TBA
150.....	136136.....	Pressure Plate, 722.9 BR Brake Clutch (.255")(30 Teeth)(6.100" ID) 2004-Up.....	1.....	TBA
154.....	136135.....	Pressure Plate, 722.9 B1 Brake Clutch (.155")(18 Teeth)(6 11/16" ID) 2004-Up.....	1.....	TBA
SEALING RINGS				
NI.....	K136903.....	Ring Kit, 722.9, 2004-Up.....	1.....	TBA
177.....	68307G.....	Ring, 722.9 Input Shaft (.092" Thick)(1.205" OD)(Teflon) 2004-Up.....	3.....	TBA

ILL#	Part#		QTY	REF#
179.....	136301	Ring, 722.9 Stator To K1 Drum (.088" Thick)(2.560" OD)(Teflon) 2004-Up	2	TBA
184.....	68310G	Ring, 722.9 Output Shaft (.090" Thick)(1.375" OD)(W/8 Tabs On The ID)(Teflon) 2004-Up	5	TBA
WASHERS & BEARINGS				
NI	K136907	Washer Kit, 722.9, 2004-Up	1	TBA
NI	K136906	Bearing Kit, 722.9, 2004-Up	1	TBA
211.....	136415	Brg W/Races, 722.9 Stator To K1 Drum, .175" Thk, 3.926" OD, 3.174" ID, Stepped, 2-Ears	1	TBA
215.....	68423G	Caged Needle Bearing, 722.9 K2 Drum (Rear)(HK2210) 2004-Up	1	TBA
215.....	68410-02K	Caged Needle Bearing & PTFE Teflon Seal, 722.9 K2 Drum (Rear) 2004-Up	1	Sonnax
216.....	136416	Bearing W/Races, 722.9 K2 Drum To Center Planet (.160" Thick)(1.780" OD)(1.030" ID)	1	TBA
220.....	136417	Bearing W/Race, 722.9 Rear Sun Gear To K3 Drum (.110" Thick)(2.460" OD)(1.907" ID)	1	TBA
221.....	136436	Race, 722.9 Rear Sun Gear To K3 Drum (.175" Thick)(2.405" OD)(1.905" ID) 2004-Up	1	TBA
228.....	136418	Caged Needle Brg, 722.9 Inside K1 Drum (Front)(.308" Wide)(2.830" OD)(Plastic Cage)	1	TBA
231.....	136437	Race, 722.9 K3 Drum To Rear Support (.040" Thick)(2.197" OD)(1.407" ID)(Stepped)	1	TBA
232.....	136419	Bearing, 722.9 K3 Clutch Drum To Rear Support (.078" Thick)(1.842" OD)(1.385" ID) 2004-Up	1	TBA
233.....	136438	Race, 722.9 K3 Clutch Drum To Rear Support (.131" Thick)(1.823" OD)(1.390" ID) 2004-Up	1	TBA
234.....	136420	Brg W/Races, 722.9 K1 Drum To Front Planet Ring Gear (.145" Thk)(3.280" OD)(2.685" ID)	1	TBA
235.....	136421	Bearing W/Race, 722.9 Sun Gear To Front Planet (.108" Thick)(3.130" OD)(2.535" ID) 2004-Up	1	TBA
236.....	136439	Race, Sun Gear To Front Planet (.076" Thk)(3.265" OD)(2.485" ID)(Stepped)(4 Outer Notches)	1	TBA
237.....	136422	Caged Needle Bearing, 722.9 Front Planet (1.865" OD)(1.655" ID) 2004-Up	1	TBA
238.....	136423	Bearing, 722.9 Front Planet To K2 Drum (.078" Thick)(2.858" OD)(2.190" ID) 2004-Up	1	TBA
239.....	136440	Race, 722.9 Front Planet (Rear) (.102" Thick)(2.928" OD)(2.155" ID)(Stepped)(W/2 Ears)	1	TBA
244.....	136424	Caged Needle Brg, 722.9 Input Shaft To Stator Shaft (Plastic Cage)(.500" Thk)(1.265" OD)	1	TBA
246.....	136441	Race, 722.9 Center Planet To Rear Planet (.030" Thick)(2.550" OD)(2.048" ID) 2004-Up	1	TBA
247.....	136425	Brg W/Race, 722.9 Center Planet To Rear Planet (.110" Thk)(.670" OD)(2.055" ID)(W/2 Ears)	1	TBA
249.....	136426	Caged Needle Brg, 722.9 Inside Rear Sun Gear (.695" Thick)(1.880" OD)(Plastic Cage)	1	TBA
250.....	136427	Caged Needle Brg, 722.9 Rear Planet OP Shaft To Sun Gear (.500" Thk)(1.340" OD)	1	TBA
270.....	136442	Shim, 722.9 Parking Gear To Output Bearing (.020" Thick)(1.650" OD)(1.270" ID) 2004-Up	1	TBA
271.....	136428	Brg, 722.9 Output Shaft To Case (.628" Thk)(2.440" OD)(1.260" ID)(Cast # INA 6206 E AH01)	1	TBA
GASKETS & RUBBER COMPONENTS				
300.....	136500	Gasket, 722.9 (Mercedes) Pan (Molded) 2004-Up	1	TBA
305.....	136515	Gasket, 722.9 4X4 Extension Housing To Case (11 Bolt)(Metal) 2004-Up	1	TBA
311.....	68506G	O-Ring, 722.9 Pump Body To Bell Housing (.135" Thick)(6.005" OD) 2004-Up	1	TBA
379.....	136212	Boot, 722.9 Filter Seal 2004-Up	1	TBA
ELECTRICAL COMPONENTS				
410.....	136991	Switch, 722.9 MLPS, 2004-Up	1	TBA
421.....	136932	Solenoid, 722.9 B2 Green/Blue Top, Cast # 0 260 130 034 2004-Up (Also K1, B3 & TCC Sol)	14	TBA
422.....	136932	Solenoid, 722.9 K1 Green/Blue Top, Cast # 0 260 130 034 2004-Up	1	TBA
423.....	136932	Solenoid, 722.9 B3 Green/Blue Top, Cast # 0 260 130 034 2004-Up	1	TBA
425.....	136932	Solenoid, 722.9 TCC/Lock-Up Green/Blue Top, Cast # 0 260 130 034 2004-Up	1	TBA
427.....	136933	Solenoid, 722.9 K2, Black Top, Cast # 0 260 130 035, 2004-Up (Also EPC, B1 & K3 Sol)	14	TBA
428.....	136933	Solenoid, 722.9 EPC, Black Top, Cast # 0 260 130 035, 2004-Up	1	TBA
430.....	136933	Solenoid, 722.9 B1, Black Top, Cast # 0 260 130 035, 2004-Up	1	TBA
446.....	136970	Circuit Board, 722.9, 5 Pin Round Conn, Plastic, Cast # VDO A 033 545 73 32, 2004-Up	1	TBA
459.....	136629	Bracket, 722.9 Holds 2 Solenoids On Valve Body 2004-Up	4	TBA
460.....	136950	Shift Motor, 722.9, 4 Bolts to Case, 5 Blade Conn, Cast #5218, 2004-Up	1	TBA
468.....	136933	Solenoid, 722.9 K3, Black Top, Cast # 0 260 130 035, 2004-Up	1	TBA
MISCELLANEOUS COMPONENTS				
475.....	68443G	Teflon Sleeve, 722.9 Under # 215 Bearing In K2 Drum 2004-Up	1	TBA
483.....	136628	Plug, 722.9 Park Actuator Sleeve (1.675" OD) 2004-Up	1	TBA
483B	136628A	Plug, 722.9 Park Pawl Pin (.930" OD) 2004-Up	1	TBA
PUMPS & PUMP COMPONENTS				
500.....	136912	Pump Assembly, 722.9, 2004-Up	1	TBA
510.....	136916	Pump Body W/Gears, (23T Outer, 19T Inner, .535" Thick Gears, 7 Bolt, Cast # 220277)	1	TBA
520.....	136915	Stator Shaft W/Housing, 722.9, (Cast # 200300040 & R220 272 42 24) 2004-Up	1	TBA
530.....	K136201	Pump Gears, 722.9, (23T Outer, 19T Inner) 2004-Up	1	TBA
544.....	136917	Plate, 722.9, Pump, Bell To Case (Tin, .040" Thick) 2004-Up	1	TBA
544.....	68920WP	Wear Plate, Pump Pocket, 722.9, Prevents Bell Housing Damage From Pump Failure (Exedy)	1	DAM93830
DRUMS				
550.....	136732	Drum W/Shaft, 722.9 K2 Clutch (86T Front Planet Ring Gear, 15-3/4" Tall, 3 Ring Input Shaft)	1	TBA
551.....	136733	Drum, 722.9 K3 Clutch (5 Clutch, Stamped Steel, 2.345" Tall, 5.055" OD) 2004-Up	1	TBA
552.....	136734	Housing, B2 Brake Clutch (Alum, 3.025" Tall, 2.555" ID, Cast #R 220 272 25 31)	1	TBA
554.....	136735	Retainer, B3 Brake (Alum, 4 Cl, 3.035" Thk, Cast # 21100-01-01 & A220 2702 02 24 3 35 2)	1	TBA

722.9

ILL#	Part#		QTY	REF#
555.....	136736	Drum, 722.9 K1 Clutch (Alum, 4 Cl, 42T Sun Gear, Cast #DGS 1700211-3.1 226) 2004-Up.....	1	TBA
560.....	K136762	Piston Kit, 722.9 K2 Clutch (Contains: # 960, 970, 980, & 862) 2004-Up.....	1	TBA
561.....	K136763	Piston Kit, 722.9 K3 Clutch (Contains: # 865, 971, 961) 2004-Up.....	1	TBA
562.....	K136764	Piston Kit, 722.9 B2 Brake Clutch (Contains: # 962, 962B, 972A, 982, 874) 2004-Up.....	1	TBA
564.....	K136765	Piston Kit, 722.9 B3 Brake Clutch (Bonded Piston)(Contains:# 964, 974, 877) 2004-Up.....	1	TBA
565.....	K136766	Piston Kit, 722.9 K1 Clutch (Bonded Piston)(Contains:# 965, 975, 985, & 879) 2004-Up.....	1	TBA
567.....	K136767	Piston Kit, 722.9 B1 Brake Clutch (Bonded Piston)(Contains: # 967, 977, & 886) 2004-Up.....	1	TBA

PLANETS, RING GEARS, SUN GEARS & SUPPORTS

580.....	136749	Planet, 722.9 Center W/Output Shaft (28T Sun Gear, 13-1/2" Long, 4 Ring Shaft) 2004-Up.....	1	TBA
582.....	136747	Planet, 722.9 Front (Alum Hsg, 4 Long & 4 Short Gears, 30 Outer Lugs, Uses 42T Sun Gear).....	1	TBA
584.....	136748	Planet, 722.9 Rear (4-Gear, Alum Hsg, Uses 46T Sun Gear, Cast # R220 272 0705).....	1	TBA
584.....	K136748	Geartrain, 722.9 (Includes All From 555A To 551D) 2004-Up.....	1	TBA
590.....	136759	Ring Gear, 722.9 Center Planet (76T, 1.280" Thk, 5.430" OD, 18 Rear Lugs) 2004-Up.....	1	TBA
592.....	136757	Ring Gear, 722.9 Front Planet (110T Gear, 30T & 36T Clutch Hub, 6-9/16" OD) 2004-Up.....	1	TBA
594.....	136758	Ring Gear, 722.9 Rear Planet (114T, 36 Outer Lugs, .840" Thk, 7-3/8" OD) 2004-Up.....	1	TBA
610.....	136756	Sun Gear, 722.9 Center Planet (28T, 5.575" Long, 2.000" OD, W/2 O-Rings) 2004-Up.....	1	TBA
614.....	136755	Sun Gear, 722.9 Rear Planet (46T, 2.895" Thk, 2.615" OD, 1.915" ID, 24T Clutch Hub) 2004-Up.....	1	TBA
619.....	136639	Spacer Ring, 722.9 Front Planet To K2 Drum (.076" Thk, 6-3/8" OD, Looks Like Snap Ring).....	1	TBA
620.....	136849	Drive Shell, (4.030" Tall, 30 Square Holes For Front Planet, 36 Lugs For Rear Planet Ring Gear).....	1	TBA
634.....	136737	Support, 722.9 B2 Brake Cl Hsg Aluminum (Cast # A220 270 02 68, Steel Sleeve Inside).....	1	TBA
690.....	136823	Parking Gear, 722.9 (16 Lugs)(With 36 Slot Reluctor) 2004-Up.....	1	TBA
698.....	136641	Retainer, 722.9 Crimped Onto The Front Planet (Rear)(Tin)(.720" Thick)(4.345" OD)(2.860" ID).....	1	TBA

VALVE BODIES

740.....	136754	Valve Body, 722.9 (8-Sol, 10 Bolts To Case, Cast # R220 277 14 01, & R220 277 08 01).....	1	TBA
----------	--------	---	---	-----

CASES, CASE COMPONENTS, PANS & HOUSINGS

741M....	136940	Manual Valve, 722.9 Valve Body (7-1/8" Long, Plastic End) 2004-Up.....	1	TBA
750.....	136703	Bell Housing, 722.9 (6" Top Bolts, Cast # R211 271 08 01 @ 2.2) 2004-Up.....	1	TBA
760.....	136701	Case, 722.9 (Cast # R164 271 13 01) 2004-Up.....	1	TBA
765.....	136801	Pan, 722.9 Bottom 2004-Up.....	1	TBA
770.....	136702	Extension Housing, 722.9 4X4 (11 Bolts To Case, 8-Bolts To Transfer Case) 2004-Up.....	1	TBA
779.....	136086	Bolt, 722.9 (Mercedes) Pan (Aluminum-Recommended To Be Replaced, 6 Per Trans).....	6	TBA
798.....	136081	Nut, 722.9 Yoke (12 Point) (.475" Thick)(1.550" OD) 2004-Up.....	1	TBA
841.....	136706	Yoke, 722.9 Output Shaft (2.390" Long)(2 Sets Of Splines) 2004-Up.....	1	TBA

SNAP RINGS

NI.....	K136908	Snap Ring Kit, 722.9, 2004-Up.....	1	TBA
861.....	136601	Snap Ring, 722.9 Holds K2 Pressure Plate In Drum (.123" Thick)(6 15/16" OD) 2004-Up.....	1	TBA
862.....	133602	Snap Ring, 722.9 Holds K2 Clutch Spring Retainer In (.078" Thick)(1.722" OD)(Wire Type).....	1	TBA
864.....	136603	Snap Ring, 722.9 Holds K3 Clutch Pressure Plate In Drum (.112" Thick)(4.885" OD) 2004-Up.....	1	TBA
865.....	136604	Snap Ring, 722.9 Holds K3 Clutch Return Spring In (.050" Thick)(4.780" OD) 2004-Up.....	1	TBA
873.....	136605	Snap Ring, 722.9 Holds B2 Brake Clutch Pressure Plate In Drum (.135" Thick)(6 5/8" OD).....	1	TBA
874.....	136606	Snap Ring, 722.9 Holds B2 Brake Clutch Spring Retainer In (.076" Thick)(2.555" OD) 2004-Up.....	1	TBA
876.....	136607	Snap Ring, 722.9 Holds B3 Brake Clutch Pressure Plate In (.124" Thick)(7 7/8" OD).....	1-2	TBA
877.....	136608	Snap Ring, 722.9 Holds B3 Brake Cl Return Spring In (.055" Thick)(7 13/16" OD)(Stepped).....	1-2	TBA
878.....	136609	Snap Ring, 722.9 Holds K1 Clutch Pressure Plate In Drum (.124" Thick)(6 3/16" OD) 2004-Up.....	1	TBA
879.....	136610	Snap Ring, 722.9 Holds K1 Clutch Retainer In (.080" Thick)(3.450" OD) 2004-Up.....	1	TBA
880.....	136611	Snap Ring, 722.9 Holds Stator Shaft To B1 Brake Clutch Housing (.056" Thick)(1.537" OD).....	1	TBA
882.....	136612	Snap Ring, 722.9 Holds Rear Planet Ring Gear In Shell (.075" Thick)(7 7/16" OD) 2004-Up.....	1	TBA
885.....	136607	Snap Ring, 722.9 Holds B1 Brake Clutch Pressure Plate In (.124" Thick)(7 7/8" OD) 2004-Up.....	1-2	TBA
886.....	136608	Snap Ring, 722.9 Holds B1 Brake Cl Return Spring In (.055" Thick)(7 13/16" OD)(Stepped).....	1-2	TBA
888.....	136613	Snap Ring, 722.9 Holds Rear Sun Gear To Output Shaft (.058" Thick)(2.058" OD)(W/2 Eyelets).....	1	TBA
889.....	136614	Snap Ring, 722.9 Holds Center Planet Ring Gear To Rear Planet (.074" Thick)(5.650" OD).....	1	TBA
892.....	136615	Snap Ring, 722.9 Holds BR Brake Clutch Pressure Plate In (.145" Thick)(7 1/2" OD) 2004-Up.....	1	TBA
894.....	136616	Snap Ring, 722.9 Holds K3 Clutch Drum To Output Shaft (.058" Thick)(1.495" OD)(W/2 Eyelets).....	1	TBA
895.....	136617	Snap Ring, 722.9 Holds Output Shaft Bearing In Case (.081" Thick)(2.595" OD)(W/2 Eyelets).....	1	TBA

PISTONS, SPRINGS, RETAINERS & MISCELLANEOUS

960.....	136762	Piston, 722.9 K2 Clutch (1.655" Thick)(6 1/4" OD)(1.890" ID)(Steel) 2004-Up.....	1	TBA
961.....	136763	Piston, 722.9 K3 Clutch (1.990" Thick)(3.852" OD)(1.855" ID) 2004-Up.....	1	TBA
962.....	136764	Piston, 722.9 B2 Cl (1.125" Thk, 5.70" OD, 3.14" ID, Cast # A22027226313 DRM 200000026 04).....	1	TBA
962B....	136764A	Piston, Inner, 722.9 B2 Brake Clutch (Alum, .565" Thick, 3.120" OD, 2.400" ID) 2004-Up.....	1	TBA
964.....	136765	Piston, 722.9 B3 Brake Clutch, Bonded (7 1/2" OD)(6 9/16" ID)(20 Lugs) 2004-Up.....	1	TBA
965.....	136766	Piston, 722.9 K1 Clutch, Bonded, (.729" Thick)(5.520" OD)(4.000" ID) 2004-Up.....	1	TBA
967.....	136767	Piston, 722.9 B1 Brake Cl, Bonded (1.065" Thick)(6 15/16" OD)(5.720" ID)(20 Lugs) 2004-Up.....	1	TBA
970.....	136872	Spring, 722.9 K2 Clutch Return (.072" Thick)(4.550" OD)(10 Fingers) 2004-Up.....	1	TBA

ILL#	Part#		QTY	REF#
971.....	136873	Spring, 722.9 K3 Clutch Return (.063" Thick)(4.570" OD)(20 Fingers) 2004-Up.....	1	TBA
972.....	136874	Spring, 722.9 B2 Brake Clutch Return (.068" Thick)(5.270" OD)(10 Fingers) 2004-Up	1	TBA
974.....	136875	Spring, 722.9 B3 Brake Clutch Return (.053" Thick)(7 9/16" OD)(20 Fingers)	1-2	TBA
975.....	136876	Spring, 722.9 K1 Clutch Piston Return (30 Springs W/Plastic Housing) 2004-Up	1	TBA
977.....	136875	Spring, 722.9 B1 Brake Clutch Return (.053" Thick)(7 9/16" OD)(20 Fingers) 2004-Up	1-2	TBA
980.....	136862	Retainer, 722.9 K2 Clutch Spring (.525" Thick)(4.765" OD)(1.705" ID) 2004-Up	1	TBA
982.....	136864	Retainer, 722.9 B2 Brake Clutch Spring (.066" Thick)(3.237" OD)(2.411" ID)(Stepped) 2004-Up	1	TBA
985.....	136866	Retainer, 722.9 K1 Clutch Piston (1.233" Thick)(5.022" OD)(3.430" ID) 2004-Up.....	1	TBA
991-2	136809	Spring, 722.9 Rooster Comb Detent (4.965" Long) 2004-Up	1	TBA
991-3	136812	Rooster Comb, 722.9 Slotted With Threaded Hole To Tighten To Manual Lever 2004-Up	1	TBA
991-7	136087	Bolt, 722.9 Holds Rooster Comb To Manual Lever 2004-Up.....	1	TBA
992.....	136631	Manual Lever, 722.9 External W/Shaft (W/2 Flats) 2004-Up.....	1	TBA
994-3	136638	Sleeve, 722.9 Park Actuator (1.180" OD)(2.218" Long) 2004-Up.....	1	TBA
994.....	136632A.....	Actuator, 722.9 Park Rod (3 9/16" Long)(.660" OD Ball) 2004-Up	1	TBA
995-1	136632	Parking Pawl, 722.9 (4 5/8" Long)(.475" ID Pin Hole) 2004-Up	1	TBA
995-3	136632B.....	Spring, 722.9 Park Pawl (Coil) (.465" OD)(1.425" Long) 2004-Up	1	TBA
995-4	136632C.....	Pin, 722.9 Parking Pawl (.471" OD)(1.670" Long) 2004-Up	1	TBA
995.....	K136632.....	Park Pawl Assembly, 722.9 (Contains # 995-1, 995-3, 995-4, 483B, 994-3, 483A) 2004-Up	1	TBA
999.....	136637	Oil Tube, 722.9 Valve Body To Stator Shaft Housing (Plastic)(2.085" Long)(.410" OD)(.225" ID).....	1	TBA

722.0, 722.1, 722.2

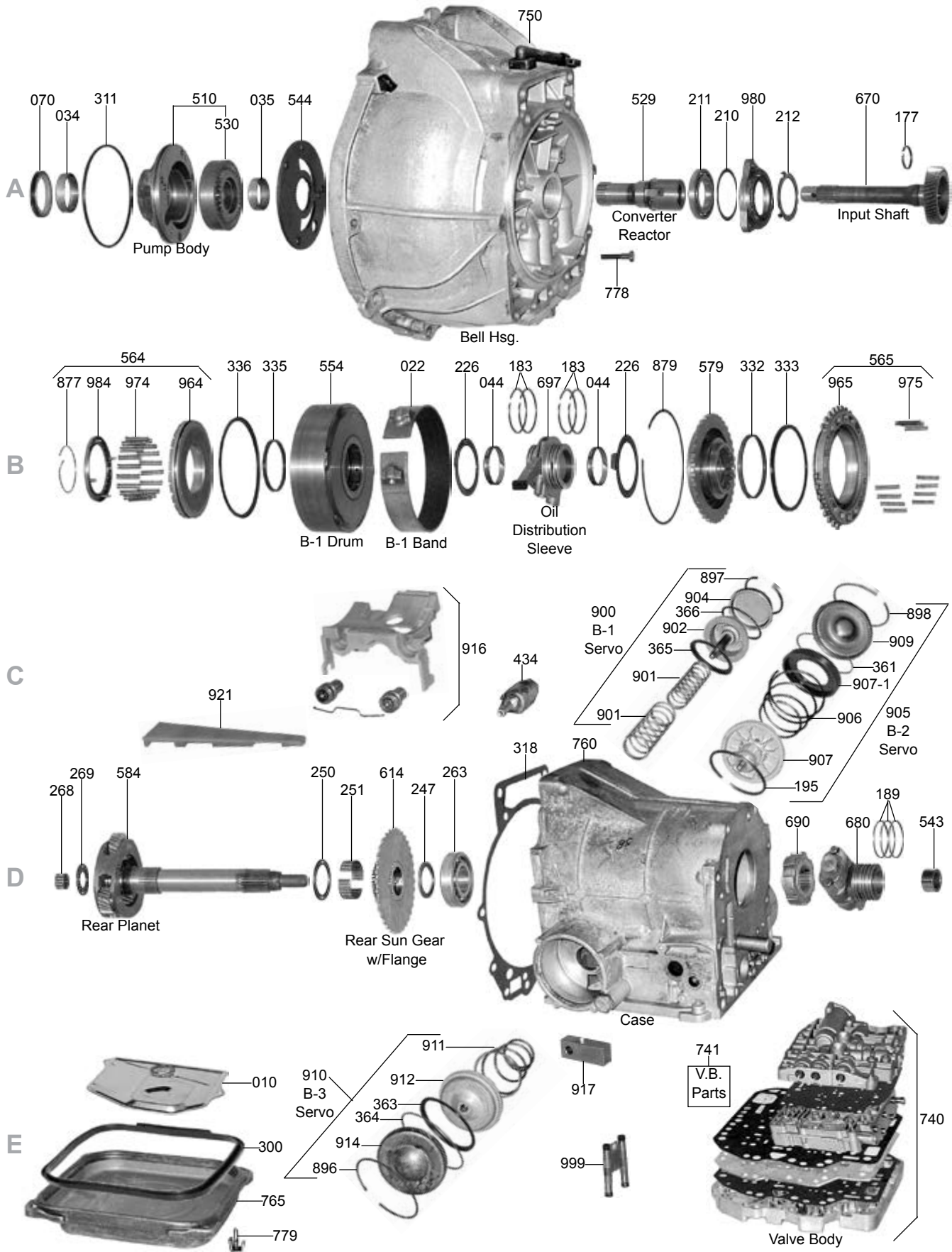

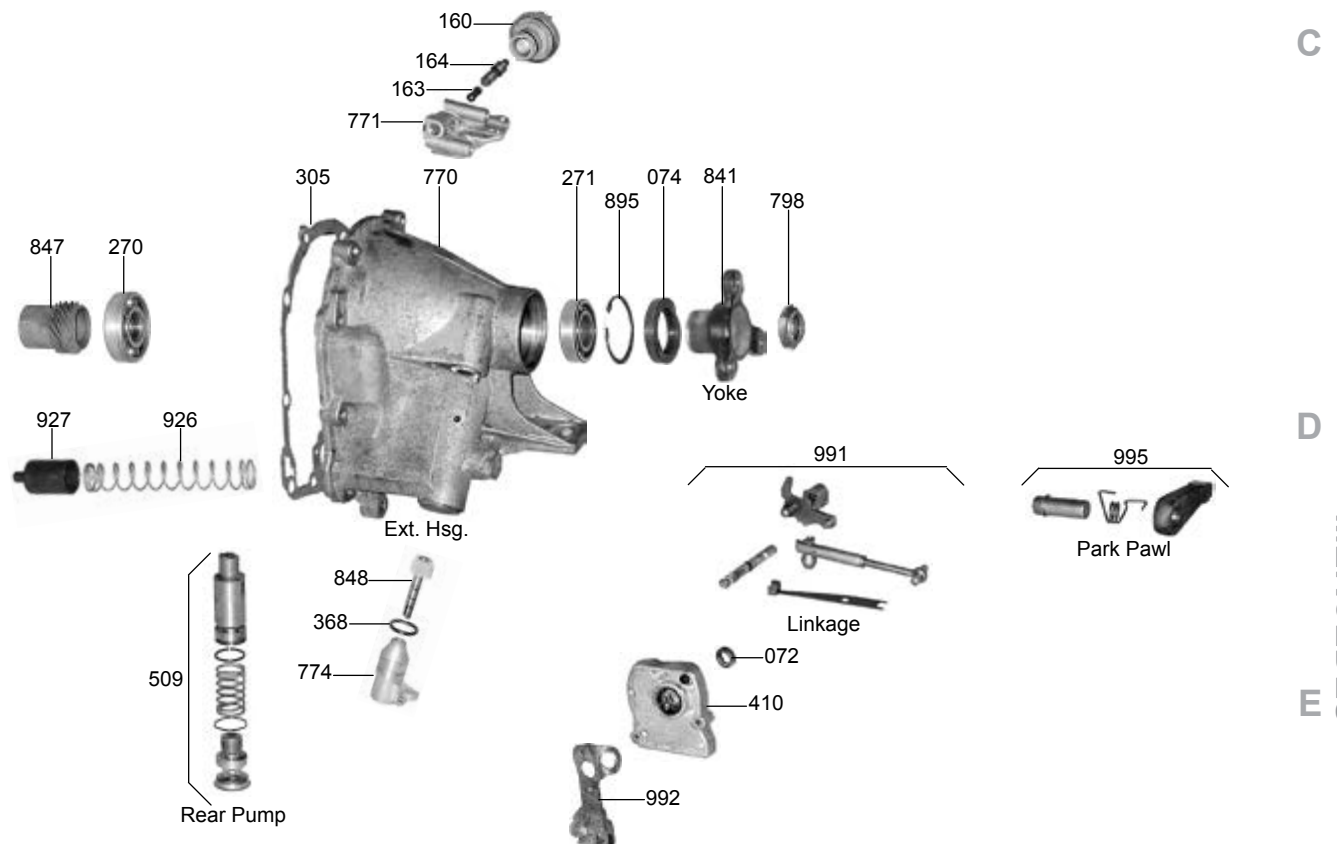
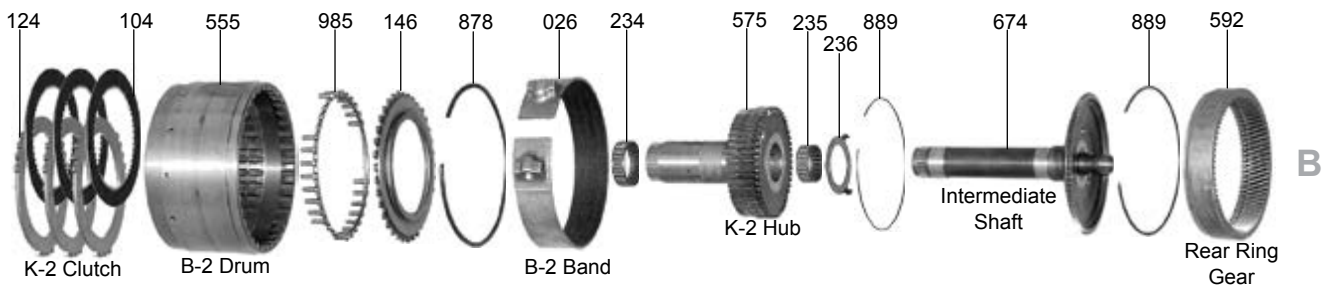
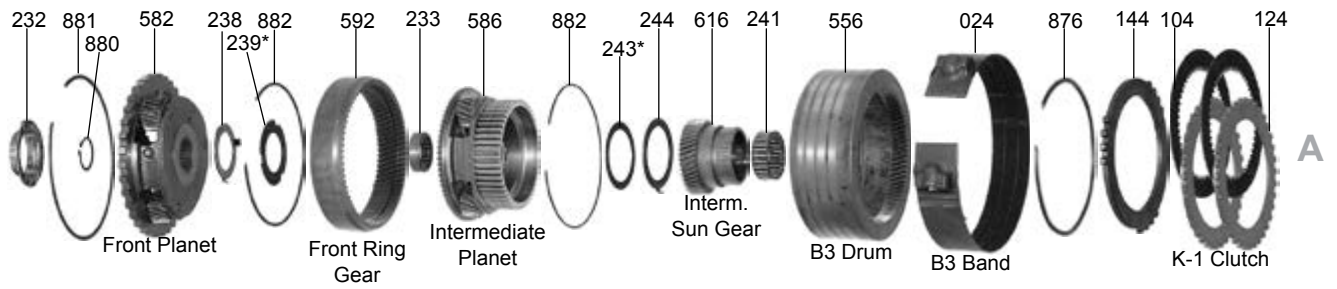

722.0, 722.1, 722.2

ILL#	Part#		QTY	REF#
OVERHAUL KITS				
NI.....	K68900.....	Overhaul Kit, 722.0 / 722.1 / 722.1 1970-83.....	1.....	N/A
MASTER L/STEEL KITS				
NI.....	DK6800S.....	Master L/Steels Kit, 722.0 / 722.1 / 722. 2 1970-83.....	1.....	N/A
MASTER W/STEELS KITS				
NI.....	DK6800.....	Master W/Steels Kit, 722.0 / 722.1 / 722.2 1970-83.....	1.....	N/A
FILTERS				
010.....	68710A.....	Filter, 722.0 / 722.1 / 722.2 Without Tube 1970-77.....	1.....	115-270-0398
010.....	68710B.....	Filter, 722.0 / 722.1 / 722.2 With 1" Long Tube 1972-83.....	1.....	109-270-0298
010.....	68710C.....	Filter, 722.0 / 722.1 / 722.2 With 3/4" Long Tube 1977-83.....	1.....	123-270-0098
BANDS				
022.....	68341.....	Band, 722.0 / 1 / 2 Center 1 1/2" Wide (Round Holes In Lugs For Struts) Paper.....	1.....	TBA
		Lining (With 1 Groove) Has A Thin Strapping (.110" Thick With Lining) 1970-83.....		
022.....	68342.....	Band, 722.0 / 1 / 2 Center 2" Wide (Round Holes In Lugs For Struts) Paper Lining.....	1.....	TBA
		(With 1 Groove) Has A Thin Strapping (.110" Thick With Lining) 1970-83.....		
022.....	68340.....	Band, 722.0 / 1 / 2 Center 1 1/2" Wide (Oval Holes In Lugs For Struts) Paper Lining.....	1.....	TBA
		(With 1 Groove) Has A Thin Strapping (.110" Thick With Lining) 1970-83.....		
024.....	68321.....	Band, 722.0 / 1 / 2 Front 1 1/2" Wide (Round Holes In Lugs For Struts) Composition.....	1.....	TBA
		Lining (Has Thick Strapping (.170" Thick With Lining) 1970-83.....		
024.....	68320.....	Band, 722.0 / 1 / 2 Front 1 1/2" Wide (Oval Holes In Lugs For Struts) Composition.....	1.....	TBA
		Lining (Has Thick Strapping (.170" Thick With Lining) 1970-83.....		
026.....	68344.....	Band, 722.0 / 1 / 2 Center & Rear 1 1/2" Wide (Round Holes In Lugs For Struts).....	1-2.....	TBA
		Composition Lining Has A Thin Strapping (.130" Thick With Lining) 1970-83.....		
026.....	68346.....	Band, 722.0 / 722.1 / 722.2 Center & Rear (2" Wide) Round Holes In Lugs For Struts.....	1-2.....	TBA
		(Composition Lining) Has A Thin Strapping (.130" Thick With Lining) 1970-83.....		
026.....	68343.....	Band, 722.0 / 722.1 / 722.2 Center & Rear 1 1/2" Wide (Oval Holes In Lugs For Struts).....	1-2.....	TBA
		Composition Lining Has A Thin Strapping (.130" Thick With Lining) 1970-83.....		
026.....	68346A.....	Band, 722.0 / 722.1 / 722.2 Rear 2" Wide (Split Band) Round Holes In Lugs For Struts.....	1.....	TBA
		(Composition Lining).....		
026.....	68347.....	Band, 722.0 / 722.1 / 722.2 Center & Rear (1 1/2" Wide) Round Holes In Lugs For Struts.....	1-2.....	TBA
		(Composition Lining) Has A Thin Strapping (.130" Thick With Lining) 1970-83.....		
BUSHINGS				
034.....	68004.....	Bushing, 722.1 Pump Body (1 1/16" OD Converter Hub).....	1.....	TBA
034.....	68005.....	Bushing, 722.0 / 722.2 Pump Body (1 5/8" OD Converter Hub).....	1.....	112-272-4350
035.....	68007.....	Bushing, 722.0 / 722.2 Inner Pump Gear.....	1.....	TBA
044.....	68014.....	Bushing, 722.0 / 722.1 / 722.2 Oil Feed Sleeve.....	2.....	TBA
METAL CLAD SEALS				
070.....	68151.....	Seal, 722.2 Front (1 1/16" OD Converter Hub) 1970-83.....	1.....	008-997-2546
070.....	68152.....	Seal, 722.0 / 722.1 Front (1 5/8" OD Converter Hub) 1970-83.....	1.....	004-997-0547
072.....	68153.....	Seal, 722.0 / 722.1 / 722.2, Linkage Shaft 1970-83.....	1.....	TBA
074.....	68155.....	Seal, 722.0 / 722.1 / 722.2 Extension Housing.....	1.....	005-997-1146
FRICTIONS				
104.....	68103.....	Friction, 722.0 / 722.1 / 722.2 K1 & K2 Clutch (.083") 51 Teeth.....	8.....	TBA
104.....	68103A.....	Friction, 722.0 / 722.1 / 722.2 K1 & K2 Clutch (.098") 51 Teeth.....	8.....	TBA
119.....	K68F.....	Friction Module, 722.0 / 722.1 / 722.2 (.083") 51 Teeth.....	1.....	TBA
STEELS				
124.....	68100.....	Steel, 722.0 / 722.1 / 722.2 K1 & K2 Clutch (2.0mm) (.079") 12 Teeth.....	AR.....	109-272-1526
124.....	68101.....	Steel, 722.0 / 722.1 / 722.2 K1 & K2 Clutch (2.0mm) (.118") 12 Teeth.....	AR.....	109-272-0626
124.....	68102.....	Steel, 722.0 / 722.1 / 722.2 K1 & K2 Clutch (2.0mm) (.138") 12 Teeth.....	AR.....	109-272-1426
139.....	K68S.....	Steel Module, 722.0 / 722.1 / 722.2 (.079") 12 Teeth.....	1.....	TBA
PRESSURE PLATES				
144.....	68136AA.....	Pressure Plate, 722.0 / 722.1 / 722.2 K1 Clutch.....	1.....	TBA
146.....	68137AA.....	Backing Plate, 722.0 / 722.1 / 722.2 K2 Clutch.....	1.....	TBA
MODULATORS				
160.....	68820C.....	Modulator, Steel/Plastic (Snap Ring Type) 1977-81.....	1.....	TBA
160.....	68820G.....	Modulator, 722.0 / 722.1 / 722.2 Steel (With Green Dot).....	1.....	TBA
160.....	68820D.....	Modulator, 722.0 / 722.1 / 722.2 Steel (With Red Top).....	1.....	TBA
163.....	68622.....	Valve, 722.0 / 722.1 / 722.2 Under Modulator.....	1.....	TBA

722.0, 722.1, 722.2

ILL#	Part#		QTY	REF#
164.....	68623.....	Pin, 722.0 / 722.1 / 722.2 Modulator	1.....	TBA
SEALING RINGS				
175.....	K68903.....	Ring Kit, 722.0 / 722.1 / 722.2	1.....	TBA
WASHERS & BEARINGS				
210.....	68913A.....	Shim, 722.0 / 722.1 / 722.2 Input Shaft (Front)	1.....	TBA
211.....	68913.....	Ball Bearing, 722.0 / 722.1 / 722.2 Input Shaft (Front)	1.....	TBA
212.....	68914.....	Washer, 722.1 / 722.2 Input Shaft (Front)	1.....	115-272-4562
226.....	68920.....	Washer, 722.0 / 722.1 / 722. 2 Oil Feed Sleeve (Takes 2)	2.....	115-270-1373
229.....	68411.....	Needle Bearing, 722.0 B-2 Hub To Hollow Shaft	1.....	TBA
232.....	68915.....	Washer, 722.1 / 722.2 Input Shaft To Planet (Beveled Top Hat)	1.....	115-272-4962
232.....	68915AA.....	Bearing, 722.0 Input Shaft To Planet (Flat)	1.....	TBA
232.....	68915A.....	Bearing, 722.0 Input Shaft To Planet (450)	1.....	TBA
234.....	68920A.....	Bearing, 722.0 Hollow Shaft Front (450)	1.....	TBA
235.....	68922.....	Needle Bearing, 722.0 / 722.1 / 722.2 Intermediate Shaft (Front)	1.....	TBA
236.....	68921.....	Washer, 722.0 / 722.1 / 722.2 K-2 Hub To Intermediate Shaft	1.....	TBA
238.....	68916A.....	Washer, 722.0 Front Planet (Rear) (450)	1.....	TBA
238.....	68916.....	Washer, 722.1 / 722.2 Front Planet (Rear)	1.....	TBA
239.....	68977.....	Shim, 722.1 / 722.2 Front Planet (Rear)	1.....	TBA
241.....	68419.....	Needle Bearing, 722.1 / 722.2 Sun Gear Inner (3 Pieces)	1.....	TBA
241.....	68419A.....	Needle Bearing, 722.0 Sun Gear Inner (1 Piece)	1.....	TBA
242.....	68412.....	Spacer, 722.0 Snap Ring To B1 Drum	1.....	TBA
243.....	68418A.....	Shim, 722.1 / 722.2 2nd Planet To Sun Gear	1.....	TBA
244.....	68418B.....	Washer, 722.1 / 722.2 2nd Planet To Sun Gear	1.....	TBA
247.....	68925B.....	Washer, 722.0 / 722.1 / 722.2 Rear Sun Gear To Ball Bearing	1.....	TBA
250.....	68925C.....	Bearing, 722.0 / 722.1 / 722.2 Rear Planet (Rear)	1.....	007-981-3900
251.....	68926.....	Needle Bearing, 722.0 / 722.1 / 722.2 Rear Planet (Rear) 2 Pieces	1.....	TBA
263.....	68414.....	Ball Bearing, 722.0 / 722.1 / 722.2 Output Shaft (Front)	1.....	TBA
268.....	68924.....	Needle Bearing, 722.0 Rear Planet (Inner) (Front) 3/4" Long	1.....	TBA
268.....	68924A.....	Needle Bearing, 722.0 Rear Planet (Inner) (Front) 1/2" Long	1.....	TBA
269.....	68923.....	Bearing, 722.2 Intermediate Shaft (.890" ID)	1.....	TBA
269.....	68923A.....	Bearing, 722.0 / 722.1 Intermediate Shaft (.675" ID)	1.....	TBA
270.....	68415.....	Washer, 722.0 / 722.1 / 722.2 Speed-O Gear To Ball Bearing	1.....	TBA
271.....	68416.....	Ball Bearing, 722.0 / 722.1 / 722.2 Output Shaft (Rear)	1.....	TBA
GASKETS & RUBBER COMPONENTS				
300.....	68500.....	Gasket, 722.0 / 722.1 / 722. 2 Bottom Pan (Rubber)	1.....	115-271-1680
TECHNICAL MANUALS				
400.....	TMMBZ1.....	Technical Manual, 722.0 / 722.1 / 722.2	1.....	83-7222TM
ELECTRICAL COMPONENTS				
410.....	68991A.....	Neutral Switch, 722.0 / 722.1 / 722.2	1.....	TBA
440.....	68765.....	Switch, 722.0 / 722.1 / 722.2 Kickdown	1.....	TBA
PUMPS & PUMP COMPONENTS				
509.....	68707A.....	Rear Pump Assembly, 722.0 / 722.1 / 722.2 (2 1/8" Steel Collar)	1.....	TBA
509.....	68707.....	Rear Pump Assembly, 722.0 / 722.1 / 722.2 (2 7/8" Steel Collar)	1.....	TBA
510.....	68912.....	Pump Body, 722.1 (115-277-0420) Without Plate	1.....	116-270-0090
510.....	68912A.....	Pump Body, 722.0 / 722.2 (Cast # 1020) Without Plate	1.....	TBA
510.....	68912AA.....	Pump Body, 722.2 (010-277-0420) Without Plate	1.....	TBA
529.....	68918.....	Shaft, 722.0 / 722.2 Stator (4 1/16" Long) 1.457" OD Surface Where Presses In Bell	1.....	TBA
529.....	68917.....	Shaft, 722.0 / 722.2 Stator (4 1/16" Long) 1.573" OD Surface Where Presses In Bell	1.....	TBA
529.....	68919.....	Shaft, 722.0 / 722.2 Stator (4 9/16" Long)	1.....	TBA
543.....	68706.....	Eccentric Wheel, 722.0 / 722.2 (Drives The Rear Pump)	1.....	TBA
544.....	68811.....	Plate, 722.0 / 722.2 Pump (1 1/2" Center Hole With Splines)	1.....	TBA
544.....	68811A.....	Plate, 722.1 Pump (1 1/4" Center Hole) No Splines	1.....	TBA
DRUMS & CLUTCH HUBS				
554.....	68716.....	Drum, 722.0 Band With K-1 Clutch	1.....	TBA
554.....	68716A.....	Drum, 722.1 / 722. 2 Band With K-1 Clutch	1.....	TBA
555.....	68733A.....	Drum, 722.0 Rear (Except 450)	1.....	TBA
555.....	68733.....	Drum, 722.0 Rear (450 Only)	1.....	TBA
555.....	68733AA.....	Drum, 722.1 / 722.2 Rear (3 1/2" Wide)	1.....	TBA
556.....	68730.....	Drum, 722.1 / 722.2 Second Ring Gear & Band Drum	1.....	TBA
556.....	68730A.....	Drum, 722.0 Band	1.....	TBA
564.....	K68762.....	Piston Kit, 722.0 / 722.1 / 722.2 K-1 Clutch	1.....	TBA
565.....	K68764.....	Piston Kit, 722.0 / 722.1 / 722. 2 K-2 Clutch (B-2 Drum)	1.....	TBA

722.0, 722.1, 722.2

ILL#	Part#		QTY	REF#
575.....	68746AA.....	Clutch Hub W/Shaft, 722.0 Hollow With Race (450).....	1.....	TBA
575.....	68746A.....	Clutch Hub W/Shaft, 722.1 / 722.2 Hollow W/Cam & Hub (1 1/8" Hub).....	1.....	TBA
575.....	68746B.....	Clutch Hub W/Shaft, 722.1 / 722.2 Hollow W/Cam & Hub (1 3/16" Hub).....	1.....	TBA
575.....	68746.....	Clutch Hub W/Shaft, 722.1 / 722.2 Hollow W/Cam & Hub (1 5/16" Hub).....	1.....	TBA
579.....	68729.....	Hub, 722.0 / 722.1 / 722.2 B-2 Drum.....	1.....	TBA
PLANETS, RING GEARS & SUN GEARS				
582.....	68747.....	Planet, 722.0 Front.....	1.....	TBA
582.....	68747A.....	Planet, 722.1 / 722.2 Front (1 9/16" OD Hub Inside).....	1.....	TBA
582.....	68747B.....	Planet, 722.1 / 722.2 Front (1 3/4" OD Hub Inside).....	1.....	TBA
584.....	68737.....	Planet, 722.0 With Output Shaft (Uses 3/4" Long Bearing # 268).....	1.....	TBA
584.....	68737A.....	Planet, 722.1 / 2 W/ Output Shaft (1/2" Long Brg # 268 That Is Flush W/ Top Of Hole).....	1.....	TBA
584.....	68737B.....	Planet, 722.1 / 2 W/ Output Shaft (1/2" Bearing # 268 That Is 1/8" Below Surface).....	1.....	TBA
586.....	68748.....	Planet, 722.1 / 722.2 Second (.160" Thick Hub).....	1.....	TBA
586.....	68748A.....	Planet, 722.1 / 722.2 Second (.133" Thick Hub).....	1.....	TBA
592.....	68713.....	Ring Gear, 722.0 / 722.1 / 722.2 Front & Rear Planet (1.140" Thick).....	2.....	TBA
592.....	68713A.....	Ring Gear, 722.0 / 722.1 / 722.2 Front & Rear Planet (1.220" Thick).....	2.....	TBA
612.....	68735.....	Sun Gear, 722.0 Front (450).....	1.....	TBA
614.....	68743.....	Sun Gear, 722.0 / 722.1 / 722.2 Rear.....	1.....	TBA
616.....	68731.....	Sun Gear, 722.1 / 722.2 Intermediate.....	1.....	TBA
SPRAGS & ONE WAY CLUTCHES				
642.....	68724.....	Sprag, 722.0 Freewheel Assembly.....	1.....	TBA
SHAFTS				
670.....	68734A.....	Input Shaft, 722.2 With Sun Gear (7 1/2" Long).....	1.....	TBA
670.....	68734.....	Input Shaft, 722.1 With Sun Gear (6 1/2" Long).....	1.....	TBA
670.....	68735.....	Input Shaft, 722.0 With Flange (7 3/16" Long) (450).....	1.....	TBA
674.....	68744A.....	Shaft, 722.0 Intermediate With Hub (Except 450).....	1.....	TBA
674.....	68744B.....	Shaft, 722.0 Intermediate With 1 1/8" Hub (450).....	1.....	TBA
674.....	68744.....	Shaft, 722.0 Intermediate With 1 1/4" Hub (470).....	1.....	TBA
674.....	68744C.....	Shaft, 722.1 / 722.2 Intermediate With Hub.....	1.....	TBA
680.....	68410.....	Governor Assembly, 722.0 / 722.1 / 722.2.....	1.....	TBA
690.....	68824.....	Park Gear, 722.0 / 722.1 / 722.2.....	1.....	TBA
697.....	68717.....	Oil Distributor Sleeve, 722.0 / 722.1 / 722.2.....	1.....	TBA
VALVE BODIES				
740.....	68754.....	Valve Body, 722.0 / 722.1 / 722.2 (100 270 3607 Ink #).....	1.....	TBA
740.....	68754A.....	Valve Body, 722.0 / 722.1 / 722.2 (114 270 5207 Ink #).....	1.....	TBA
740.....	68754B.....	Valve Body, 722.0 / 722.1 / 722.2 (115 270 6107 Ink #).....	1.....	TBA
740.....	68754C.....	Valve Body, 722.0 / 722.1 / 722.2 (116 270 2207 Ink #).....	1.....	TBA
740.....	68754D.....	Valve Body, 722.0 / 722.1 / 722.2 (123 270 0007 Ink #).....	1.....	TBA
HOUSINGS, CASES & PANS				
750.....	68812A.....	Bell Housing, 722.0 (Cast # 103) (450 Model).....	1.....	TBA
750.....	68812.....	Bell Housing, 722.0 (Cast # 103) (Except 450 Model).....	1.....	TBA
750.....	68812B.....	Bell Housing, 722.1 / 722.2 (Cast #115).....	1.....	TBA
750.....	68812C.....	Bell Housing, 722.1 / 722.2 (Cast #130).....	1.....	TBA
760.....	68701.....	Case, 722.0 / 722.1 / 722.2 (Specify Cast #) 1970-75.....	1.....	TBA
760.....	68701A.....	Case, 722.0 / 722.1 / 722.2 (Specify Cast #) 1976-80.....	1.....	TBA
765.....	68801.....	Pan, 722.0 / 722.1 / 722.2.....	1.....	TBA
770.....	68702.....	Extension Housing, 722.0 / 722.1 / 722.2.....	1.....	TBA
774.....	K68227.....	Housing, 722.0 / 722.1 / 722.2 Driven Speed-O Gear.....	1.....	TBA
798.....	68081.....	Nut, 722.0 / 722.1 / 722.2 Holds Yoke To Output Shaft.....	1.....	TBA
841.....	68622.....	Yoke, 722.0 / 722.1 / 722.2.....	1.....	TBA
847.....	68227.....	Gear, 722.0 / 722.1 / 722.2 Drive.....	1.....	TBA
848.....	68228.....	Gear, 722.0 / 722.1 / 722.2 Driven.....	1.....	TBA
SERVOS, PISTONS & MISCELLANEOUS				
900.....	K68997.....	Servo Assembly, 722.0 / 722.1 / 722.2 B-1 Band.....	1.....	TBA
901.....	68623.....	Spring, 722.0 / 722.1 / 722.2 B1 Servo.....	1.....	TBA
902.....	68997.....	Piston, 722.0 / 722.1 / 722.2 B1 Servo.....	2.....	TBA
904.....	68624.....	Cover, 722.0 / 722.1 / 722.2 B1 Servo.....	1.....	TBA
905.....	K68997A.....	Servo Assembly, 722.0 / 722.1 / 722.2 B-2 Band.....	1.....	TBA
906.....	68623A.....	Spring, 722.0 / 722.1 / 722.2 B-2 Servo.....	1.....	TBA
907.....	68997A.....	Piston, 722.0 / 722.1 / 722.2 B-2 Servo.....	1.....	TBA
909.....	68624A.....	Cover, 722.0 / 722.1 / 722.2 B-2 Servo.....	1.....	TBA
910.....	K68997B.....	Servo Assembly, 722.0 / 722.1 / 722.2 B-3 Band.....	1.....	TBA

722.0, 722.1, 722.2

ILL#	Part#		QTY	REF#
911.....	68623B.....	Spring, 722.0 / 722.1 / 722.2 B-3 Servo	1.....	TBA
912.....	68997B.....	Piston, 722.0 / 722.1 / 722.2 B-3 Servo.....	1.....	TBA
914.....	68624B.....	Cover, 722.0 / 722.1 / 722.2 B-3 Servo	1.....	TBA
916.....	K68626.....	Strut Assembly, 722.0 / 722.1 / 722.2 Band	1.....	TBA
917.....	68627.....	Apply Pin, 722.0 / 722.1 / 722.2 Servo	1.....	TBA
920.....	68082.....	Bolt, 722.0 / 722.1 / 722.2 Band Adjusting	1.....	TBA
921.....	68740.....	Band Guide, 722.0 / 722.1 / 722.2 Plastic (Cast #)	1.....	TBA
926.....	68628.....	Spring, 722.0 / 722.1 / 722.2 Accumulator	1.....	TBA
927.....	68998.....	Piston, 722.0 / 722.1 / 722.2 Accumulator.....	1.....	TBA
964.....	68762.....	Piston, 722.0 / 722.1 / 722.2 K-1 Clutch.....	1.....	TBA
965.....	68764.....	Piston, 722.0 / 722.1 / 722.2 K-2 Clutch (B-2 Drum)	1.....	TBA
974.....	68872.....	Spring, 722.0 / 722.1 / 722.2 K-1 Clutch Return.....	1.....	TBA
975.....	68874.....	Spring, 722.0 / 722.1 / 722.2 K-2 Clutch Return.....	1.....	TBA
980.....	68641.....	Retainer, 722.1 / 722.2 Bearing Input.....	1.....	TBA
984.....	68862.....	Retainer, 722.0 / 722.1 / 722.2 K-1 Clutch Spring	1.....	TBA
985.....	68864.....	Retainer, 722.0 / 722.1 / 722.2 K-2 Clutch Return Spring	1.....	TBA
991.....	K68629.....	Linkage Assembly, 722.0 / 722.1 / 722.2 Internal	1.....	TBA
995.....	K68873.....	Park Pawl Assembly, 722.0 / 722.1 / 722.2	1.....	TBA
999.....	68631.....	Oil Tubes, 722.0 / 722.1 / 722.2	1.....	TBA